

Welcome and Call to Order by Mayor O. Stanhope Anthony III

~ Invocation ~

~ Pledge of Allegiance ~

A. Approval of agenda:

Discussion and revision of the proposed agenda, including consent agenda; adoption of an agenda

- 1) Motion to adopt the agenda as proposed or amended

B. Special Presentation:

- 1) Recognition of Justin S. Merritt, Finance Director, and the City of Shelby's Finance Department as recipients of the Certificate of Achievement for Excellence in Financial Reporting awarded by the Government Finance Officers Association (GFOA) for the Fiscal Year ended June 30, 2017

1

C. Public Hearing:

- 1) Proposed Fiscal Year (FY) 2018-2019 Annual Operating Budget for the City of Shelby
- a. Consideration of Fiscal Year (FY) 2018-2019 Budget Ordinance: Ordinance No. 31-2018
- b. Consideration of Fiscal Year (FY) 2018-2019 Supplemental Budget Ordinance: Ordinance No. 32-2018

4

6

15

D. Consent Agenda:

Prior to approval and adoption of the agenda, a Council Member may move an item from the Consent Agenda to the regular agenda. Items remaining on the Consent Agenda will be considered collectively through a single motion and vote.

- 1) Approval of the Minutes of the Regular Meeting of May 14, 2018

83

2) Approval of Special Event Permit Applications:	97
a. 7 th Inning Stretch Festival, 5K, and Little Miss American Legion World Series, requested date: August 11, 2018	99
b. Host City Welcome, requested date: August 15, 2018	106
3) Approval of a resolution authorizing the upset bid process: Resolution No. 25-2018	111
4) Approval of a reimbursement resolution with regard to installment financings for Fiscal Year 2018-2019: Resolution No. 26-2018	115
5) Approval of a resolution awarding the bid for the fabrication of the meter set for Clearwater 2S facility: Resolution No. 27-2018	119
6) Adoption of an ordinance authorizing demolition of a dwelling: Ordinance No. 33-2018	124
E. Unfinished Business:	
1) Consideration of a resolution of tentative award for the Runway Overlay Project at Shelby-Cleveland County Regional Airport to Harrison Construction Company, Division of APAC-Atlantic, Inc.: Resolution No. 28-2018	131
F. New Business: None	145
G. City Manager's Report	145
Council Announcements and Remarks	145
H. Adjournment:	
To adjourn a meeting of City Council, a majority of the Council members must vote for a motion to adjourn.	
1) Motion to adjourn	145

City of Shelby
Agenda Item Summary
June 4, 2018
City Hall Council Chamber

Agenda Item: B-1

Special Presentations

- 1) Recognition of Justin S. Merritt, Finance Director, and the City of Shelby's Finance Department as recipients of the Certificate of Achievement for Excellence in Financial Reporting awarded by the Government Finance Officers Association (GFOA) for the Fiscal Year ended June 30, 2017

(Comments: Mayor Stan Anthony and Rick Howell, City Manager)

Summary of Available Information:

- Letter from Government Finance Officers Association dated May 23, 2018

City Manager's Recommendation / Comments

At this time Mayor Anthony will present Justin Merritt, Finance Director with the "Certificate of Achievement" awarded by the non-profit Government Finance Officers Association for excellence in preparation of the CAFR. The City has achieved this award dating back more than 15 years and is a testament to the commitment of past and present management and finance directors to full public disclosure and communication of the financial condition of the City of Shelby. As I do every year I urge you to pay close attention to the CAFR. A hard copy is routinely provided to Council at the time the audit is presented and an electronic pdf version of the CAFR is maintained on the City's website dating back three fiscal years. It can be found at www.cityofshelby.com under the Finance Department heading.

Please join me in congratulating the Finance Department staff for their good work on behalf of the citizens of Shelby.



Government Finance Officers Association
203 North LaSalle Street, Suite 2700
Chicago, Illinois 60601-1210
312.977.9700 fax: 312.977.4806

May 23, 2018

The Honorable O. Stanhope Anthony, III
Mayor
City of Shelby
PO Box 207
Shelby, NC 28151-0207

Dear Mayor Anthony:

We are pleased to notify you that your comprehensive annual financial report (CAFR) for the fiscal year ended 2017 qualifies for GFOA's Certificate of Achievement for Excellence in Financial Reporting. The Certificate of Achievement is the highest form of recognition in governmental accounting and financial reporting, and its attainment represents a significant accomplishment by a government and its management.

When a Certificate of Achievement is awarded to a government, an Award of Financial Reporting Achievement (AFRA) is also presented to the individual(s) or department designated by the government as primarily responsible for its having earned the Certificate. This award has been sent to the submitter as designated on the application.

We hope that you will arrange for a formal presentation of the Certificate and Award of Financial Reporting Achievement, and that appropriate publicity will be given to this notable achievement. A sample news release is enclosed to assist with this effort.

We hope that your example will encourage other government officials in their efforts to achieve and maintain an appropriate standard of excellence in financial reporting.

Sincerely,

Michele Mark Levine
Director, Technical Services Center



GOVERNMENT FINANCE OFFICERS ASSOCIATION
NEWS RELEASE

FOR IMMEDIATE RELEASE

05/23/2018

For more information contact:
Michele Mark Levine, Director/TSC
Phone: (312) 977-9700
Fax: (312) 977-4806
E-mail: mlevine@gfoa.org

(Chicago, Illinois)--The Certificate of Achievement for Excellence in Financial Reporting has been awarded to **City of Shelby** by Government Finance Officers Association of the United States and Canada (GFOA) for its comprehensive annual financial report (CAFR). The Certificate of Achievement is the highest form of recognition in the area of governmental accounting and financial reporting, and its attainment represents a significant accomplishment by a government and its management.

An Award of Financial Reporting Achievement has been awarded to the individual(s) or department designated by the government as primarily responsible for preparing the award-winning CAFR.

The CAFR has been judged by an impartial panel to meet the high standards of the program, which includes demonstrating a constructive "spirit of full disclosure" to clearly communicate its financial story and motivate potential users and user groups to read the CAFR.

Government Finance Officers Association is a major professional association servicing the needs of nearly 19,000 appointed and elected local, state, and provincial-level government officials and other finance practitioners. It provides top quality publications, training programs, services, and products designed to enhance the skills and performance of those responsible for government finance policy and management. The association is headquartered in Chicago, Illinois, with offices in Washington, D.C.

City of Shelby
Agenda Item Summary
June 4, 2018
City Hall Council Chamber

C. Public Hearing:

Agenda Item: C-1

- 1) Proposed Fiscal Year (FY) 2018-2019 Annual Operating Budget for the City of Shelby
 - a. Consideration of Fiscal Year (FY) 2018-2019 Budget Ordinance: Ordinance No. 31-2018
 - b. Consideration of Fiscal Year (FY) 2018-2019 Supplemental Budget Ordinance: Ordinance No. 32-2018

Presenting: (Rick Howell, City Manager)

Summary of Available Information:

- Notice of Public Hearing
- Ordinance No. 31-2018
- Ordinance No. 32-2018

City Manager's Recommendation / Comments

City Council has previously been provided a copy the formal Budget Ordinance for the fiscal year beginning July 1, 2018, the Supplemental Budget Ordinance, the Authorized Personnel Summary, the Schedule of Fees and Charges as well as the Budget Summary. This hearing is required by the NC General Statutes to allow the public to comment on the proposed budget. A public copy has been provided in the administrative offices of City Hall and has been posted online for public inspection. The hearing is specifically intended to allow public comment directly to City Council for consideration prior to a formal vote.

Council may act on the budget following the close of the public hearing if it so desires. However, you may also choose to delay action. Council certainly may at your discretion act as it deems appropriate.

PUBLIC NOTICE

On May 14, 2018, the proposed Budget for Fiscal Year (FY) 2018-2019 for the City of Shelby, North Carolina was presented by the City Manager and has been distributed to the City Council. It is available for public inspection at City Hall, 300 South Washington Street, Shelby, North Carolina in the Office of the City Clerk weekdays from 8:00 a.m. to 5:00 p.m.

The City Council will hold a Public Hearing on Monday, June 4, 2018, at 6:00 p.m. on the proposed FY 2018-2019 Budget at City Hall Council Chamber, 300 South Washington Street, Shelby, North Carolina.

The City of Shelby holds all public meetings in accessible rooms. Any individual with a disability who needs an interpreter or other auxiliary aids or services for this meeting should call 336-992-0404 (voice) or 336-993-0196 (TDD) at least 48 hours before the scheduled meeting.

Bernadette A. Parduski
City Clerk

ORDINANCE NO. 31-2018

CITY OF SHELBY
FISCAL YEAR 2018-2019 BUDGET ORDINANCE

BE IT ORDAINED BY THE CITY COUNCIL OF THE CITY OF SHELBY, NORTH CAROLINA:

Sec. 1) The following amounts are hereby appropriated in the General Fund for the operation of City Government and its activities for the fiscal year beginning July 1, 2018 and ending June 30, 2019 in accordance with the chart of accounts heretofore established for this City:

Governing Board	\$82,617
Administration	248,546
Finance	487,192
Purchasing	115,260
Legal	12,200
Human Resources	216,703
Customer Service	140,204
Information Systems	166,365
Meter Services	50,592
Garage	473,975
City Hall	105,850
Police	7,701,070
Fire	4,562,606
Building Inspections	301,050
Streets	1,137,755
Airport	424,354
Solid Waste	1,683,935
Recycling	289,400
GIS	38,324
Planning Services	533,850
Special Appropriations	2,415,000
Parks & Recreation	1,452,225
Maintenance Grounds & Cemetery	<u>1,546,150</u>
Total	<u>\$24,185,223</u>

Sec. 2 It is estimated that the following revenues will be available to the General Fund for the fiscal year beginning July 1, 2018 and ending June 30, 2019:

Property Taxes	\$ 10,727,000
----------------	---------------

Local Option Sales Tax	3,900,000
Other Taxes	36,000
Unrestricted Intergovernmental Revenues	2,277,000
Restricted Intergovernmental Revenues	42,000
Permits and Fees	295,800
Sales & Services	2,646,400
Investment Revenues	60,000
Other Financing Sources	690,000
Fund Balance	211,023
Transfers	<u>3,300,000</u>
Total	<u>\$24,185,223</u>

Sec. 3) The following amounts are hereby appropriated in the Powell Bill Fund for the fiscal year beginning July 1, 2018 and ending June 30, 2019:

Construction	\$ 502,800
Street Maintenance	126,300
Debt Service	<u>106,500</u>
Total	<u>\$ 735,600</u>

Sec. 4) It is estimated that the following revenues will be available to the Powell Bill Fund for the fiscal year beginning July 1, 2018 and ending June 30, 2019:

Powell Bill	\$ 593,600
Interest Income	10,000
Proceeds from Financing	0
Fund Balance	<u>132,000</u>
Total	<u>\$ 735,600</u>

Sec. 5) The following amounts are hereby appropriated in the Emergency Telephone System Fund for the fiscal year beginning July 1, 2018 and ending June 30, 2019:

Emergency Telephone System	107,000
----------------------------	---------

Total \$ 107,000

Sec. 6) It is estimated that the following revenues will be available to the Emergency Telephone System Fund for the fiscal year beginning July 1, 2018 and ending June 30, 2019:

911 Revenues	107,000
Fund Balance Appropriated	<u>0</u>

Total \$ 107,000

Sec. 7) The following amounts are hereby appropriated in the Economic Development Fund for the fiscal year beginning July 1, 2018 and ending June 30, 2019:

Services	<u>\$ 671,500</u>
----------	-------------------

Total \$ 671,500

Sec. 8) It is estimated that the following revenues will be available to the Economic Development Fund for the fiscal year beginning July 1, 2018 and ending June 30, 2019:

MSD Property Taxes	\$ 108,500
Local Occupancy Tax	180,000
Investment Revenues	3,000
Other Income	3,000
Transfers	377,000
Fund Balance Appropriated	<u>0</u>

Total \$ 671,500

Sec. 9) The following amounts are hereby appropriated in the Housing Fund for the fiscal year beginning July 1, 2018 and ending June 30, 2019:

Conventional	<u>\$ 1,483,418</u>
--------------	---------------------

Total \$ 1,483,418

Sec. 10) It is estimated that the following revenues will be available to the Housing Fund for the fiscal year beginning July 1, 2018 and ending June 30, 2019:

Subsidies	\$ 739,416
-----------	------------

Rent Income	627,100
Investment Revenues	1,000
Other Income	0
Fund Balance	<u>115,902</u>

Total \$ 1,483,418

Sec. 11) The following amounts are hereby appropriated in the Cemetery Perpetual fund for the fiscal year beginning July 1, 2018 and ending June 30, 2019:

Fund Balance Increase	30,000
-----------------------	--------

Total \$ 30,000

Sec. 12) It is estimated that the following revenues will be available to the Cemetery Perpetual Fund for the fiscal year beginning July 1, 2018 and ending June 30, 2019:

Cemetery Fees	30,000
---------------	--------

Total \$ 30,000

Sec. 13) The following amounts are hereby appropriated in the Water Fund for the fiscal year beginning July 1, 2018 and ending June 30, 2019:

Administration	\$ 2,205,464
Line Operation	1,205,828
Plant	<u>2,018,508</u>

Total \$ 5,429,800

Sec. 14) It is estimated that the following revenues will be available to the Water Fund for the fiscal year beginning July 1, 2018 and ending June 30, 2019:

Fees	\$ 5,057,000
Proceeds From Financing	250,000

Fund Balance	0
Other Income	<u>122,800</u>
Total	<u>\$ 5,429,800</u>

Sec. 15) The following amounts are hereby appropriated in the Sewer Fund for the fiscal year beginning July 1, 2018 and ending June 30, 2019:

Administration	\$ 2,329,080
Line Operation	1,166,410
Plants	<u>1,956,010</u>
Total	<u>\$5,451,500</u>

Sec. 16) It is estimated that the following revenues will be available to the Sewer Fund for the fiscal year beginning July 1, 2018 and ending June 30, 2019:

Fees	\$ 5,398,000
Other Income	47,000
Proceeds From Financing	6,500
Fund Balance	<u>0</u>
Total	<u>\$ 5,451,500</u>

Sec. 17) The following amounts are hereby appropriated in the Electric Fund for the fiscal year beginning July 1, 2018 and ending June 30, 2019:

Administration	\$ 2,495,767
Purchase/Generation	16,900,000
Line Operation	<u>2,546,233</u>
Total	<u>\$21,942,000</u>

Sec. 18) It is estimated that the following revenues will be available to the Electric Fund for the fiscal year beginning July 1, 2018 and ending June 30, 2019:

Fees	\$21,864,000
Proceeds From Financing	41,000
Other Income	37,000
Fund Balance	<u>0</u>
Total	<u>\$21,942,000</u>

Sec. 19) The following amounts are hereby appropriated in the Gas Fund for the fiscal year beginning July 1, 2018 and ending June 30, 2019:

Administration	\$ 4,468,606
Gas Purchases	9,111,000
Line Operation	<u>2,134,994</u>
Total	<u>\$15,714,600</u>

Sec. 20) It is estimated that the following revenues will be available to the Gas Fund for the fiscal year beginning July 1, 2018 and ending June 30, 2019:

Fees	\$15,654,000
Other Income	25,600
Proceeds From Financing	35,000
Fund Balance	<u>0</u>
Total	<u>\$15,714,600</u>

Sec. 21) The following amounts are hereby appropriated in the Stormwater Fund for the fiscal year beginning July 1, 2018 and ending June 30, 2019:

Administration	803,600
Total	<u>\$ 803,600</u>

Sec. 22) It is estimated that the following revenues will be available to the Stormwater Fund for the fiscal year beginning July 1, 2018 and ending June 30, 2019:

Fees	\$ 785,100
Proceeds From Financing	<u>18,500</u>
Total	<u>\$ 803,600</u>

Sec. 23) That the revenues and expenditures set forth in Section 1 through Section 20 of this ordinance are hereby summarized as follows:

General Fund	\$24,185,223
Powell Bill Fund	735,600
Emergency Telephone System	107,000
Economic Development Fund	671,500
Housing Fund	1,483,418
Cemetery Perpetual Fund	30,000
Utilities-Water Fund	5,429,800
Utilities-Sewer Fund	5,451,500
Utilities-Electric Fund	21,942,000
Utilities-Gas Fund	15,714,600
Utilities-Stormwater Fund	<u>803,600</u>
Total	\$76,554,241
Less Interfund Transfers	<u>3,677,000</u>
Total FY 2018-19 Budget	<u>\$72,877,241</u>

Sec. 24) There is hereby levied a tax at the rate of fifty three cents (\$0.53) per one hundred dollars (\$100) valuation of property as listed for taxes as of January 1, 2018 for the purpose of raising the revenue listed as property taxes in the General Fund in Section 2 of this ordinance. This rate is based on an estimated total valuation of property for the purposes of taxation of \$2,021,700,000 and an estimated collection rate of 98.18%. The estimated rate of collection is based on the actual rate of collection for fiscal year 2017-18.

Sec. 25) There is hereby further levied an additional tax at the rate of twenty-five cents (\$0.25) per one hundred dollars (\$100) valuation of property as listed for taxes as of January 1, 2018 within the boundaries of the Uptown Shelby Municipal Service District for the purpose of raising the revenue listed as uptown district tax in the Economic Development Fund in Section 8 of this ordinance. This rate is based on

an estimated total valuation of property for the purposes of taxation of \$44,159,000 and an estimated collection rate of 98.36%. The estimated rate of collection is based on the actual rate of collection for fiscal year 2017-18.

Sec. 26) Copies of the Budget Ordinance shall be furnished to the City Manager (Budget Officer) and Finance Officer to be kept on file by them for their direction in the collection and disbursement of funds. Said officials are hereby authorized to receive and expend funds as herein set forth in accordance with the Shelby City Code and the General Statutes of the State of North Carolina.

Sec. 27) The following authorizations and restrictions shall apply to the adoption and enactment of this budget:

- A. The City Manager shall be authorized to reallocate departmental appropriations among the various objects of expenditure as he believes necessary.
- B. The City Manager shall be authorized to effect interdepartmental transfers in the same fund not to exceed ten percent (10%) of the appropriated monies for the department whose allocation is reduced.
- C. The City Manager shall be authorized to effect transfers between capital projects that are budgeted in the same capital project fund.
- D. The City Manager shall be authorized to transfer any remaining balances from any Capital Project upon its completion to the corresponding reserve fund. Interfund transfers from operating funds shall be accomplished by City Council authorization only.
- E. The budget adopted herein may be amended to reflect encumbrance balances for expenditures properly committed but unpaid at the end of the prior fiscal year, and increasing fund balances appropriated by a similar amount.

Adopted and approved this the 4th day of June 2018.

O. Stanhope Anthony III
Mayor

ATTEST:

Bernadette A. Parduski, NC-CMC, IIMC-MMC
City Clerk

APPROVED AS TO FORM:

Robert W. Yelton
City Attorney

ORDINANCE NO. 32-2018

CITY OF SHELBY
FISCAL YEAR 2018-2019 SUPPLEMENTAL BUDGET ORDINANCE

WHEREAS, in accordance with applicable provisions of the North Carolina Local Government Budget and Fiscal Control Act, the City of Shelby has enacted the FY 2018-19 Budget Ordinance, providing for the annual operating budget of the City for the stated fiscal year; and,

Whereas, in support of enactment of the subject Budget Ordinance various legislative actions are necessary and required of the Shelby City Council to effectively implement the City's budget plan; and,

WHEREAS, City Council now desires to act on the needed measures as referenced herein in accordance with said Fiscal Control Act, applicable provisions of the North Carolina General Statutes, and appropriate sections of the Shelby City Code;

NOW, THEREFORE, BE IT ORDAINED BY THE CITY COUNCIL OF THE CITY OF SHELBY, NORTH CAROLINA:

Section 1. The following actions are hereby adopted and approved in support of the City's FY 2018-19 Budget and the continued financial operations of the City subsequent thereto:

- a) The number of full-time positions authorized for employment by the City is confirmed as set forth in the Personnel Summary for a total of 332 positions. See Attachment A.
- b) The City's fee schedule effective July 1, 2018 is attached.

Section 2. The City Manager (Budget Officer) and Finance Director of the City are hereby authorized and directed to cause the provisions of Section 1 of this ordinance to be properly implemented in accordance with applicable provisions of law and the policies of the City of Shelby. Further, the City Manager is authorized to delegate, as may be appropriate, the responsibility for logistical implementation and administration of the various components of this supplemental budget ordinance. All provisions of the Shelby City Code, the City of Shelby Fee Schedule, related City policies, and any other applicable documents of the City, revised or modified by the provisions of this ordinance, are hereby affirmed and authorized for revision and recording where needed or required.

Section 3. This ordinance shall become effective with its adoption and approval, while all applicable budgetary authorizations subject to fiscal year requirements set forth herein are to be effective on July 1, 2018.

Adopted and approved this the 4th day of June 2018.

O. Stanhope Anthony III
Mayor

ATTEST:

Bernadette A. Parduski, NC-CMC, IIMC-MMC
City Clerk

APPROVED AS TO FORM:

Robert W. Yelton
City Attorney

Attachment A
Personnel Summary

**FY 2018-
2019**

General Fund	
Mayor/Council	
Administration	3.00
Finance	5.00
Purchasing	3.00
Human Resources	3.00
Customer Service	10.00
Information Services	2.00
Meter Services	5.00
Garage	10.00
Police	88.00
Fire	54.00
Building/Zoning	3.00
Streets	10.00
Airport	1.00
Sanitation	16.00
GIS	3.00
Community Development	6.00
Parks & Recreation	8.00
Maintenance & Cemetery	17.00
Total General Fund	247.00
Powell Bill	1.00
Housing	7.00
Utilities	
Water	18.00
Sewer	22.00
Electric	15.00
Gas	19.00
Stormwater	3.00
Total Utilities	77.00
Total Personnel	332.00

CITY OF SHELBY FEES SCHEDULE



To Be Adopted

Effective: July 1, 2018

TABLE OF CONTENTS

	PAGE
Airport Fee Schedule	1
Miscellaneous Fees	2
Parks and Recreation Fees	
Youth Athletic Programs & Admissions	3
Adult Athletic Programs	3
Aquatics Fees	4
Aerobics	4
Amusements	4
Summer Day Camp	4
Facility Rental Fees	4-5
Cemetery Fees	5
Golf Fees	5-6
Permit Fee Schedule	7
Planning Fee Schedule	8
Regulatory Fees	9
Solid Waste & Recycling Fee Schedule	10
Customer Service Schedule of Fees	11
Schedule of Utility Deposits	12
Water Service	
City Residential	13
Rural Residential	14
City Commercial	15
Rural Commercial	16
City Irrigation	17
Rural Irrigation	18
City Large Industrial	19
Rural Large Industrial	20
Bulk Resale	21
Governmental Rate	22
Sewer Service	
City	23-24
City Large Industrial	25
Rural	26-27
Rural Large Industrial	28
Governmental Rate	29
Water and Sewer Tap Fee Schedule	30
Miscellaneous Water and Wastewater Fees	31-32
Electric Service	
Residential - RS	33
All Electric - RA	33
Small General/Industrial Service - SG/I	34
Small General Service All Electric - SA	35
Medium and Large General Service - M/LG	36
Medium and Large General Service-All Electric - M/LA	37
Medium and Large Industrial Service - M/LI	38
Very Large Service - V/LG	39
Coincident Peak Rate	40-43
Renewable Energy Rider	44
Renewable Energy Credit Rider	45-46
Outdoor Lighting Contract	47
Natural Gas Service	
Natural Gas Base Rates	48
Residential Gas Service	49
General Commercial and Industrial Gas Service	50
High Load Factor Gas Service	51
Interruptible Gas Service	52-53
Natural Gas Industrial Firm Transportation Rate	54-56
Large Industrial Firm Gas	57-59
Natural Gas Incentives	60-61
Stormwater Utility	62-63



Shelby-Cleveland County Regional Airport Fee Schedule

<u>SERVICE</u>	<u>FEE</u>
Fuel (Av-Gas 100LL and Jet-A with Prist)	Posted price in terminal is adjusted with market pricing
Aircraft Tie Down	Monthly \$45.00 Daily \$10.00
Vehicle Parking Fees (Applies to approved automobiles left on airport premises)	Monthly \$20.00
After Hours Call Out (1 hour minimum charge)	\$45.00 per hour
Ground Power Unit (GPU) 1-4 hours	\$40.00
Each additional hour	\$10.00
(GPU fee waived for 1-4 hours with a 100 gallon fuel purchase)	
Conference Room Rental Rate	\$20.00 hourly up to 4 hours. After 4 hours \$100.00 per day. (Use of catering area additional \$25.00 per day). (Electronic Equipment Usage additional \$25.00 per day)

<u>AIRCRAFT HANGAR RENTAL</u>	<u>FEE</u>
Single Engine	Monthly \$200.00 Daily \$25.00
Twin Engine	Monthly \$300.00 Daily \$50.00
Turbine Engine (Less than 10,000 lbs.)	Monthly \$500.00 Daily \$75.00
Turbine Engine (Greater than 10,000 lbs.)	Monthly \$750.00 Daily \$100.00



CITY OF SHELBY

Miscellaneous Fees Effective 7/1/2016

Special Event Application	\$ 20.00 per event
Copy of Police Accident Report	\$ 1.00 each
Fingerprint Card	\$ 5.00 per card
Additional or New Roll Out Sanitation Cart Delivered	\$ 70.00 per cart
Sidewalk Café Permit	\$50.00 per year
Sidewalk Vendor/Temporary Food Establishment	\$50.00 per year
Taxi Cab Permits	\$ 15.00 per initial permit \$ 10.00 per renewal permit



City of Shelby Park and Recreation Fees

Youth Athletic Programs User Fees

Effective 7-1-2016

Replaces prior fees effective 7-1-2014

Sport	City/Other
Basketball	\$25/\$50
Softball	\$25/\$50
Baseball	\$25/\$50
Baseball/Softball Second Season	\$25/\$50
If played summer	\$10
Football	\$25/\$50
Cheerleading	\$25/\$50
Tennis Lessons	\$20/\$35 (2 weeks)
Golf Lessons	\$20/\$35 (2 weeks)

Youth Athletic Admission Fees

Sport	Fee
Football Games	\$1.00
Basketball Games	\$.50
Baseball Tournament Games	\$2.00 Adult \$1.00 Student

Adult Athletic Program User Fees

Sport	City/Other
Softball	\$10/\$25
Basketball	\$10/\$25
Adult Golf Lessons	\$40/\$60 hourly

Aquatics Fees

Program/Use	City/Other
Youth Daily	\$3.00 All
Adult Daily	\$4.00 All
Senior Daily	\$3.00 All
Youth Summer Pass	\$50/\$100
Adult Summer Pass	\$60/\$120
Senior Summer Pass	\$50/\$100
Family Summer Pass	\$150/\$300
Group Lessons	\$20/\$30 (2 weeks)
One on One Lessons	\$30/\$40 (2 weeks)
Mom & Tots	\$30/\$40 (2 weeks)
Lap Swim	\$2.00/\$3.00

Aerobics

	City/Other
Land Aerobics & Zumba	\$15/\$25 per month
Water Aerobics	\$2/\$3 per day

Amusements

	Fees
Carrousel	50 cents
Train	50 cents

Summer Day Camp

	City/Other
Base Fee	\$80/\$110 Per Week

Facility Rental Fees**

	City/Other
City Park Gym (no admission charged)	\$25/\$40 per hour – 3 hr. minimum
City Park Gym (admission charged)	\$40/\$50 per hour – 3 hr. minimum
Holly Oak Gym (no admission charged)	\$25/\$40 per hour – 3 hr. minimum
Holly Oak Gym (admission charged)	\$40/\$50 per hour – 3 hr. minimum
City Pavilion	\$40 per hour – 3 hr. minimum
Aquatics Center	\$100/\$150 per hour – 2 hr. minimum
Aquatics Party Area	\$15/\$25 per hour – 2 hr. minimum
Aquatics Conference Room	\$20/\$30 per hour
Carrousel	\$60/\$75 per hour – 2 hr. minimum
Train	\$60/\$75 per hour – 2 hr. minimum
CP Meeting Room	\$20/\$30 per hour
Tennis Courts	\$10/\$20 per hour

Outdoor Volleyball	\$10/\$20 per hour
Croquet Court	\$10/\$20 per hour
Horse Shoe Pits	\$10/\$20 per hour
Thompson Garden	\$75/\$100 per day
Holly Oak Old Center	\$75/\$100 per day
CP Scout Hut	\$75/\$100 per day
Civitan Picnic	\$30/\$50 per ½ day
Jaycee Picnic	\$30/\$50 per ½ day
Holly Oak Picnic	\$30/\$50 per ½ day
Optimist Park Picnic	\$30/\$50 per ½ day
Ball field (hour)	\$25/\$40 per hour
Ball field (full day)	\$150/\$200 per day
Ball field (weekend)	\$300/\$400 Sat & Sun
Ball field Lights (hour)	\$10 per hour

** Other fees may be applicable depending on the type of event being held.

Cemetery Fees

Lot	City/Other \$700/\$1,400
-----	------------------------------------

Golf

<u>Daily Fee Pricing:</u>	City/Other
	replaces prior fees effective 7-1-2016
Green Fee Weekdays – daily	\$9/\$11
Green Fee Weekends & Holidays - daily	\$11/\$13
Cart Weekdays – 9 holes	\$5
Cart Weekdays – 18 holes	\$9
Cart Weekend & Holidays – 9 holes	\$5
Cart Weekend & Holidays – 18 holes	\$9
Twilight Green Fee (1 ½ hours daylight)	\$7/\$9
Twilight Cart Fee (1 ½ hours daylight)	\$3

Membership Fee Pricing:

Rounds:	City/Other
Unlimited Annual Rounds	\$300/\$440
Unlimited Family	\$500/\$640
Player Card	\$40/\$60
Player Card Discount	\$2 off Green Fees
Adult Golf Lessons	\$40/\$60 hourly

Player Card & Membership Rewards include:

Incentive	20-rounds	40-rounds	60-rounds	80-rounds	100-rounds
Free Rounds	1 free Greens fee Weekday	2 free Greens fee Weekday	3-Free Cart Fee Weekday	5-Free Cart Fee Weekday	5-Free Rounds Weekday

- Play **FREE** on your birthday, includes cart (With Valid ID)
- 14-day advanced tee time reservations
- 1/2 hour early twilight
- 1 Free 10 minute lesson included
- 10% discount on merchandise purchases*
- Refer a friend to purchase a Players Card or Full Membership and receive a **FREE** Round of Golf
- \$2.00 off Greens Fee rack rate. (Players Card Only)



CITY OF SHELBY

PERMIT FEE SCHEDULE

New Construction Residential & Commercial Building Permits

Cost of total construction at \$115 sq. ft. Commercial or \$85 sq. ft. Residential or the owner's valuation whichever is greater multiplied by 0.004 = the permit fee.

Renovation Permits

\$100 Base Fee, plus \$.30 sq. ft.

Moving Permit	\$60.00
Demolition Permit	\$60.00
Manufactured Homes	\$300.00
Accessory Structures 400 sq. ft. or less	\$125.00
400 sq. ft. or greater	\$200.00
Swimming Pool	\$125.00
Electrical Permit	\$50.00
Plumbing Permit	\$50.00
Mechanical Permit	\$50.00
Gas Piping Permit	\$50.00
Insulation Permit	\$50.00
Re-inspection Fee	\$100.00
Min. Bldg. Permit Fee	\$100.00
Work started without permit	double the normal fee

Minimum Housing fees will consist of all costs accrued by the City of Shelby plus a 30 percent administration charge.

- The Building Inspector will determine building permit fees not listed
- All fees shall be rounded to the nearest dollar amount

Note: Permit fees are for blanket permits that include electrical, plumbing and mechanical.



CITY OF SHELBY
PLANNING FEE SCHEDULE

Effective 7-1-2016
Replaces fees effective 7-1-14
CURRENT FEES:

<u>PLANNING/ENGINEERING ACTIONS</u>	<u>CHARGE</u>
Minor Subdivision Review	\$50.00
Major Subdivision Review	\$50.00 + \$1 per lot
Stormwater Review > 1 acre	\$250.00
Site Plan Review > ½ acre	\$250.00
Site Plan Review < ½ acre	\$50.00
10%/70% Watershed Development	\$50.00
General Use Rezoning	\$500.00
Conditional District Rezoning	\$500.00
Conditional Use Permits	\$500.00
Special Use Permit	\$500.00
Zoning Verification Letter	\$20.00
Zoning Permit—Use By Right	\$60.00
Variances	\$500.00
Signs - 0-32 SF	\$25.00
All other signs	\$60.00
Annexation Requests	\$500.00
Street Closings	\$750.00
Curb Cut	\$5 per 12 foot section
Copies of the UDO	\$20.00
Sidewalk Café	\$50.00
Sidewalk Vendor	\$50.00
Right-Of-Way Encroachment Permit Application	\$50.00

Nuisance Abatement fees will consist of all costs accrued by the City of Shelby including administrative time.



CITY OF SHELBY

REGULATORY FEES

Beer, Malt Beverages, Wines:

On-premises malt beverage	\$ 15.00
Off-premises malt beverage	\$ 5.00
On-premises unfortified wine, on-premises fortified wine, or both	\$ 15.00
Off-premises unfortified wine, off-premises fortified wine, or both	\$ 10.00

The tax for each additional license of the same type issued for the same year is one hundred ten percent (110%) of the base license tax, that increase to apply progressively for each additional license.

Peddlers

On Foot	\$ 10.00
With Horse or Other Animal	\$ 15.00
With a Motor Vehicle	\$200.00
1. Vehicle over one-half ton	\$100.00
2. Vehicle one-half ton size or less	\$ 25.00
Fruit and Produce, per vehicle	\$ 12.50
Other types, per vehicle	\$ 25.00

Dealer/Purchase of Precious Metals

Precious Metals Dealer Permit	\$180.00
Certificate of Compliance for Employees	\$ 10.00
Special Occasion Permit	\$180.00
Dealer Permit Renewal Fee	\$180.00
Employee Certificate Renewal Fee	\$ 3.00



Effective 7/1/2018
Replaces rates dated 7/1/2017

Schedule Of Solid Waste and Recycling Fees

Solid Waste:

Service:	Monthly Fee
A-One Can Picked Up Once a Week	\$12.13
B-Two Cans Picked Up Once a Week	\$26.82
C-Four Cans Picked Up Once a Week	\$77.54
D-Three Cans Picked Up Twice a Week	\$102.90
E-Four Cans Picked Up Twice a Week	\$128.25
J-Two Cans Picked Up Twice a Week	\$52.17
J-Three Cans Picked Up Once a Week	\$52.17
Miscellaneous Charges:	
Replace 96-Gallon Rollout Can	\$70.00

Recycling:

Service:	
Monthly Recycling Fee	\$3.00
Monthly Recycling Credit for actual use	(\$.50)
Miscellaneous Charges:	
Replace 95-Gallon Rollout Can	\$70.00



Customer Service Schedule of Fees and Charges

Effective July 1, 2017
Replaces schedule effective April 20, 2015

SERVICE	8:00 AM TO 4:00 PM	WEEKEND HOLIDAY & AFTER 4:00 PM
SERVICE CALL**	N/C	\$60.00
NEW CUSTOMER SERVICE **	N/C	\$60.00
RETURN CHECK	\$25.00	N/A
NON-PAY COLLECTION CHARGE***	\$50.00	N/A
NON-PAY RECONNECT **	N/C	\$60.00
LATE PAYMENT FEE	\$10.00	N/A
REMOVE OR LOCK METER	\$40.00	N/A
METER TAMPERING	Max\$500 per NC Statutes	Max \$500 per NC Statutes
DISCONNECT ELECTRIC SERVICE AT RISER	\$60.00	\$125.00
RECONNECT ELECTRIC SERVICE AT RISER	\$60.00	\$125.00
DISCONNECT ELECTRIC SERVICE AT POLE	\$60.00	\$125.00
RECONNECT ELECTRIC SERVICE AT POLE	\$60.00	\$125.00
TEMP ELECTRIC SERVICE	N/A	N/A
FIRST METER TEST	N/C	N/A
2 ND REQ TEST (within 12 months)	\$40.00	N/A
FIRST UTILITY BILL REPRINT	N/C	N/A
2 ND UTILITY BILL REPRINT (within 12 months)	\$1.00	N/A
METER TEST (if tampering is involved)	\$40.00	N/A
RESET GAS METER	\$40.00	N/A
RELOCATE GAS SERVICE	\$5.00 / FT- \$100 min.	N/A
UPGRADE GAS SERVICE FROM INCHES TO LBS	Residential = \$75.00 Commercial=actual cost	N/A
N/C = no charge N/A = not available or applicable		Original schedule effective June 1, 2008

** Service calls to reconnect services will not be performed after 10 PM

***The City will waive one (1) Collection Charge as a courtesy in a 24 month period.



CITY OF SHELBY

SCHEDULE OF UTILITY DEPOSITS
Effective July 2012

WATER		
	RESIDENTIAL	\$30.00
	COMMERCIAL/INDUSTRIAL	TWO (2) MONTHS ESTIMATED BILL - PEAK USAGE MONTHS
SEWER		
	RESIDENTIAL	\$30.00
	COMMERCIAL/INDUSTRIAL	TWO (2) MONTHS ESTIMATED BILL - PEAK USAGE MONTHS
	RESIDENTIAL SEWER ONLY (no other utility services on account)	\$60.00
	COMMERCIAL SEWER ONLY (no other utility services on account)	TWO (2) MONTHS ESTIMATED BILL - PEAK USAGE MONTHS
ELECTRIC		
	RESIDENTIAL	\$120.00
	COMMERCIAL/INDUSTRIAL	TWO (2) MONTHS ESTIMATED BILL - PEAK USAGE MONTHS
GAS		
	RESIDENTIAL	\$140.00
	SMALL COMMERCIAL	\$140.00
	LARGE COMMERCIAL/INDUSTRIAL	TWO (2) MONTHS ESTIMATED BILL - PEAK USAGE MONTHS

If a social security number or federal tax ID number is not provided, the required deposit will be twice the scheduled amount.



**SCHEDULE RC-1
EFFECTIVE 07-01-2018**

Replaces Rates Effective 7-1-17

CITY OF SHELBY

RESIDENTIAL WATER SERVICE (CITY)

AVAILABILITY

Metered water service will be provided to consumers within the City limits of Shelby for residential use, where access to existing facilities is feasible.

RATE

Customer Charge Per Consumption Unit \$13.67 per billing period

\$2.35 per 1000 gals. used per billing period

The minimum bill is the Customer Charge.

CONDITIONS

New service generally requires a separate water meter to serve each dwelling, townhome, duplex, apartment complex, or other such residential consumption unit.

In existing service where one meter serves more than one consumption unit, each unit will be considered to carry one customer charge per billing period, regardless of individual or aggregate consumption.



**SCHEDULE RR-1
EFFECTIVE 07-01-2018**

Replaces rates dated
7-1-17

CITY OF SHELBY

RESIDENTIAL WATER SERVICE (RURAL)

AVAILABILITY

Metered water service will be provided to consumers outside the City limits of Shelby for residential use, where access to existing facilities is feasible.

RATE

Customer Charge Per Consumption Unit \$25.81 per billing period

\$4.66 per 1000 gals. used per billing period

The minimum bill is the Customer Charge.

CONDITIONS

New service generally requires a separate water meter to serve each dwelling, townhome, duplex, apartment complex, or other such residential consumption unit.

In existing service where one meter serves more than one consumption unit, each unit will be considered to carry one customer charge per billing period, regardless of individual or aggregate consumption.



CITY OF SHELBY

SCHEDULE CC-1
EFFECTIVE 07-01-2018
Replaces Rates dated
7-1-17

COMMERCIAL WATER SERVICE (CITY)

AVAILABILITY

Metered water service will be provided to consumers within the City limits of Shelby for commercial use, where access to existing facilities is feasible.

RATE

Customer Charge Per Consumption Unit \$15.28 per billing period

\$2.35 per 1000 gals. for first 15,000 gals. used per billing period

\$1.84 per 1000 gals. for all over 15,000 gals. used per billing period

The minimum bill is the Customer Charge.

CONDITIONS

New service generally requires a separate water meter to serve each store, shop, office, warehouse, storage building or other such commercial consumption unit.

In existing service where one meter serves more than one consumption unit, each unit will be considered to carry one customer charge per billing period, regardless of individual or aggregate consumption.



**SCHEDULE CR-1
EFFECTIVE 07-01-2018**

CITY OF SHELBY

Replaces Rates dated
7-1-17

COMMERCIAL WATER SERVICE (RURAL)

AVAILABILITY

Metered water service will be provided to consumers outside the City limits of Shelby for commercial use, where access to existing facilities is feasible.

RATE

Customer Charge Per Consumption Unit \$28.85 per billing period

\$4.66 per 1000 gals. for first 15,000 gals. used per billing period

\$3.94 per 1000 gals. for all over 15,000 gals. used per billing period

The minimum bill is the Customer Charge.

CONDITIONS

New service generally requires a separate water meter to serve each store, shop, office, warehouse, storage building or other such commercial consumption unit.

In existing service where one meter serves more than one consumption unit, each unit will be considered to carry one customer charge per billing period, regardless of individual or aggregate consumption.



SCHEDULE IC-1
EFFECTIVE 07-01-2014
Replaces rates dated 1-1-12

CITY OF SHELBY

IRRIGATION WATER SERVICE (CITY)

AVAILABILITY

Metered water service will be provided to consumers within the City limits of Shelby for irrigation use, where access to existing facilities is feasible.

RATE

\$2.70 per 1000 gals. used per billing period

CONDITIONS

Irrigation Systems – Commercial and Residential

All irrigation systems installed where water is provided by the City of Shelby must be connected to a separate irrigation meter installed by the City of Shelby. The City of Shelby requires the installation of a backflow assembly prior to the initiation of water service. At a minimum and consistent with the North Carolina Administrative Code "Rules Governing Public Water Systems", the City of Shelby will require the installation of Reduced Pressure Zone (RPZ) device for adequate water system protection.

To inquire about fees and obtaining an irrigation meter, call 704-484-6866

Once installed, please contact Customer Services (704)484-6866 for an inspection of backflow prevention assembly. Once the device has passed inspection, the meter will be activated by the City of Shelby Utilities.

An initial test of the Reduced Pressure Principle (RP) backflow assembly and annually thereafter, is required. The customer is responsible for this testing and shall be responsible for submission of the Backflow Device Testing Form to the City within 30 days of testing. All testing must be conducted by a contractor licensed by the State of North Carolina for testing of backflow prevention devices.

Testing information shall be forwarded to:

City of Shelby Utilities
c/o Backflow Prevention
Post Office Box 207
Shelby, NC 28151-0207

For additional questions regarding the Backflow Prevention Device please contact City of Shelby Utilities at 704-484-6840.



SCHEDULE IR-1
EFFECTIVE 07-01-2017
Replaces Rates dated 7-1-16

CITY OF SHELBY

IRRIGATION WATER SERVICE (RURAL)

AVAILABILITY

Metered water service will be provided to consumers outside the City limits of Shelby for irrigation use, where access to existing facilities is feasible.

RATE

\$6.14 per 1000 gals. used per billing period

CONDITIONS

Irrigation Systems – Commercial and Residential

All irrigation systems installed where water is provided by the City of Shelby must be connected to a separate irrigation meter installed by the City of Shelby. The City of Shelby requires the installation of a backflow assembly prior to the initiation of water service. At a minimum and consistent with the North Carolina Administrative Code "Rules Governing Public Water Systems", the City of Shelby will require the installation of Reduced Pressure Zone (RPZ) device for adequate water system protection.

To inquire about fees and obtaining an irrigation meter, call 704-484-6866

Once installed, please contact Customer Services (704)484-6866 for an inspection of backflow prevention assembly. Once the device has passed inspection, the meter will be activated by the City of Shelby Utilities.

An initial test of the Reduced Pressure Principle (RP) backflow assembly and annually thereafter, is required. The customer is responsible for this testing and shall be responsible for submission of the Backflow Device Testing Form to the City within 30 days of testing. All testing must be conducted by a contractor licensed by the State of North Carolina for testing of backflow prevention devices.

Testing information shall be forwarded to:

City of Shelby Utilities
c/o Backflow Prevention
Post Office Box 207
Shelby, NC 28151-0207

For additional questions regarding the Backflow Prevention Device please contact City of Shelby Utilities at 704-484-6840.



CITY OF SHELBY

SCHEDULE LIC-1
EFFECTIVE 07-01-2014
Replaces rates dated
1-1-12

LARGE INDUSTRIAL WATER SERVICE (CITY)

AVAILABILITY

Metered water service will be provided to consumers within the City limits of Shelby for industrial use, where access to existing facilities is feasible.

RATE

\$1.63 per 1000 gals. used per billing period

CONDITIONS

Large Industrial rate will be provided to industries involved in manufacturing, etc. who use in excess of 10,000,000 gallons per billing period on average.



CITY OF SHELBY

SCHEDULE LIR-1
EFFECTIVE 07-01-2017
Replaces Rates
dated 7-1-16

LARGE INDUSTRIAL WATER SERVICE (RURAL)

AVAILABILITY

Metered water service will be provided to consumers outside the City limits of Shelby for industrial use, where access to existing facilities is feasible.

RATE

\$2.78 per 1000 gals. used per billing period

CONDITIONS

Large Industrial rate will be provided to industries involved in manufacturing, etc. who use in excess of 10,000,000 gallons per billing period on average.

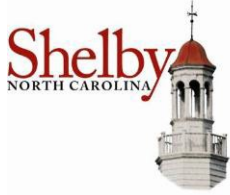

CITY OF SHELBY

SCHEDULE BW-1
EFFECTIVE 07-01-2014
Replaces Rates
dated 1-1-12

RESALE (BULK) WATER SERVICE

AVAILABILITY

Resale (Bulk) water service will be provided to customers at the 824 W Grover St metered site. Customers must have their own transport vessel.

RATE

\$5.57 per 1000 gals. used per billing period



CITY OF SHELBY

GOVERNMENTAL RATE

SCHEDULE G-1
EFFECTIVE 07-01-2014
Replaces Rates
dated 7-1-12

AVAILABILITY

Water service under this schedule is available by written contract to governmental authorities to be used for metered resale.

RATE

\$2.47 per 1000 gals. used per billing period



SCHEDULE C-10-20
EFFECTIVE 07-01-18
Replaces Rates Dated 07-01-17

CITY OF SHELBY

SEWER SERVICE (CITY)

AVAILABILITY

Sewer service will be furnished to residential, commercial and industrial customers within the corporate limits of Shelby, if access to existing City facilities is feasible.

RATE

A. CUSTOMERS RECEIVING FULL REQUIREMENTS SHELBY CITY WATER SERVICE

Customer Charge Per Water Consumption Unit \$ 19.97 per billing period

Volume Charge (Per 1000 gallons) \$ 4.29

The Minimum Bill is the Customer Charge.

B. CUSTOMERS NOT RECEIVING FULL REQUIREMENTS SHELBY CITY WATER SERVICE

Charge negotiated on basis of estimated or measured discharge of wastewater into the sewer system.

Minimum Bill: (1) \$41.42 for estimated discharge of 5000 gallons or less per billing period.

(2) Rate under A. when actual measured discharge is required under D.

C. CUSTOMERS RECEIVING LOW PRESSURE SEWER PUMP SERVICE

Customer Charge Per Consumption Unit \$19.97 per billing period

Customer Pump Charge
per Consumption Unit \$44.41 per billing period

Volume Charge (Per 1000 gallons) \$ 4.29

The Minimum Bill is the Customer Charge.

D. See "Conditions" Paragraph on Reverse Side.

SCHEDULE C-10-20

CONDITIONS

Sewer service billing for customers who receive all water used from the City water supply system, is normally based on the entire amount of water metered and delivered by the City.

A customer who uses water received from sources other than the City water supply system and which water is discharged into the City sewer system, may be required to install and maintain, without expense to the City of Shelby, an acceptable device, or devices, for measuring the quantity of water received. The customer will pay a sewer service charge for such water discharged into the City water supply system.

A user of the City water system for residential or commercial use, no part of which reaches the City sanitary sewer system, may avoid the regular sewer charge by having a separate water meter installed to measure water used for this purpose.

In the event that a person or corporation discharging industrial wastes into the City sanitary sewer system produces evidence to the City Manager that more than 10% of the total annual volume of water used for all purposes does not reach the City sanitary sewer, an estimated percentage of total water consumption to be used in computing charges may be agreed upon between the City Manager and the persons discharging industrial wastes into said sewer.

A full sewer service charge will be made for water used to fill swimming pools, wading pools, and storage containers; unless such use is determined, at the time of delivery, by a measuring device other than the installed property water meter.

The Code of Ordinances of the City of Shelby, Chapter 44 Article IV, Sections 44-121 through 44-230, covers restrictions on the discharge of wastes into the City sewer system and surcharge(s) for the treatment of wastes which are potentially harmful to the system and/or involve extra processing costs.

In existing service where one meter serves more than one consumption unit, each unit will be considered to carry one customer charge per billing period, regardless of individual or aggregate consumption.



CITY OF SHELBY

EFFECTIVE 07-01-18
Replaces Rates dated
07-01-17

SEWER SERVICE (CITY-Large Industrial)

AVAILABILITY

Sewer service will be furnished to industrial customers within the corporate limits of Shelby, if access to existing City facilities is feasible.

RATE

A. CUSTOMERS RECEIVING FULL REQUIREMENTS SHELBY CITY WATER SERVICE

Customer Charge Per Water Consumption Unit	\$ 178.04 per billing period
Volume Charge (Per 1000 gallons)	\$ 2.34

CONDITIONS

Customer must use a minimum of 1,000,000 per billing period to be eligible for this rate.

Sewer service billing for customers who receive all water used from the City water supply system, is normally based on the entire amount of water metered and delivered by the City.

In the event that a person or corporation discharging industrial wastes into the City sanitary sewer system produces evidence to the City Manager that more than 10% of the total annual volume of water used for all purposes does not reach the City sanitary sewer, an estimated percentage of total water consumption to be used in computing charges may be agreed upon between the City Manager and the persons discharging industrial wastes into said sewer.

The Code of Ordinances of the City of Shelby, Chapter 44 Article IV, Sections 44-121 through 44-230, covers restrictions on the discharge of wastes into the City sewer system and surcharge(s) for the treatment of wastes which are potentially harmful to the system and/or involve extra processing costs.



SCHEDULE R-10-20
EFFECTIVE 07-01-18
Replaces Rates Dated 07-01-17

CITY OF SHELBY

SEWER SERVICE (RURAL)

AVAILABILITY

Sewer service will be furnished to residential, commercial and industrial customers outside the corporate limits of Shelby, if access to existing City facilities is feasible.

RATE

A. CUSTOMERS RECEIVING FULL REQUIREMENTS SHELBY CITY WATER SERVICE

Customer Charge Per Water Consumption Unit \$32.02 per billing period

Volume Charge (Per 1000 gallons) \$7.20

The Minimum Bill is the Customer Charge

B. CUSTOMERS NOT RECEIVING FULL REQUIREMENTS SHELBY CITY WATER SERVICE

Charge negotiated on basis of estimated or measured discharge of wastewater into the sewer system.

Minimum Bill:

- (1) \$68.02 for estimated discharge of 5,000 gallons or less per billing period.
- (2) Rate under A. when actual measured discharge is required under D.

C. CUSTOMERS RECEIVING LOW PRESSURE SEWER PUMP SERVICE

Customer Charge Per Consumption Unit \$32.02 per billing period

Customer Pump Charge
per Consumption Unit \$47.53 per billing period

Volume Charge (Per 1000 gallons) \$7.20

The Minimum Bill is the Customer Charge.

D. See "Conditions" Paragraph on Reverse Side.

CONDITIONS

Sewer service billing for customers who receive all water used from the City water supply system, is normally based on the entire amount of water metered and delivered by the City.

A customer who uses water received from sources other than the City water supply system and which water is discharged into the City sewer system, may be required to install and maintain, without expense to the City of Shelby, an acceptable device, or devices, for measuring the quantity of water received. The customer will pay a sewer service charge for such water discharged into the City sewer system, as though all such water had been received from the City water supply system.

In the event that a person or corporation discharging industrial wastes into the City sanitary sewer system produces evidence to the City Manager that more than 10% of the total annual volume of water used for all purposes does not reach the City sanitary sewer, an estimated percentage of total water consumption to be used in computing charges may be agreed upon between the City Manager and the persons discharging industrial wastes into said sewer.

A full sewer service charge will be made for water used to fill swimming pools, wading pools, and storage containers; unless such use is determined, at the time of delivery, by a measuring device other than the installed property water meter.

The Code of Ordinances of the City of Shelby, Chapter 44 Article IV, Sections 44-121 through 44-230, covers restrictions on the discharge of wastes into the City sewer system and surcharge(s) for the treatment of wastes which are potentially harmful to the system and/or involve extra processing costs.

In existing service where one meter serves more than one consumption unit, each unit will be considered to carry one customer charge per billing period, regardless of individual or aggregate consumption.



**CITY OF SHELBY
SEWER SERVICE (Rural-Large Industrial)**

EFFECTIVE 07-01-18
Replaces Rates dated
07-01-17

AVAILABILITY

Sewer service will be furnished to industrial customers not within the corporate limits of Shelby, if access to existing City facilities is feasible.

RATE

A. CUSTOMERS RECEIVING FULL REQUIREMENTS SHELBY CITY WATER SERVICE

Customer Charge Per Water Consumption Unit	\$ 286.24 per billing period
Volume Charge (Per 1,000 gallons)	\$ 3.95

CONDITIONS

Customer must use a minimum of 1,000,000 per billing period to be eligible for this rate.

Sewer service billing for customers who receive all water used from the City water supply system, is normally based on the entire amount of water metered and delivered by the City.

In the event that a person or corporation discharging industrial wastes into the City sanitary sewer system produces evidence to the City Manager that more than 10% of the total annual volume of water used for all purposes does not reach the City sanitary sewer, an estimated percentage of total water consumption to be used in computing charges may be agreed upon between the City Manager and the persons discharging industrial wastes into said sewer.

The Code of Ordinances of the City of Shelby, Chapter 44 Article IV, Sections 44-121 through 44-230, covers restrictions on the discharge of wastes into the City sewer system and surcharge(s) for the treatment of wastes which are potentially harmful to the system and/or involve extra processing costs.



SCHEDULE G-10-10
EFFECTIVE 07-01-15
Replaces Rates Dated 07-01-14

CITY OF SHELBY

**SEWER SERVICE
GOVERNMENTAL RATE**

AVAILABILITY:

Sewer service under this schedule is available by written contract to governmental authorities to be used for metered resale.

RATE:

Customer Charge per service connection	\$22.43 per billing period
Volume Charge (per 1000 gallons)	\$6.41 per billing period

CONDITIONS:

Any governmental unit receiving this rate must upon written request from the City of Shelby provide a list of service connections to the sewer lines. The customer charge will be calculated based on the total number of connections to the sewer system.

In existing service where one meter serves more than one consumption unit, each unit will be considered to carry one customer charge per billing period, regardless of individual or aggregate consumption.

CITY OF SHELBY

WATER AND SEWER FEE SCHEDULE (FY 2018-2019)

SEWER

Tap Size	Tap Fee	Service Fee	Total Cost
4"	\$900	\$500	\$1,400
6"	\$900	\$600	\$1,500
8"	\$900	\$2,000	\$2,900
10"	\$900	\$3,000	\$3,900
12"	\$900	\$4,000	\$4,900

Sewer tap fee includes tap and manhole boot only. Contractor is responsible to run service pipe to tap in conjunction with Shelby Utilities

Sewer service fee only applies to new services at individual public service locations.

Service line replacement will only incur a tap fee.

Tap fee does not apply in new subdivisions. All public infrastructure shall be pretapped by contractor.

WATER

Tap Size	Tap Fee	Meter Set Fee	Service Fee	Total Cost
3/4"	\$1,100	\$180	\$200	\$1,480
1"	\$1,100	\$270	\$400	\$1,770
1 1/2"	\$1,500	\$735	\$600	\$2,835
2"	\$1,800	\$1,350	\$800	\$3,950
3"	\$350	N/A	\$1,000	\$1,350
4"	\$350	N/A	\$1,500	\$1,850
6"	\$350	N/A	\$3,000	\$3,350
8"	\$350	N/A	\$4,000	\$4,350

Hydrant Relocation Fee	\$2,700 or actual cost, whichever is greater
------------------------	--

Water tap fee (for 3/4", 1", 1 1/2", and 2") includes all necessary hardware to tie to existing water main and includes meter box and service line providing connection between the meter box and the water main.

Meter Set fee:

-For 3/4", 1" 1 1/2", and 2" water services, the meter set fee includes the City providing and installing appropriate water meter, and the administrative costs of starting water service.

-For 3", 4", 6", and 8" water services, no meter set fee exists. The contractor shall provide and install approved water meter. Water meter* to be provided and installed by contractor.

Water service fee only applies to new services at individual public service locations.

Tap fee does not apply in new subdivisions. All public infrastructure shall be pretapped by contractor.

*All water meters shall be compatible with Itron MVRS remote meter reading system.

City will perform tap on all existing water and sewer lines, and will also provide work on all meter and hydrant relocations. Meter relocation charge shall be the same as tap fee.

Tap Service Fees for Assessment Areas:

Service fees will be calculated in the total project cost assuming 100% connection.

Connection to stubout after completion in assessment area shall be \$50.00.



Fee Schedule - Miscellaneous Water and Wastewater Fees

Miscellaneous Water Fees

Hydrant Meter Deposits:

Deposit required for Hydrant Flow Meter \$1500.00

Backflow Preventer Testing Charge

City Staff to perform Backflow Device Testing \$60.00

Miscellaneous Wastewater Fees

Significant Industrial User (SIU) Fee \$450.00/month

Pretreatment Surcharges:

<i>High Strength BOD</i>	<i>(For BOD >250 mg/L)</i>	<i>\$0.20 per lb.</i>
<i>High Strength TSS</i>	<i>(For TSS >250 mg/L)</i>	<i>\$0.15 per lb.</i>
<i>High Strength NH3-N</i>	<i>(For NH3-N >15.0 mg/L)</i>	<i>\$0.40 per lb.</i>

Additional Pretreatment Fees:

Non-Significant Industrial User Fees

- *Permit Application – Initial Permit Development* *No Charge*
- *Permit Issuance – Due upon Approval of Permit* *\$200.00*
- *Annual Permit Renewal/Modification Fee* *\$100.00*

Sampling & Miscellaneous Fees

- *Sampling/Monitoring Fees** *Cost to City (Contract Lab)*
- *Toxicity Monitoring (Acute and Chronic)* *Cost to City (Contract Lab)*

**SIU Fees include sampling as outlined by permit. Any additional samples will be billed at cost to the customer. Food Service Establishments requiring testing for Fats, Oils and Grease discharges are included in this category.*

FOG Charges:

<i>Small Customer</i>	<i>0 to 10,000 gals</i>	<i>\$9.52 per month</i>
<i>Medium Customer</i>	<i>10,001 to 50,000 gals</i>	<i>\$14.28 per month</i>
<i>Large Customer</i>	<i>50,001 or greater gals</i>	<i>\$19.04 per month</i>

NOTE: Rate based on water usage per month and can be adjusted accordingly with usage.

Septage Fees:

Septage Load: \$60.00/Load (Typical load ≤2500 gallons)

Annual Permit Fee: \$100.00 *

NOTE: *Permit will be issued for calendar year and Permit Fee is billed upon initial issuance and every December thereafter.

Low Pressure Sewer System:

New Connections: Low Pressure Pump shall be obtained from the City of Shelby.

Cost = Current pump pricing + 4" sewer tap fee + 4" sewer service fee.



City of Shelby
Residential Electric Rate Schedules

Schedule RS

Effective 10-01-16 Billing

Replaces rates dated 07-01-14

Residential Electric Service- Available only to residential customers in residences, condominiums, mobile homes or individually metered apartments.

Charges are calculated as follows:

Residential		
	Summer (June-September)	Non-Summer (October-May)
Basic Facilities Charge	\$13.13	\$13.13
Energy Charges:		
First 500 kWh	10.974 cents	10.974 cents
Next 500 kWh	10.974 cents	10.321 cents
Over 1,000 kWh	10.719 cents	10.005 cents

Any applicable North Carolina state or local sales tax will be added to the customer's total charges.

Schedule RA

Effective 10-01-16 Billing

Replaces rates dated 07-01-14

Residential Service- All Electric- Available only to residential customers in residences, condominiums, mobile homes or individually metered apartments. In addition, all energy required for all water heating, cooking, clothes drying and environmental space conditioning must be supplied electrically, and all electric energy used in such dwelling must be recorded through a single meter.

Charges are calculated as follows:

Residential All Electric		
	Summer (June-September)	Non-Summer (October-May)
Basic Facilities Charge	\$13.13	\$13.13
Energy Charges:		
First 500 kWh	10.974 cents	10.974 cents
Next 500 kWh	10.586 cents	10.062 cents
Over 1,000 kWh	10.586 cents	8.512 cents

Any applicable North Carolina state or local sales tax will be added to the customer's total charges.



City of Shelby
Electric Rate Schedule

Schedule SG/I

Effective 10-01-16 Billing

Replaces rates dated 07-01-14

Small General/Industrial Service - Available to the non-residential customer with monthly demand of 100kW or less.

Charges are calculated as follows:

	Rate	
Basic Facilities Charge	\$26.00	\$26.00
Minimum Demand: 30 kW		
	Summer (June- September)	Non- Summer (October- May)
Demand Charge:		
First 30 kW	No Charge	No Charge
All kW Over 30	\$ 8.00	\$8.00
Energy Charge:		
For the First 100 kWh per kW Billing Demand per month		
First 3,000 kWh	13.000 cents	13.000 cents
All Over 3,000 kWh	8.600 cents	8.100 cents
For the Next 200 kWh per kW Billing Demand per Month		
All kWh	8.600 cents	8.100 cents
For All Over 300 kWh per kW Billing Demand Per Month		
All kWh	8.600 cents	8.100 cents

Any applicable North Carolina state or local sales tax will be added to the customer's total charges.



City of Shelby
Electric Rate Schedules

Schedule SA

Effective 10-01-16 Billing

Replaces rates dated 07-01-14

Small General Service All-Electric - Available to the non-residential customer with a monthly demand of 100 kW or less in which environmental space conditionings is required and all energy for such conditioning (heating and cooling) is supplied electrically thorough the same meter as all other electric energy used in the establishment. However, if any such establishment contains residential housekeeping units, all energy for all water heating and cooking for such units is also supplied electrically.

Charges are calculated as follows:

	Rate	
Minimum Demand: 30 kW		
Basic Facilities Charge	\$26.00	\$26.00
	Summer (June- September)	Non- Summer (October- May)
Demand Charge:		
First 30 kW	No Charge	No Charge
All kW Over 30	\$8.00	\$8.00
Energy Charge:		
For the First 100 kWh per kW Billing Demand per month		
First 3,000 kWh	13.000 cents	13.000 cents
All Over 3,000 kWh	8.600 cents	8.100 cents
For the Next 200 kWh per kW Billing Demand per Month		
All kWh	8.600 cents	8.100 cents
For All Over 300 kWh per kW Billing Demand Per Month		
All kWh	8.600 cents	8.100 cents

Any applicable North Carolina state or local sales tax will be added to the customer's total charges.



City of Shelby
Electric Rate Schedule

Schedule M/LG

Effective 10-01-16 Billing

Replaces rates dated 07-01-14

Medium and Large General Service- Available to the non-residential customer whose monthly demand exceeds 100 kW but less than 500 kW in any three months out of twelve consecutive monthly billing periods, including the current billing period.

Charges are calculated as follows:

	Rate	
	Summer (June- September)	Non- Summer (October- May)
Basic Facilities Charge	\$50.00	\$50.00
Minimum Demand: 30kW		
Demand Charge:		
All kW	\$9.76	\$7.94
Energy charge:		
For the First 100 kWh per kW Billing Demand per Month		
All kWh	7.200 cents	7.200 cents
For the Next 200 kWh per kW Billing Demand per Month		
All kWh	7.200 cents	7.200 cents
For All Over 300 kWh per kW Billing Demand Per Month		
All kWh	7.200 cents	7.200 cents

Any applicable North Carolina state or local sales tax will be added to the customer's total charges.



City of Shelby
Electric Rate Schedule

Schedule M/LA

Effective 10-01-16 Billing

Replaces rates dated 07-01-14

Medium and Large General Service All-Electric – Available to the non-residential customer whose monthly demand exceeds 100 kW in any three months out of twelve consecutive monthly billing periods, including the current billing period, in which environmental space conditioning is required and all energy for all such conditioning (heating and cooling) is supplied electrically through the same meter as all other electric energy used in the establishment. However, if any such establishment contains residential housekeeping units, all energy for all water heating and cooking for such units is also supplied electrically.

Charges are calculated as follows:

	Rate	
Basic Facilities Charge	\$60.00	\$60.00
Minimum Demand: 30kW		
	Summer (June- September)	Non- Summer (October- May)
Demand Charge:		
All kW	\$9.76	\$7.94
Energy charge:		
For the First 100 kWh per kW Billing Demand per Month		
All kWh	7.200 cents	6.820 cents
For the Next 200 kWh per kW Billing Demand per Month		
All kWh	7.200 cents	6.820 cents
For All Over 300 kWh per kW Billing Demand Per Month		
All kWh	7.200 cents	6.820 cents

Any applicable North Carolina state or local sales tax will be added to the customer's total charges.



City of Shelby
Electric Rate Schedule

Schedule M/LI

Effective 10-01-16 Billing

Replaces rates dated 07-01-14

Medium and Large Industrial Service – Available only to establishments classified as “Manufacturing Industries” by the Standard Industrial Classification manual, 1957 or later version, published by the Bureau of Budget, United States Government, and where more than 50% of the electric consumption of such establishment is used for its manufacturing processes whose monthly demand exceeds 100 kW in any three months out of twelve consecutive monthly billing periods, including the current billing period. Charges are calculated as follows:

	Rate	
	Summer (June- September)	Non- Summer (October- May)
Basic Facilities Charge	\$80.00	\$80.00
Minimum Demand: 30kW		
Demand Charge:		
All kW	\$9.76	\$7.94
Energy charge:		
For the First 100 kWh per kW Billing Demand per Month		
All kWh	6.810 cents	6.810 cents
For the Next 200 kWh per kW Billing Demand per Month		
All kWh	6.810 cents	6.810 cents
For All Over 300 kWh per kW Billing Demand Per Month		
All kWh	6.810 cents	6.810 cents

Any applicable North Carolina state or local sales tax will be added to the customer’s total charges.



City of Shelby
Electric Rate Schedule

Schedule V/LG

Effective 10-01-16 Billing

Replaces rates dated 07-01-14

Very Large General Service – Available to the non-residential customer whose monthly demand is 500 kW or greater in any three months out of twelve consecutive monthly billing periods, including the current billing period.

Charges are calculated as follows:

	Rate	
Basic Facilities Charge	\$150.00	\$150.00
Minimum Demand: 30kW		
	Summer (June- September)	Non- Summer (October- May)
Demand Charge:		
All kW	\$9.76	\$7.94
Energy charge:		
For the First 100 kWh per kW Billing Demand per Month		
All kWh	6.550 cents	6.550 cents
For the Next 200 kWh per kW Billing Demand per Month		
All kWh	6.550 cents	6.550 cents
For All Over 300 kWh per kW Billing Demand Per Month		
All kWh	6.550 cents	6.550 cents

Any applicable North Carolina state or local sales tax will be added to the customer's total charges.



SCHEDULE CP-98-2-9
EFFECTIVE 10-01-16 BILLING
Replaces Rates dated 07-01-14

City of Shelby
Coincident Peak Rate - 98 – 2
Electric Rate Schedule CP-98-2

AVAILABILITY

Available only to new commercial or industrial loads which begin receiving service after July 1, 1998. The demand of the new load must equal or exceed 500 kW but be less than 3,000 kW during at least three months of a twelve-month period.

Service under this Schedule shall be used solely by the contracting customer in a single enterprise, located entirely on a single contiguous site or premises.

This Schedule is not available for auxiliary or breakdown service and power delivered hereunder shall not be used for resale or exchange or in parallel with other electric power, or as a substitute for power contracted for or which may be contracted for under any other schedule of the City, except at the option of the City, under special terms and conditions expressed in writing in the contract with the Customer.

The obligations of the City in regard to supplying power are dependent upon its securing and retaining all necessary rights-of-way, privileges, franchises, and permits for the delivery of such power, and the City shall not be liable to any customer or applicant for power in the event the City is delayed in, or is prevented from furnishing the power by its failure to secure and retain such rights-of-way, rights, privileges, franchises, and/or permits.

TYPE OF SERVICE

The City will furnish 60-Hertz service through one meter, at one delivery point, at one of the following approximate voltages where available:

- Single-phase, 120/240 volts; or
- 3 phase, 208Y/120 volts, 480Y/277 volts; or
- 3 phase, 3 wire, 240, 480, 575, or 2400 volts, or
- 3 phase 4160Y/2400, 12470Y/7200, or
- 3 phase voltages other than the foregoing, but only at the City's option, and provided that the size of the Customer's load and the duration of the Customer's contract warrants a substation solely to serve that Customer, and further provided that the Customer furnish suitable outdoor space on the premises to accommodate a ground-type transformer installation, or substation, or a transformer vault built in accordance with the City's specifications.

The type of service supplied will depend upon the voltage available at or near the Customer's location. Prospective customers should ascertain the available voltage by inquiry at the office of the City before purchasing equipment.

Motors of less than 5 HP may be single-phase. All motors of more than 5 HP must be equipped with starting compensators and all motors of more than 25 HP must be of the slip ring type except that the City reserves the right, when in its opinion the installation would not be detrimental to the service of the City, to permit other types of motors.

MONTHLY RATE

A. Basic Facilities Charge	\$500.00
B. Demand Charge:	
Monthly Billing Demand	
On-Peak Summer (June–Sept.)	\$18.00 per kW
On-Peak Winter (Oct.–May)	\$5.00 per kW
Excess Demand (all months)	\$3.50 per kW
C. Energy Charge:	
Summer (June–Sept.)	
On-Peak	\$0.05680 per kWh
Off-Peak	\$0.05038 per kWh
Winter (Oct.–May)	
On-Peak	\$0.04988 per kWh
Off-Peak	\$0.04543 per kWh

DEFINITION OF “MONTH”

The term “month” as used in the Schedule means the period intervening between meter readings for the purposes of monthly billing, such readings being taken once a month.

DETERMINATION OF BILLING DEMAND**Billing Demand:**

Billing Demand shall be the average of the integrated clock hour kW demands measured during the hours of the On-Peak Period on the day identified as the Peak Management Day used by the North Carolina Municipal Power Agency Number 1 (NCMPA1) for wholesale billing purposes during the corresponding month of Customer's billing.

On-Peak Periods:

On-peak periods are non-holiday weekdays during the following times:

June-September	2pm – 6pm
December-February	7am – 9am
All other months	7am – 9am and 2pm – 6pm

Holidays:

The following days of each calendar year are considered holidays: New Years Day, Good Friday, Memorial Day, Independence Day, Labor Day, Thanksgiving Day, the Friday following Thanksgiving Day, and Christmas Day. In the event that any of the foregoing Holidays falls on a Saturday, the preceding Friday shall be deemed to be the Holiday. In the event any of the foregoing Holidays falls on a Sunday, the following Monday shall be deemed to be the Holiday.

Peak Management Days:

Peak Management Days are the days on which NCMPA1 notifies its Participants to activate their peak management programs during On-Peak periods. The Peak Management Day used to establish the city’s wholesale billing demand is the one Peak Management Day during the month on which NCMPA1 experienced the greatest average load (determined as the average of NCMPA1’s integrated hourly loads during the hours of the On-Peak Period).

EXCESS DEMAND

Excess demand shall be the difference between the maximum integrated clock hour kW demand recorded during the current billing month and the Billing Demand for the same billing month.

NOTIFICATION BY CITY

The City will use diligent efforts to provide advance notice to the Customer of Peak Management Days if requested. However, the City does not guarantee that advance notice will be provided. Notification by the City will be provided to the Customer by direct telephone communications or automatic signal, as mutually agreed. The Customer will hold the City harmless in connection with its response to notification.

DETERMINATION OF ENERGY

The kWh of energy shall be the sum of all energy used during the current billing month as indicated by watt-hour meter readings.

ON-PEAK ENERGY

For billing purposes in any month, On-Peak Energy, in kWh, shall be the metered energy during the On-Peak Energy Period, whereby the On-Peak Energy Period is defined as non-holiday weekdays from 7:00 AM to 11:00 PM.

OFF-PEAK ENERGY

For billing purposes in any month, Off-Peak Energy, in kWh, shall be the metered total monthly energy less the amount of energy billed in that month under On-Peak Energy.

POWER FACTOR CORRECTION

When the average monthly power factor of the Customer's power requirements is less than 90 percent, the City may correct the integrated demand in kilowatts for that month by multiplying by 90 percent and dividing by the average power factor in percent for that month.

CONTRACT PERIOD

Each customer shall enter into a contract to purchase electricity from the City for a minimum original term of one (1) year, and thereafter from year to year upon the condition that either party can terminate the contract at the end of the original term, or at any time thereafter, by giving at least sixty (60) days prior notice of such termination in writing; but the City may require a contract for a longer original term of years where the requirement is justified by the circumstances.

SALES TAX

North Carolina sales tax of 7% shall be added to the customer's total charges for each month, determined in accordance with the above electric rates.

City of Shelby
Electric Rate Rider REPS
Renewable Energy Portfolio Standards (REPS) Charge

Applicability

The Renewable Energy Portfolio Standards Charge set forth in this Rider is applicable to all customer accounts receiving electric service from the City of Shelby, except as provided below. These charges are collected for the expressed purpose of enabling the City to meet its Renewable Energy Portfolio Standards compliance obligations as required by the North Carolina General Assembly in its Senate Bill 3 ratified on August 2, 2007.

Billing

Monthly electric charges for each customer account computed under the City’s applicable electric rate schedule will be increased by an amount determined by the table below:

Customer Type	<u>Monthly Charges</u>		
	<u>Renewable Resources</u>	<u>DSM/Energy Efficiency</u>	<u>Total REPS Charge</u>
Residential Account	\$ 0.68	\$ 0.00	\$ 0.68
Commercial Account	\$ 3.71	\$ 0.00	\$ 3.71
Industrial Account	\$38.22	\$ 0.00	\$38.22

Exceptions

Industrial and Commercial Customer Opt-out

All industrial customers, regardless of size, and large commercial customers with usage greater than one million kWh’s per year can elect not to participate in City’s demand-side management and energy efficiency measures in favor of its own implemented demand-side management and energy efficiency measures by giving appropriate written notice to the City. In the event such customers “opt-out”, they are not subject to the DSM/Energy Efficiency portion of the charges above. All customers are subject to the Renewable Resources portion of the charges above.

Auxiliary Service Accounts

The following service schedules will not be considered accounts because of the low energy use associated with them and the near certainty that customers served under these schedules already will pay a per account charge under another residential, commercial or industrial service schedule:

- Outdoor Lighting Service (metered and unmetered)
- Street and Public Lighting Service
- Traffic Signal Service

Sales Tax

Applicable North Carolina sales tax will be added to charges under this Rider.

Effective for service rendered after July 1, 2018.

**City of Shelby
Renewable Energy Credit Rider
Electric Rate Rider RECR-1**

AVAILABILITY

This optional rate rider is available to customers on any City of Shelby (“City”) rate schedule who operate solar photovoltaic, wind powered, or biomass-fueled generating systems, without battery storage, located and utilized at the customer’s primary residence or business. To qualify for this rate rider, the customer must have complied with the City’s Interconnection Standards and have an approved Interconnection Request Form. As part of the Interconnection Request Form approval process, the City retains the right to limit the number and size of renewable energy generating systems installed on the City’s System. The generating system that is in parallel operation with service from the City and located on the customer’s premises must be manufactured, installed, and operated in accordance with all governmental and industry standards, in accordance with all requirements of the local code official, and fully conform with the City’s applicable renewable energy interconnection interface criteria. Qualified customers must be generating energy for purposes of a “buy-all/sell-all” arrangement to receive credits under this rate rider. That is, the City agrees to buy all and the customer agrees to sell all of the energy output and associated energy from the renewable energy resource. Customers with qualified systems may also apply for NC GreenPower credits or sell Renewable Energy Certificate (“REC”) credits.

All qualifying facilities have the option to sell energy to the City on an “as available” basis and receive energy credits based on the Variable Rates identified in this Rider for the delivered energy.

MONTHLY CREDIT

Monthly credits are paid according to the type of renewable generation.

Wind and Biomass Energy Credit (\$ Per kWh):

	<u>Variable</u>
On-peak energy*	\$0.028
Off-peak energy	\$0.0103

Solar Photovoltaic Energy Credit (\$ Per kWh):

	<u>Variable</u>
All energy*	\$0.0304

* These energy credits include a capacity component.

MONTHLY ENERGY

Monthly Energy shall be the total kWh of energy produced by the generating facility during the current calendar month. All energy produced by the Customer's renewable energy generating system must be delivered to the City, since the city does not offer net metering at this time.

ON-PEAK ENERGY

On-Peak Energy shall be the metered energy during the On-Peak Energy Period of the current calendar month, whereby the On-Peak Energy Period is defined as non-holiday weekdays from 7:00 AM to 11:00 PM EPT.

OFF-PEAK ENERGY

Off-Peak Energy shall be the Monthly Energy less the amount of energy billed as On-Peak Energy.

CONTRACT PERIOD

Prior to receiving service under this Rider, the City and the customer shall have entered either an Interconnection Agreement or executed a Certificate of Completion (inverter-based generators less than 10 kW) and a Power Purchase Agreement which covers the special terms and conditions for the customer's requirements related to the interconnection of the customer's renewable energy generating system.

Each of these agreements shall have a minimum term of one (1) year. Either party may terminate the agreements after one year by giving at least thirty (30) days previous notice of such termination in writing.

GENERAL

Service under this Rider is subject to the provisions of the Service Regulations of the City contained in the *City of Shelby Terms and Conditions of Electric Service and Electric Service Regulations*.

SPECIAL CONDITIONS

The customer's service shall be metered with two meters, one of which measures all energy provided by the City and used by the customer, and the other measures the amount of energy generated by the customer's renewable energy generator which is provided to the City.

In the event that the City determines that it is necessary to install any additional equipment to protect the safety and adequacy of electric service provided to other customers, the customer shall pay for the cost of such equipment in accordance with the terms of its Power Purchase Agreement.

Effective July 1, 2018.



City of Shelby
Outdoor Lighting Schedule
Effective July 1, 2017
Replaces rates effective October 1, 2016

Standard Outdoor Lighting Rental Rates

	Monthly Charge
	<u>Per Unit</u>
40 watt, 3,500 lumen LED	\$ 15.64
73 watt, 8,085 lumen LED	\$ 16.87
161 watt, 16,300 lumen LED	\$ 19.81
100 watt, 9,500 lumen High Pressure Sodium NEMA Head*	\$ 11.60
150 watt, 15,000 lumen, High Pressure Sodium*	\$ 17.40
250 watt, 27,500 lumen, High Pressure Sodium*	\$ 28.99
250 watt, 27,500 lumen, High Pressure Sodium, Flood Light*	\$ 28.99
400 watt, High Pressure Sodium Flood fixture	\$ 35.75
400 watt, Customer owned and maintained*	\$ 19.54
400 watt, Customer owned, maintained by City, Customer provides materials*	\$ 20.92
1000 watt, Customer owned and maintained*	\$ 47.89
1000 watt, Customer owned, maintained by City, Customer provides materials*	\$ 51.66

*No longer offered effective April 2017

Charges Due Before Installation:	Charge Per
	<u>Unit</u>
Additional 30' standard wooden pole	\$ 83.00
Additional 35' standard wooden pole	\$123.62
Additional bracket:	
6 foot	\$ 45.30
8 foot	\$ 73.00
12 foot	\$125.00
20 foot	\$154.33
Additional Down Guy	\$ 93.54
Additional Span Guy	\$125.22
Primary Extension (per foot)	Actual Cost
Underground Secondary Conductor (per foot)	\$ 1.17
Decorative Luminaries	Actual Cost
Decorative Poles	Actual Cost



CITY OF SHELBY

Natural Gas Base Rates* Effective 11/1/2016

Residential Facilities Charge	\$8.50 / month
Residential Base Rate	\$6.69 / Dekatherm
General Commercial and Industrial Facilities Charge	\$12.50 / month
General Commercial and Industrial Base Rate	\$ 5.30 / Dekatherm
High Load Factor Facilities Charge	\$60.00 / month
High Load Factor Base Rate	\$ 3.58 / Dekatherm
Interruptible Facilities Charge	\$60.00 / month
Interruptible Base Rate:	
First 1,500 MCF / month	\$2.08 per MCF
Next 1,500 MCF/ month	\$1.66 per MCF
Next 3,000 MCF / month	\$1.36 per MCF
Next 9,000 MCF/ month	\$1.12 per MCF
Over 15,000 MCF / month	\$0.92 per MCF
Industrial Firm Transportation Facilities Charge	\$500.00 / month
Industrial Firm Transportation Base Rate:	
First 50,000 dekatherms / month	\$.635 per Dekatherm
Next 25,000 dekatherms / month	\$.435 per Dekatherm
Next 25,000 dekatherms / month	\$.245 per Dekatherm
All over 100,000 dekatherms / month	\$.135 per Dekatherm

*Price does not include the actual cost of natural gas; this cost is passed on to the customer each month as prices change.



**SCHEDULE 41
Base Rate Effective 5/10/2013 Billing**

CITY OF SHELBY

RESIDENTIAL GAS SERVICE

AVAILABILITY

Gas Service under this rate is available for all residential purposes in individual residences and in individual units of multiple-family buildings located where City gas service is available.

CHARACTER OF SERVICE

Natural gas supplied under this schedule is sold on a firm basis only and shall be supplied through a single delivery point and be separately metered. Commingling of gas purchased under this schedule with gas purchased under other rate schedules is prohibited. All natural gas delivered under this rate is for the exclusive use of the customer and shall not be resold.

MEASUREMENT, BILLING AND PAYMENT

For measurement purposes, the volume of natural gas delivered under this rate schedule shall be measured in cubic foot units. Volumes of gas hereunder will be determined in accordance with the City’s measurement base. For billing purposes, the volume of natural gas billed under this rate schedule shall be billed by the hundred cubic foot units (CCF).

RATE

The City of Shelby Natural Gas System Rates shall be set forth on Sheet No. 40 in this tariff and are incorporated herein by reference. The customer’s total bill is calculated using the following components.

$$\text{Total Bill} = \text{FC} + (\text{U} \times \text{CR})$$

- FC = Monthly Facilities Charge
- U = Customer Monthly Usage in CCF
- CR = Total Commodity Rate for the current period in CCF

The Total Commodity Rate is adjusted for each billing period by adding the Base Commodity rate to the average incremental cost of gas supply for the current period. This value is computed on a per dekatherm basis and converted to a per hundred cubic feet basis using the current heating value content of the gas. The Total Commodity Rate will be calculated each billing cycle and set forth on Schedule 40. The base commodity rate is shown below.

	<u>Monthly Facilities Charge</u>	<u>Base Commodity Rate</u>
Residential	\$8.50	\$6.69/dekatherm



**SCHEDULE 42
Base Rate Effective 5/10/2013 Billing**

CITY OF SHELBY

GENERAL COMMERCIAL AND INDUSTRIAL GAS SERVICE

AVAILABILITY

Gas Service under this rate is available for all non residential customers where City gas service is available.

CHARACTER OF SERVICE

Natural gas supplied under this schedule is sold on a firm basis only and shall be supplied through a single delivery point and be separately metered. Commingling of gas purchased under this schedule with gas purchased under other rate schedules is prohibited. All natural gas delivered under this rate is for the exclusive use of the customer and shall not be resold.

MEASUREMENT, BILLING AND PAYMENT

For measurement purposes, the volume of natural gas delivered under this rate schedule shall be measured in cubic foot units. Volumes of gas hereunder will be determined in accordance with the City’s measurement base. For billing purposes, the volume of natural gas billed under this rate schedule shall be billed by the hundred cubic foot units (CCF).

RATE

The City of Shelby Natural Gas System Rates shall be set forth on Sheet No. 40 in this tariff and are incorporated herein by reference. The customer’s total bill is calculated using the following components.

$$\text{Total Bill} = \text{FC} + (\text{U} \times \text{CR})$$

- FC = Monthly Facilities Charge
- U = Customer Monthly Usage in CCF
- CR = Total Commodity Rate for the current period in CCF

The Total Commodity Rate is adjusted for each billing period by adding the Base Commodity rate to the average incremental cost of gas supply for the current period. This value is computed on a per dekatherm basis and converted to a per hundred cubic feet basis using the current heating value content of the gas. The Total Commodity Rate will be calculated each billing cycle and set forth on Schedule 40. The base commodity rate is shown below.

	<u>Monthly Facilities Charge</u>	<u>Base Commodity Rate</u>
General Commercial & Industrial Gas Service	\$12.50	\$5.30/dekatherm



SCHEDULE 43
Base Rate Effective 11/1/2016 Billing
Replaces rates effective 5/10/2013

CITY OF SHELBY

HIGH LOAD FACTOR GAS SERVICE

AVAILABILITY

Gas Service under this rate schedule is available to any eligible commercial or industrial consumer using natural gas principally for process stream generation, manufacturing purposes, or any other base-load application, where the use of gas for space heating is only incidental. This rate is not available to consumers whose use of gas during the month of least consumption is less than 50% of the use during the month of greatest consumption.

CHARACTER OF SERVICE

Natural gas supplied under this schedule is sold on a firm basis only and shall be supplied through a single delivery point and be separately metered. Commingling of gas purchased under this schedule with gas purchased under other rate schedules is prohibited. All natural gas delivered under this rate is for the exclusive use of the customer and shall not be resold.

MEASUREMENT, BILLING AND PAYMENT

For measurement purposes, the volume of natural gas delivered under this rate schedule shall be measured in cubic foot units. Volumes of gas hereunder will be determined in accordance with the City’s measurement base. For billing purposes, the volume of natural gas billed under this rate schedule shall be billed by the hundred cubic foot units (CCF).

RATE

The City of Shelby Natural Gas System Rates shall be set forth on Sheet No. 40 in this tariff and are incorporated herein by reference. The customer’s total bill is calculated using the following components.

$$\text{Total Bill} = \text{FC} + (\text{U} \times \text{CR})$$

- FC = Monthly Facilities Charge
- U = Customer Monthly Usage in CCF
- CR = Total Commodity Rate for the current period in CCF

The Total Commodity Rate is adjusted for each billing period by adding the Base Commodity rate to the average incremental cost of gas supply for the current period. This value is computed on a per dekatherm basis and converted to a per hundred cubic feet basis using the current heating value content of the gas. The Total Commodity Rate will be calculated each billing cycle and set forth on Schedule 40. The base commodity rate is shown below.

	<u>Monthly Facilities Charge</u>	<u>Base Commodity Rate</u>
High Load Factor Gas Service	\$60.00	\$3.58/dekatherm



SCHEDULE 44
Base Rate Effective 5/10/2013 Billing

CITY OF SHELBY

INTERRUPTIBLE GAS SERVICE
WITH OR WITHOUT PARTIAL FIRM REQUIREMENTS

AVAILABILITY

Gas service under this rate schedule is available by written contract to eligible large industrial consumers, whose use of gas is principally for process purposes, and where space heating is incidental only. This service is offered only to customers who average daily gas usage is reasonably anticipated to equal or exceed 50 dekatherms per day.

STANDBY ALTERNATE FUEL CAPACITY

Customers purchasing gas pursuant to this Rate Schedule shall maintain, in useable condition, alternate fuel facilities with ample on-site alternate fuel capability for supplying 100% of the establishment's gas requirements during periods of gas interruption or curtailment. Such interruption or curtailment shall be immediately effective upon verbal or written notification by the City and Customer shall refrain from using gas until permitted to do so by the City. It is understood and agreed that the City will have the right to suspend gas service without further notice to the Customer in the event the Customer fails to curtail Customer's use of gas in accordance with the City's notice of curtailment.

CHARACTER OF SERVICE

Natural gas supplied under this schedule is sold on an interruptible basis only and shall be supplied through a single delivery point and be separately metered. Commingling of gas purchased under this schedule with gas purchased under other rate schedules is prohibited. All natural gas delivered under this rate is for the exclusive use of the customer and shall not be resold.

MEASUREMENT, BILLING AND PAYMENT

For measurement purposes, the volume of natural gas delivered under this rate schedule shall be measured in cubic foot units. Volumes of gas hereunder will be determined in accordance with the City's measurement base. For billing purposes, the volume of natural gas billed under this rate schedule shall be billed by the hundred cubic foot units (CCF).

RATE

The City of Shelby Natural Gas System Rates shall be set forth on Sheet No. 40 in this tariff and are incorporated herein by reference. The customer's total bill is calculated using the following components.

$$\text{Total Bill} = \text{FC} + (\text{U} \times \text{CR})$$

- FC = Monthly Facilities Charge
- U = Customer Monthly Usage in CCF
- CR = Total Commodity Rate for the current period in CCF

The Total Commodity Rate is adjusted for each billing period by adding the Base Commodity rate to the average incremental cost of gas supply for the current period. This value is computed on a per dekatherm basis and converted to a per hundred cubic feet basis using the current heating value content of the gas. The Total Commodity Rate will be calculated each billing cycle and set forth on Schedule 40. The base commodity rate is shown below.

<u>Monthly Facilities Charge</u>		<u>Base Commodity Rate</u>	
Interruptible Industrial	\$60.00	First 1500 MCF/month	\$2.08/dekatherm
		Next 1500 MCF/month	\$1.66/dekatherm
		Next 3000 MCF/month	\$1.36/dekatherm
		Next 9000 MCF/month	\$1.12/dekatherm
		All volumes over 15,000 MCF/month	\$0.92/dekatherm

PROVISIONS:

1. Whenever curtailment or interruption of interruptible gas delivered hereunder is required, the City shall issue a curtailment order to consumer, specifying the quantity of gas to be curtailed and the time at which such curtailment is to be made.

When restoration of service is permissible, the City shall similarly issue a restoration order specifying the quantity of gas to be restored and the time at which such restoration is to be made. Consumer shall carry out all such orders at the time specified therein. A curtailment order shall be issued at least one hour in advance of its effective time.

2. In the event customer fails to discontinue the use of interruptible gas after one hour's notice that the interruptible gas under this schedule is not available, all gas so used shall be paid for by the consumer at a rate of \$55.00 per DT of maximum day use of such unauthorized gas, in addition to the regular commodity charge for such gas and any charges for firm gas.

3. When a customer is notified to curtail service, or while gas service is being curtailed, customer finds it impossible to continue operations on his standby fuel because some bona fide emergency and the City has gas available from some source other than its Contract Demand Service from Transcontinental Gas Pipe Line Corporation, the City may, at its discretion, furnish emergency gas service upon request from customer for such service. All emergency gas so used shall be paid for by the consumer at the rate of \$3.00 per dekatherm of gas plus the highest incremental gas commodity cost for gas purchased by the City in the current month. The City shall not be liable in any way to any customer for failure in whole and in part, temporary or permanent, to deliver emergency gas under this provision.



Effective July 1, 2014

CITY OF SHELBY

**NATURAL GAS INDUSTRIAL FIRM
TRANSPORTATION RATE SCHEDULE**

APPLICABLE

To any industrial class of customer that consumes more than 75,000 dekatherms a billing period and is located inside the city limits of Shelby, NC and is connected to the City of Shelby (City) natural gas system:

- A. To the extent that the City and Customer have adequate facilities and equipment available and in place for transporting and delivery of such volumes of gas;
- B. When a Customer has executed a Service Agreement with the City, wherein the City agrees to transport and deliver volumes of gas received for the Customer as specified therein.

CHARACTER OF SERVICE

Transportation of natural gas by the City under this rate schedule shall be on a firm basis.

MONTHLY RATE

	<u>Monthly Facilities Charge</u>		<u>Base Commodity Rate</u>
Industrial Transportation Rate	\$500.00	First 50,000 dekatherms	\$.635/dekatherm
		Next 25,000 dekatherms	\$.435/dekatherm
		Next 25,000 dekatherms	\$.245/dekatherm
		All over 100,000 dekatherms	\$.135/dekatherm

DETERMINATION OF DELIVERIES

The volumes of gas transported pursuant to this schedule shall be the volumes delivered to the City by the Customer at the point of delivery. Gas delivered hereunder shall be billed as the first gas through the Customer's meter each month.

BALANCING OF TRANSPORTATION VOLUMES

Receipts and deliveries of gas hereunder shall be at uniform rates of flow with no significant fluctuations or imbalances. Customers (or its Agent) are responsible to match daily gas deliveries into the City's system with daily gas consumption by Customer as closely as possible. Any imbalances shall be corrected by the Customer (or its Agent), insofar as practicable, during the

month in which they occur. Customers (or its Agent) are expected to proactively manage intra-month imbalances. Customer (or its Agent) may adjust its daily nominations during a month in order to correct any accumulated imbalance and maintain a monthly balance subject to the operating limitations of the City. The City reserves the right to limit the amount of such imbalances to avoid operating problems, comply with balancing requirements of the upstream pipeline(s), and to mitigate the need to acquire additional daily supply at prices that would adversely affect sales customers. The Customer (or its Agent) will be responsible for any imbalance charges assessed by upstream pipeline(s) in connection with any gas transported by the Customer under this Rate Schedule.

In the event Customer (or its Agent) fails to abide by the requirements set forth above, the City shall have the right to curtail deliveries to Customer if an imbalance is negative or reducing Customer's nominated quantities if an imbalance is positive. The Customer will be responsible for any imbalance charges assessed by upstream pipeline(s) in connection with any gas transported by the Customer. The City reserves the right to take other reasonable action to mitigate system operational problems. The City will use its reasonable efforts to notify the Customer or the Customer's Agent before proceeding with a unilateral nomination reduction or delivery curtailment and will notify Customer of any reduction to Customer's nomination that has been instituted by the City.

Any time the Customer is consistently using more or less gas than is being delivered to the City for the Customer's account, it shall be the Customer's responsibility to bring its supply and requirements into balance. Customers must balance within 5% of their monthly deliveries and within 10% of their daily deliveries in order to maintain the integrity of the system under normal operating conditions.

In instances where there is an over-deliver of supply, the City at its option, may cash-out this over-supply and purchase any or all of the excess volumes at a rate of 20 cents per dekatherm lower than its lowest cost of commodity supply that month.

In instances where there is an under-deliver of supply, the City at its option, may cash-out this under-supply and sell any or all of the deficit volumes to the Customer at a rate of 20 cents per dekatherm higher than the firm sales tariff rate for that month.

During an Operational Flow Order (OFO) on any upstream pipeline and in other situations where the City notifies the customer via email or by phone, Customers must balance within 5% of their daily deliveries to maintain the integrity of the system.

In instances where there is an over-deliver of supply during an OFO or other situation identified by the City, the City at its option, may cash-out this over-supply and purchase any or all of the excess volumes at a rate of 20 cents per dekatherm lower than its lowest cost of commodity supply for that day.

In instances where there is an under-deliver of supply during an OFO or other situation identified by the City, the City at its option, may cash-out this under-supply and sell any or all of the deficit volumes to the Customer at a rate of 20 cents per dekatherm higher than the highest cost of commodity supply for that day.

In addition, the Customer will also be charged imbalance penalties in instances where the City incurs imbalance or overrun penalties from the pipeline supplier due to overruns or under-deliveries. These charges will be based on a prorated share of the penalty attributed to the Customer.

LATE PAYMENT CHARGE

Unless bill is paid on or before ten (10) days after the due date as shown on bill, the account will be assessed late fees as outlined in the City's fee schedule.

SPECIAL PROVISIONS

1. The customer will operate within the guidelines required by Williams Transco Gas Pipeline (transporter). The Customer, or its agent, shall inform the City, or its agent, by 10:00 am of the working day prior to the day the gas is to be delivered, of the anticipated consumption level and the volume requested for delivery. At that time, the City, or its agent, shall inform the Customer of any restrictions on the volume requested for delivery.
2. The Customer, or its agent, is responsible for all of the necessary arrangements and notification for the scheduling of transportation on the pipeline.
3. The Customer must purchase the necessary software package provided by Williams Transco Gas Pipeline to make possible daily monitoring of gas flows.
4. Gas transported on this schedule shall be separately metered and shall not be used interchangeably with firm gas purchased on any schedule.
5. The term of the contract shall be for a term of not less than one year.
6. Customers must remain on this tariff schedule for a period of no less than 12 months before switching tariffs or service.

RECONNECTION CHARGE

There shall be a charge for reconnection of services terminated because of non-payment of bills in accordance with the City Code.



EFFECTIVE July 1, 2014

CITY OF SHELBY
LARGE INDUSTRIAL FIRM GAS SERVICE

AVAILABILITY

Gas service under this rate schedule is available to eligible large industrial consumers, whose use of gas is principally for process purposes, and where space heating is incidental only. This service is offered only to customers whose average daily gas usage is reasonably anticipated to equal or exceed 1000 dekatherms per day.

CHARACTER OF SERVICE

Natural gas supplied under this schedule is sold on a firm basis only and shall be supplied through a single delivery point and be separately metered. Commingling of gas purchased under this schedule with gas purchased under other rate schedules is prohibited. All natural gas delivered under this rate is for the exclusive use of the customer and shall not be resold.

Each year, the customer shall elect a Maximum Daily Quantity (MDQ) which represents the quantity of gas the City is obligated to provide on a firm basis. The customer shall elect a MDQ prior to August 1st of each year that will be utilized for the term of October 1 – September 30 following the MDQ election. The City must approve and accept the MDQ prior to the commencement of service. Once the City approval is granted, the service will be provided under this Rate Schedule through September 30th of the following year.

MEASUREMENT, BILLING AND PAYMENT

For measurement purposes, the volume of natural gas delivered under this rate schedule shall be measured in cubic foot units. Volumes of gas hereunder will be determined in accordance with the City's measurement base. For billing purposes, the volume of natural gas billed under this rate schedule shall be billed by the hundred cubic foot units (CCF).

RATE

The City of Shelby Natural Gas System Rates shall be set forth on Sheet No. 40 in this tariff and are incorporated herein by reference. The customer's total bill is calculated using the following components.

$$\text{Total Bill} = (\text{MDQ} \times \text{D}) + (\text{U} \times \text{CR})$$

- MDQ = Maximum Daily Quantity elected for term October 1 – September 30, Dt/day
- D = Monthly Demand Charge
- U = Customer Monthly Usage in CCF
- CR = Total Commodity Rate for the current period in CCF

The customer shall pay the Demand Charge component of the rate (MDQ x D) each month during the October 1- September 30 term regardless of the amount of gas purchased. In the event that the customer utilizes more gas on a daily basis, as measured and reported by the City's telemetering equipment, the MDQ will be adjusted upward to match the highest daily delivery measured for the remainder of the term October 1 – September 30.

The revision of the customer MDQ based on actual deliveries shall not create any right to service at a specified level. All changes to character and quantity of service shall be subject to the City's consent based on the evaluation of the capacity of the City's pipeline system and gas supply contracts.

The Monthly Demand Charge shall be equal to 100% of the weighted average of the monthly reservation charges paid by the City to Transco for firm transportation service (including applicable demand surcharges) for capacity to deliver gas to the City's gas system. The Monthly Demand Charge shall be computed using the following formula: Firm Sales Daily Reservation Rate x days in the Month = Monthly Demand Charge. The Firm Sales Daily Reservation Rate shall be computed based on the weighted average of the price paid by the City for telescoped capacity on Transco, utilizing the telescoped reservation charges and surcharges in effect from time to time and charged by Transco (currently 17%, Zone 1-5; 25%, Zone 2-5; and 58%, Zone 3-5).

The Total Commodity Rate is adjusted for each billing period by adding the Base Commodity Rate to the average incremental cost of gas supply for the current period. This value is computed on a per dekatherm basis and converted to a per hundred cubic feet basis using the current heating value content of the gas. The Total Commodity Rate will be calculated each billing cycle and set forth on Schedule 40. The base commodity rate is shown below.

Base Commodity Rate

Large Industrial Firm Gas Service	All Volumes	\$.85/dekatherm
-----------------------------------	-------------	-----------------

NOTIFICATION OF MONTHLY AND DAILY USE

The Customer must notify the City on or before the fifth business day prior to each month and provide an estimate of the gas to be used each month. The Customer must not exceed the MDQ on any day, without written permission from the City. Any volumes exceeding the MDQ without permission from the City are hereby defined as Unauthorized Over-Run Volumes. The City reserves the right to curtail any Unauthorized Over-Run Volumes. The Customer shall be liable for any incremental charges or assessments (including, but not limited to penalties) by the upstream interstate pipeline during the time of the unauthorized usage by such Customer. The Customer shall also be billed any difference between the City's average incremental commodity cost for the month and the maximum daily commodity cost incurred for any Unauthorized Over-Run Volumes. The payment of a penalty for Unauthorized Over-Run volumes shall not under any circumstances be considered as giving any such Customer the right to take Unauthorized Over-Run volumes, nor shall such payment be considered as a substitute for any other remedies available to the City.

During an Operational Flow Order (OFO) on any upstream pipeline and in other situations where the City notifies the customer via email or by phone, the Customer must provide daily estimates of their daily anticipated use. The Customer must also keep their usage to within 5% of their daily estimated volumes to maintain the integrity of the system.

In instances where the Customer uses more than 5% of their estimated volumes during OFO or other situations where the City has notified the customer to estimate daily volumes, the City at its option, may invoice the Customer for actual gas supply commodity costs plus penalties in lieu of the average incremental cost of gas supply for the current period for the volumes over 5% of the Customer's estimated daily volumes for the cost gas supply for that day.

LATE PAYMENT CHARGE

Unless bill is paid on or before ten (10) days after the due date as shown on bill, the account will be assessed late fees as outlined in the City's fee schedule.



Natural Gas Residential Incentives

Revised 7/10/2010

Existing Customer*

Water Heater Rebate	\$150 1 st ; \$100 2nd water heater
Primary Heat Rebate	\$200 1 st ; \$100 2nd furnace
Range Rebate	\$50 for range
Dryer Rebate	\$50 for dryer

*Customer already has gas service installed-incentives only to replace appliances not on gas.

New Customer

Service Line	\$5.00 per foot
Water Heater Rebate	\$150 1 st ; \$100 2nd water heater + up to 75' free service line
Primary Heat Rebate	\$200 1 st ; \$100 2nd furnace + up to 100' free service line
Range Rebate	\$50
Dryer Rebate	\$50

Builder/Developer/New Construction

Service Line Cost	\$5.00/foot
Piping Allowance**	\$400.00*** and up to 175' free service line

**Requires participation in the "2 + Piping" program OR the "2 + 1" program.

2 + Piping Program

The "2 + Piping" program requires installation of natural gas primary heat AND a natural gas water heater PLUS piping to a range, dryer and one other appliance. The piping must be stubbed out through the floor of the building.

2 + 1 Program

The "2 + 1" program requires installation of natural gas primary heat, AND a natural gas water heater PLUS one other natural gas appliance. (Other combinations of appliances may apply in the "2 + 1" program with written approval from the Utilities Director)

***If additional water heaters or furnaces are installed an additional \$100 rebate per unit will be added to this.



Natural Gas Commercial and Industrial Incentives

Revised 7/10/2010

Commercial Incentives

If the Annual Load is:	The rebate is:
Less than 25 dt	\$150
Up to 50 dt	\$350
Up to 75 dt	\$500
Up to 100 dt	\$1,000
Up to 150 dt	\$2,000
Over 150 dt	\$2,500

The load will be based on a review of the proposed appliances added and will be at the sole discretion of the City.

Industrial Incentives

Will continue to review industrial loads on a case-by-case basis.



Stormwater Utility Fee

Rates effective 7/1/2018

Replaces rates effective 7/1/14

<u>Type</u>	<u>Monthly Fee</u>
Residential	\$2.50
Commercial	
1 – 2 ERU	\$5.00
3 – 5 ERU	\$10.00
6 – 10 ERU	\$15.00
11 – 25 ERU	\$25.00
26 – 50 ERU	\$75.00
51 – 100 ERU	\$150.00
101 – 199 ERU	\$300.00
200 – 500 ERU	\$600.00
501 – 999 ERU	\$1,200.00
1000+ ERU	\$2,000.00

- Residential fees apply to a single dwelling on one parcel
- Commercial fees apply to any developed parcel that is not defined as residential (e.g. multifamily, office, institutional, commercial, industrial, etc.)
- Parcels with less than 400 square feet of impervious surfaces are not subject to a stormwater fee.

One Equivalent Residential Unit (ERU) is equal to 2,600 square feet of impervious area.



Stormwater Utility Fee Credit Program

The City of Shelby Stormwater Fee Credit program offers commercial property owners the opportunity to reduce their stormwater utility fee charges by applying for available fee credits. The fee credits described below are cumulative and a stormwater fees may be reduced as much as thirty (30) percent based on the following three credit categories:

- **Water Quality (10% credit)** – Properties qualifying for this fee credit shall provide an onsite Best Management Practice (BMP) that reduces the impact of pollution on water quality and conforms with the design and maintenance standards in the City of Shelby’s Phase II Stormwater Ordinance and the NCDENR BMP Manual (minimum 85% TSS removal). The required water quality analysis is to be prepared and sealed by an engineer registered in the State of North Carolina.

- **Water Quantity (10% credit)** – Properties qualifying for this fee credit shall provide a post developed rate of runoff that is less than or equal to the runoff rates at pre-development. Properties that reduce their peak discharge rate to pre-developed conditions are eligible to receive a stormwater runoff control credit. If site conditions do not allow for a complete reduction to the pre-developed peak discharge rate, the credit will be determined proportionally based on the amount of reduction attained (i.e., if the developed peak discharge is reduced by 70 percent of the differential runoff, then the corresponding credit would be $0.70 \times 10\% = 7\%$). Runoff rate analysis is to be based on a 10-year storm event with supporting calculations prepared and sealed by an engineer registered in the State of North Carolina.

- **Industrial Stormwater Permit (10% credit)** – An industrial property that is covered by an individual or general National Pollution Discharge Elimination System (NPDES) stormwater discharge permit is eligible for this credit if all requirements of the aforementioned permit are satisfied. An annual inspection report must be provided to the City to verify compliance and receive this fee credit.

City of Shelby
Agenda Item Summary
June 4, 2018
City Hall Council Chamber

D. Consent Agenda:

Prior to approval and adoption of the agenda, a Council Member may move an item from the Consent Agenda to the regular agenda. Items remaining on the Consent Agenda will be considered collectively through a single motion, second, and vote.

Agenda Item: D-1

- 1) Approval of the Minutes of the Regular Meeting of May 14, 2018

Consent Agenda Item: (Bernadette Parduski, City Clerk)

Summary of Available Information:

Please read and offer changes as you deem necessary.

- Minutes of the Regular Meeting of May 14, 2018

City Manager's Recommendation / Comments

Approve the minutes as presented or as amended by the Mayor and City Council via the Consent Agenda.

MINUTES

Regular Meeting
City Hall Council Chamber

May 14, 2018
Monday, 6:00 p.m.

Present: Mayor O. Stanhope Anthony III, presiding; Council Members Eric B. Hendrick, David W. White, David Causby, Violet Arth Dukes, Ben Kittrell, Jr., and Dicky Amaya; City Manager Rick Howell, ICMA-CM, City Clerk Bernadette A. Parduski, NCCMC, MMC, City Attorney Lacey Beam, Director of Finance Justin S. Merritt, MPA, Assistant Director of Finance Elizabeth B. (Beth) Beam, CPA, Director of Human Resources Deborah C. (Deb) Jolly, Director of Energy Services Julie R. McMurry, Director of Water Resources David W. Hux, Director of Engineering Services Benjamin (Ben) Yarboro, Police Chief Jeffrey H. (Jeff) Ledford, Assistant Fire Chief – Logistics and Enforcement Services Todd McMurry, Director of Public Works Daniel C. (Danny) Darst, Jr., Director of Parks and Recreation Charlie Holtzclaw, Director of Planning and Development Services Walter (Walt) Scharer, AICP; and Bill Harrelson of Cleveland Community College and C19TV

Mayor Anthony called the meeting to order at 6:00 p.m. and welcomed all who were in attendance. The Mayor called for a moment of silence in honor of National Police Week, May 13 through May 19, 2018 which includes Peace Officers Memorial Day on May 15, 2018. He gave the invocation and Mrs. Arth Dukes led the *Pledge of Allegiance*.

A. Approval of agenda:

- 1) Motion to adopt the proposed agenda

ACTION TAKEN: Upon a motion made by Mr. Amaya, City Council voted unanimously to approve the agenda as presented.

B. Special Presentations:

- 1) Earl Scruggs Center update – Emily Epley, Executive Director

Since opening its doors in 2014, Mrs. Epley said the Center has hosted visitors from all 50 states and 18 countries. She added 30 to 35 states and 6 to 8 countries are represented each year at the Center.

Mrs. Epley noted the City's wayfinding signs continue to be most helpful in directing visitors to the Earl Scruggs Center as well as to the Uptown Shelby

area. She mentioned banners were installed at the Center's Washington Street entrance in January 2018 and serve to inform the public of its location and to enhance the historic courthouse building. The cost of these banners were donated by two sponsors.

Next, Mrs. Epley stated two articles about the Center were recently featured in Southern Living magazine and Down the Road, the magazine of the Blue Ridge music trails.

Mrs. Epley added through a partnership with the World Equestrian Games Volunteer Program at the Tryon International Equestrian Center, the Earl Scruggs Center is offering complimentary admissions to all those volunteers of this major international championship event to be held in Tryon, North Carolina in September 2018.

As the Center is entering its fifth year of operation, Mrs. Epley was pleased to secure significant State grant funding to assist with their strategic planning process and to ensure long-term, future success.

During this past year, Mrs. Epley stated continued emphasis and focus was placed on building the Center's motor coach business and facility rentals in an effort to showcase Shelby as a destination and to increase overnight accommodations by visitors. She added the Center welcomed a group from Capitol Tours of West Columbia, South Carolina and planned a one-day itinerary. This was very well received and has the potential to generate additional tour groups from the feedback and inquiries obtained.

Mrs. Epley stated the Center presents two special exhibits each year. The "David Holt: Photos, Music and Stories" exhibit was on display from July 2017 through January 2018. Currently on display is "Home Plate Don't Move: Baseball and Community", featuring interactive components that integrate history, geography, and STEM (science, technology, engineering, and mathematics) education with a multi-sensory approach to baseball and the region.

Mrs. Epley stated the Center continues to present quality programming which includes a diverse range of programs such as the Lunch-N-Learn series, the Pickin' on the Square series, and this year, Books & Baseball for children.

Lastly, Mrs. Epley announced the 9th Annual Rhythm & Roots 5K Walk/Run and 10K Run will take place on October 13, 2018.

Council received the information. No action was required.

2) City Park Royster Memorial Golf Course Alternative Use Study and Plan – Andrew Pack, Wayne Robinson, and Marc Meddaugh, Woolpert North Carolina PLLC

Mr. Howell introduced the subject matter of the presentation by stating Woolpert North Carolina, LLC, a multi-discipline design firm specializing in park and recreation facilities, was contracted by the City of Shelby to conduct an alternative use study and to develop the Alternative Use Master Plan for the golf course land within the City Park property. He also referenced Resolution No. 14-2017 directing him to develop an operations improvement plan intended to increase play and revenue at the golf course and to identify viable future alternative recreational uses for the golf course property by providing opportunities for public input by December 2017.

Mr. Holtzclaw began the introductions by mentioning Woolpert has been involved in the City’s recreational projects over many years including the previous City Park Recreation and Sports Complex (2011) and the current Hanna Property Multi-purpose Recreation Complex (2018). He introduced the presenters as Andrew Pack, Wayne Robinson, and Marc Meddaugh.

Next, Mr. Pack provided an overview of the presentation covering the why, the what, and the how of the alternative use study. He then stated the purpose of the presentation is to inform City Council and the public of the results of the community engagement process and to review the Alternative Use Master Plan.

As directed by City Council and City staff, Mr. Robinson stated Woolpert’s study included multiple levels of community engagement activities to gain an understanding of what the local community feels is the best alternative uses for the golf course property.

He explained the steps Woolpert performed in the Alternative Use Study as follows:

- **Review of the overall park and facility including all property and uses**
- **Review of current park and recreation needs**
- **Identify stakeholders within the community**
 - **Residents**
 - **Sports and outdoors**
 - **Parks and Recreation Advisory Board**
 - **Keep Shelby Beautiful Commission**
 - **Volunteer**
 - **Youth and high school**
 - **Travel and tourism**

- **Community engagement – can include workshops, focus groups, public meetings, and survey**
 - **Workshops – The public workshops included multiple stations asking specific questions and a written survey**
 - ❖ **Most and least used activities at City Park**
 - ❖ **Priority of improving or adding current and new activities at City Park**
 - ❖ **Special events that could be held at City Park**
 - ❖ **Active or passive recreation options at City Park**
 - **Focus groups**
 - ❖ **Sports and outdoors**
 - ❖ **Parks and Recreation Advisory Board/Keep Shelby Beautiful Commission**
 - ❖ **Volunteer**
 - ❖ **High school**
 - ❖ **Travel and tourism**
 - **Online survey**
 - ❖ **The online survey asked the same questions as the public workshops**

Mr. Robinson reviewed and discussed the online survey results as follows:

- **Activities and programs participated in regularly: Swimming, walking/jogging, and special events**
- **Survey participants gender ratio: 60 percent female and 40 percent male**
- **Population living within Cleveland County: 92 percent to 8 percent**
- **Population living with Shelby City Limits: 53 percent to 47 percent**
- **Participated in recreation programs at Shelby City Park: 79 percent**
- **Survey participants age range: 35-44 years, 26 percent and 45-54 years, 22 percent**
- **Recreational facilities used at City Park in the past two years: Carrousel, miniature train track, playgrounds, and walking trails.**

Mr. Robinson reviewed and discussed the workshop results as follows:

- **Activities and programs the public would like to have at City Park: Golf training facility, dog park, and greenway trail connection**

- **Most used park elements:** Golf course, baseball/softball, and walking trails
- **Least used park elements:** Horseshoe pits, baseball/softball, and golf course
- **Special events people would likely attend:** Concert venue/music festival, Special Olympics/Senior games, and food truck festivals
- **Priority park elements:** Active recreation – 33 percent; passive recreation – 13 percent; and special events – 10 percent
- **Preferred active recreation replacements for golf course:** Bicycle trails – 25 percent; jogging trails – 12 percent; and BMX bicycle pump track – 11 percent
- **Preferred alternative golf course uses:** Bicycle trails – 27 percent; Amphitheater – 18 percent; Walking and hiking trails – 12 percent; Campground and disc golf course tied at 9 percent

Mr. Robinson went over the existing program elements at City Park as follows:

- **Community Center**
- **Aquatic Center**
- **Royster Golf Course**
- **Tennis courts**
- **Miniature train track**
- **Playground inside train track**
- **Carrousel**
- **Picnic area**
- **Baseball/softball fields**
- **Playground by baseball field**
- **Horseshoe pits**
- **Thompson Garden**
- **Walking trails**

Mr. Robinson presented Woolpert's conceptual master plan for City Park depicting existing and new elements as follows:

Existing:

- **Community Center**
- **Aquatic Center**

- Thompson Garden
- Tennis courts
- Train track
- Playground
- Carrousel
- Ball fields
- Maintenance facility
- Girl Scouts building
- Parking lot

New:

- Ball fields
- Community garden and public orchard
- Disc golf course
- Walking and biking trails
- Fitness park
- Dog park
- Open green space and music festival space
- Picnic facilities
- Sidewalk
- Greenway trail connection
- Ropes course
- Bicycle pump track
- Community building and restrooms
- Picnic pavilion
- Parking lot

Discussion followed and concluded with Mr. Robinson stating, in general terms, the game of golf follows the market, noting there is a downward trend in municipal golf courses due to the return on investment and maintenance costs.

Mr. Hendrick requested a Council consensus to direct City staff to develop a three-year plan to implement the Conceptual Master Plan presented by Woolpert at City Council's 2019 retreat.

Mr. Hendrick made a motion to close the Royster Memorial Golf Course on June 1, 2018 and to immediately re-open it to foot traffic and to develop a plan to allow mountain bikes.

The vote was delayed to later in the meeting until Mr. Howell presented his budget message.

Council received the information. No action was taken at this time.

C. Public Comment:

Jamie Coulter who resides at 401 Edgewood Road in Shelby, North Carolina spoke against the closing of Royster Memorial Golf Course, urging City Council to study the matter longer before making any decision.

D. Public Hearing:

- 1) Consideration of a proposed ordinance amending the zoning map of the City of Shelby, North Carolina: Ordinance No. 23-2018

Mr. Scharer introduced this proposed zoning map amendment for the property located at 818 North Post Road from General Business (GB) District to General Business (GB) District and Light Industrial (LI) District as submitted by the applicant, Spencer Borders. Utilizing both location and zoning maps, he pointed to the subject property located near the Hurst Jaws of Life plant and facility on North Post Road. Land uses and zoning in the area vary.

Mr. Scharer stated the applicant wishes to rezone the rear of this property to LI due its current industrial character. The front of the property will remain GB and will cater to GB uses. This site will be adjacent to the new US 74 Bypass currently under construction. The rear of the property will have frontage on the new bypass. He utilized constructions plans to denote the location of the new bypass in relation to this site. Mr. Scharer pointed to the edge of the right-of-way as marked on the subject property.

Mr. Scharer further stated the Comprehensive Land Use Plan (2009) for this area designates the site as Conservation Development. This designation was given to the area in an effort to preserve the corridor of the new 74 Bypass which is now under construction. Therefore, this zoning map amendment is inconsistent with the current Comprehensive Land Use Plan. However, this area will be reviewed with the new Small Area Plan for the Highway 150 Interchange associated with the new bypass and will likely have its future land use designation changed upon completion of that plan.

Mr. Scharer concluded by stating the Planning and Zoning Board recommended approval of this proposed zoning amendment.

Mayor Anthony opened the public hearing at 6:55 p.m. and invited comments from the public.

The public offered no comments and Mayor Anthony closed the public hearing at 6:56 p.m.

ACTION TAKEN: Upon a motion made by Mr. Amaya, City Council voted 5 (Hendrick, Causby, Arth Dukes, Kittrell, and Amaya) to 1 (White) to deny Ordinance No. 23-2018 entitled, "A PROPOSED ORDINANCE AMENDING THE ZONING MAP OF THE CITY OF SHELBY, NORTH CAROLINA".

E. Consent Agenda:

ACTION TAKEN: Mayor Anthony presented the consent agenda. Mr. White made a motion to approve the consent agenda. The consent agenda and following items were unanimously approved:

- 1) Approval of the Minutes of the Regular Meeting of April 16, 2018
- 2) Approval of the Minutes of the Special Meeting of April 20, 2018
- 3) Approval of the Minutes of the Special Meeting of April 27, 2018
- 4) Approval of a resolution authorizing the City of Shelby to engage in electronic payments as defined by North Carolina General Statute 159-28: Resolution No. 22-2018
- 5) Adoption of a budget ordinance amendment for the City of Shelby's Grover Morgan Waterline Project: Ordinance No. 24-2018
- 6) Adoption of a budget ordinance amendment for the City of Shelby's East Gateway Enhancement Project: Ordinance No. 25-2018
- 7) Adoption of Fiscal Year (FY) 2017-2018 Budget Ordinance Amendment No. 17: Ordinance No. 26-2018
- 8) Adoption of Fiscal Year (FY) 2017-2018 Budget Ordinance Amendment No. 18: Ordinance No. 27-2018
- 9) Adoption of an ordinance authorizing demolition of a dwelling (615 Smith Street): Ordinance No. 28-2018
- 10) Adoption of an ordinance authorizing demolition of a dwelling (1119 North Lafayette Street): Ordinance No. 29-2018
- 11) Approval of a resolution awarding the contract for the City of Shelby Fiscal Year (FY) 2017-2018 Street Resurfacing Program: Resolution No. 23-2018

- 12) Adoption of a budget ordinance amendment for the Shelby-Cleveland County Regional Airport Runway Overlay Project: Ordinance No. 30-2018

END CONSENT AGENDA

F. Unfinished Business:

- 1) Presentation of the City Manager's Fiscal Year (FY) 2018-2019 Budget Message and Proposed Annual Operating Budget for the City of Shelby

Mr. Howell provided a synopsis of his budget message dated May 14, 2018, stating the budget is balanced and meets all the applicable requirements of the North Carolina Local Government Budget and Fiscal Control Act. The following information contains his final recommendations for the budget beginning July 1, 2018 through June 30, 2019. These recommendations are impacted by a thorough process taking into account department requests, management evaluation of those requests as well as informed dialog between management and the departments. The process also took into account guidance and recommendations from the Mayor and City Council as provided during the annual retreat and two budget sessions.

Mr. Howell summarized the following:

- The City's budget includes eight (8) major governmental and enterprise funds: General, Electric, Natural Gas, Water, Sewer, Powell Bill (Streets), Public Housing, and Stormwater. These funds are set up for fiscal and accounting purposes with a self-balancing set of accounts for the purpose of carrying out specific activities or attaining certain objectives.
- The overall budget of \$76,576,530 is a 1.88 percent net increase (\$1,416,112) from the current fiscal year adopted budget of \$75,160,418.
- With regard to property tax, this revenue source is shown to increase by \$2,035,800 over last fiscal year. The voluntary annexation of the Clearwater Paper facility last year was not reflected in the property tax line but rather appeared in the Unrestricted Intergovernmental Revenue line item. At that time it was not known if the annexation would be complete in time and subsequently the company had agreed to pay a fee in lieu of taxes. This amounts to \$1,100,000 of the increase. With regard to Unrestricted Intergovernmental Revenue, this revenue source was reduced by approximately \$1,000,000. Again, this

reflects that fact that the voluntary annexation of the current Clearwater Paper facility was shown as a fee in lieu of taxes in the previous fiscal year.

- The current assessed valuation is set at \$2,021,700,000 by the Cleveland County Tax Administrator with the collection rate expected to be 98.18 percent at the June 30 close of the fiscal year.
- The tax rate is adjusted upward from 49.72 cents to 53 cents per \$100 valuation. This tax rate increase will generate approximately \$650,000 in new property tax revenue. The City did see some tax base growth which accounts for the additional \$285,000 in collections expected this year.
- The Local Option Sales Tax is shown to increase approximately \$500,000 in Fiscal Year 2018-2019. Growth for the coming year is expected to increase as well. The City's percentage of the Local Option Sales Taxes coming back to Cleveland County from the North Carolina Department of Revenue is currently 11.51 percent, up from 10.94 percent the year before.
- Reflected under Sales and Services are revenues generated from fees charged to customers for services rendered. The most significant of these is the Solid Waste Collection fee. It is expected that this revenue will increase approximately \$312,000 due to a monthly \$3.00 increase for this service on once per week residential customers. Fee increases for commercial customers collected more often are proportionately increased.
- It is recommended that the tax rate increase to 53 cents per \$100 of valuation is primarily to provide additional revenue to implement the market-based pay plan recently completed by the City. Implementation of the Pay and Classification Market Study is the top priority. The total cost for all funds is approximately \$1,900,000 when the calculation of benefits is included. Of this, \$1,300,000 will impact the General Fund and 75 percent of this is directed toward public safety positions based upon the market data.
- The total number of fulltime employees increases from 329 to 333 with the addition of four new park personnel for the new Hanna Park. The total annual operations cost for Hanna Park is estimated at \$280,000, including the four new positions.

- The Natural Gas and Electric rates will remain unchanged for all City customers.
- Base Water and Sewer Facilities charges will increase \$2.50 per month for all inside City residential customers and will proportionately increase \$4.72 per month for all outside City customers.

Lastly, all budget documents will be posted on the City's website for public viewing by May 18, 2018. The public hearing on the proposed budget will be advertised and conducted at the meeting of June 4, 2018.

G. New Business: None

H. City Manager's Report:

- 1) Mr. Howell informed Council the Shelby Cleveland County Regional Airport T-Hangar Construction Project is on the North Carolina Board of Transportation June Project List for approval.
- 2) Mr. Howell will provide a report to Council with regard to the unsewered areas within the City in the near future.
- 3) Mr. Howell mentioned a City ordinance prohibiting the excessive noise due to engine compression brakes referred to as "Jake" brakes in residential areas is forthcoming.
- 4) Mr. Howell stated he has recently met with the designer of the proposed East Gateway signage and received preliminary information related to the project.
- 5) With regard to the Uptown Water and Sewer Project, Mr. Howell reported the contractor has moved to the next section located on Washington Street between Marion Street and Warren Street. Ongoing communications continue with all parties involved and affected by the construction activities.

I. Council Announcements and Remarks:

- 1) Mayor Anthony made the following announcements and urged Council members to attend:
 - Shelby State of the Community Breakfast – May 17, 2018 at 7:30 a.m., Don Gibson Theatre
 - Law Enforcement Memorial Service – May 18, 2018 at 11:00 a.m.,

Raper-Roark Plaza

ACTION TAKEN: Upon a motion made by Mr. Hendrick to close the Royster Memorial Golf Course on June 1, 2018 and to immediately re-open it to foot traffic, City Council voted 3 (White, Causby, and Arth Dukes) to 3 (Hendrick, Kittrell, and Amaya). Mayor Anthony explained his position not to vote to break the tie. The motion was defeated.

Discussion followed and the key points included: Avoiding a premature decision, the golf course is not utilized enough to justify the expense, cost to taxpayers, subsidizing each golfer several thousand dollars, the study and master plan require further review, and the matter can be reconsidered at a future date.

J. Closed Session:

- 1) To approve the Minutes and General Account of the Closed Session of March 5, 2018
- 2) To discuss matters relating to the location or expansion of industries or other businesses in the area served by the City Council, including agreement on a tentative list of economic development incentives that may be offered pursuant to North Carolina General Statute 143-318.11 (a) (4)
- 3) To establish or instruct staff concerning the position to be taken by or on behalf of City Council in negotiating the price and other material terms of a contract or proposed contract for the acquisition of real property by purchase, option, exchange, or lease pursuant to North Carolina General Statute 143-318.11 (a) (5)

ACTION TAKEN: Mr. Amaya made a motion to enter into a closed session pursuant to the appropriate North Carolina General Statutes as cited. Mayor Anthony consulted with Miss Beam who advised the topics met the statutory requirements for a closed session. The Mayor invited all Council members present along with Mr. Howell, Miss Beam, Mr. Merritt, and Mrs. Parduski to attend. The motion passed unanimously and Council moved into closed session at 7:50 p.m.

Council returned to the regular session at 8:16 p.m.

K. Adjournment:

- 1) Motion to adjourn

ACTION TAKEN: Upon a motion made by Mr. White, City Council voted unanimously to adjourn the meeting at 8:17 p.m.

Respectfully submitted,

Bernadette A. Parduski, NCCMC, MMC
City Clerk

O. Stanhope Anthony III
Mayor

Minutes of May 14, 2018

DRAFT

City of Shelby
Agenda Item Summary
June 4, 2018
City Hall Council Chamber

Agenda Item: D-2

2) Approval of Special Event Permit Applications:

- a. 7th Inning Stretch Festival, 5K, and Little Miss American Legion World Series, requested date: August 11, 2018
- b. Host City Welcome, requested date: August 15, 2018

Consent Agenda Item: (Staff Resource, Bernadette A. Parduski, City Clerk)

Summary of Available Information:

- Memorandum dated May 29, 2018 from Bernadette A. Parduski, City Clerk to Rick Howell, City Manager
- Memorandums dated February 1, 2018 from Bernadette A. Parduski, City Clerk to Police Chief Jeff Ledford, Fire Chief William Hunt, Assistant Fire Chief Todd McMurry, Parks and Recreation Director Charlie Holtzclaw, Public Works Director Danny Darst, Assistant Director Public Works Scott Black, Director of Energy Services Julie McMurry, Electric Superintendent Jeff Freeman, Director of Water Resources David Hux, Planning and Development Services Director Walt Scharer, and Director of Engineering Services Ben Yarboro
- Special Event Permit Applications

City Manager's Recommendation / Comments

These events are in keeping with special event practices of the City. It is my recommendation that this item be approved by City Council at this time via the Consent Agenda.

Memo

To: Rick Howell, City Manager
From: Bernadette A. Parduski, City Clerk
Date: May 29, 2018
Re: Special Event Permit Applicationd

BACKGROUND:

Special Event Permit Applications have been submitted for the following:

- ✓ 7th Inning Stretch Festival, requested date: August 11, 2018
- ✓ Host City Welcome, requested date: August 15, 2018

REVIEW:

All responding City departments have received, reviewed, and approved the referenced applications.

RECOMMENDATION:

Please place the attached Special Event Permit Applications on the Consent Agenda of June 4, 2018 for Council's review and approval.

ATTACHMENTS:

- A. Special Event Permit Application packet received January 25, 2018
- B. Special Event Permit Application packet received January 25, 2018

Memo

To: Police Chief Jeff Ledford, Fire Chief William Hunt, Assistant Fire Chief Todd McMurry, Parks & Recreation Director Charlie Holtzclaw, Public Works Director Danny Darst, Assistant Director of Public Works Scott Black, Director of Energy Services Julie McMurry, Electric Superintendent Jeff Freeman, Director of Water Resources David Hux, Director of Engineering Services Ben Yarboro, and Planning and Development Services Director Walt Scharer

From: Bernadette A. Parduski, City Clerk

CC: Rick Howell, City Manager

Date: February 1, 2018

Re: Special Event Permit Application

All:

Attached you will find a Special Event Permit Application submitted by Kim Davis of Dragonfly Marketing on behalf of the American Legion World Series office as follows:

- ✓ 7th Inning Stretch Festival, 5K, and Little Miss American Legion World Series, requested date: August 11, 2018

Please carefully review the details of this application as it pertains to your department, and let me know of any anticipated problems/objections that you would like to bring to the attention of the City Council. If there are none, please let me know that as well. The event will be considered by City Council at the February 19, 2018 meeting and recommended for approval unless you advise otherwise. If I do not hear from you by February 12, 2018, it will be assumed that you are in agreement with the application as presented.

As always, thanks for your attention and consideration.

Attachment

**CITY OF SHELBY
SPECIAL EVENT PERMIT APPLICATION**

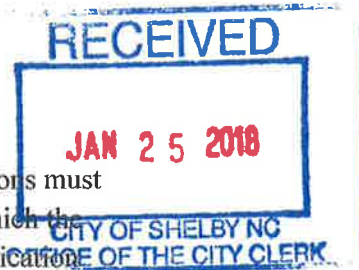

Each question must be legible and answered clearly and completely. Applications must be filed with the City Clerk not less than three (3) weeks before the date on which the event is to take place. A fee of \$20.00 will be due upon submission of the application form.

1. **EVENT NAME:** 7th Inning Stretch Festival, 5K and Little Miss American Legion World Series

2. PURPOSE AND BRIEF DESCRIPTION OF EVENT:

This festival is held to celebrate the hard work of Cleveland County. Local sponsors provide funding for the event.

3. **LOCATION OF EVENT (ATTACH MAP):** (1) Washington from south of Marion to S. of Warren intersection, (2) Warren E. of Washington to E. Trade St. and Lafayette from N. side of Graham to S. side of Marion

Route for 5 K is attached.

Little Miss American Legion World Series will be inside an Uptown facility this year.

4. PLEASE INDICATE:

Approximately how many people will attend the event: 18,000 to 22,0000

Approximately how many vehicles will be present: No vehicles will be permitted (unless on display for the event) on the streets closed for the festival.

Approximately how many animals will be present: only those brought in by attendees

If the event is a parade, please indicate the amount of street that will be needed:

Single lane _____

All lanes in travel direction _____

Whole street _____

5. PLEASE LIST THE FOLLOWING PARTY (IES) RESPONSIBLE FOR THE EVENT:

Name: Dragonfly Marketing (Kim Davis)

Address: 5 E. Marion St. Suite 2, Shelby NC 28150

Phones: 704-600-6599 (Daytime) 704-473-8248(Evening)

Email Address: kim@dragonflymarketing.cc

Name: ALWS
Address: 117-A W. Warren St., Shelby NC 28150
Phones: 704-466-3103 (Daytime)
Email Address: Robby@bcgroupinc.com

6. PLEASE LIST THE FOLLOWING:

Requested day(s) and date(s): August 11th
Alternate day(s) and date(s): _____
Requested hours of operation, from 7:00 AM to 10:00 PM
Need Road Closure at 12:01 am to set up stage.

7. SANITATION: Below states the "Plan for Clean-Up." Please check Application Instruction sheet for details.

Use the permanent trash cans in the festival area. Request additional trash cans to be delivered the day before the event. Request city sanitation department to pick up trash and clear streets after 10:00PM the day of the festival.

8. AVAILABILITY OF FOOD, BEVERAGES, AND/OR ENTERTAINMENT;

If there will be music, sound amplification, or any other noise impact, please describe on attached sheet, including the intended hours of the music, sound, or noise.

Little Miss American Legion World Series with sound from 10:00am – 3:00 pm
Music with sound systems from 3:00PM to 10:00 PM.

Will alcoholic beverages be served? No

If yes, attach to the application a copy of your permit from the Cleveland County Alcoholic beverage Control Board. Alcohol may not be served without a permit!!!

Will food and/or non-alcoholic beverages be served? Yes, all food vendors will supply their health department permits.

If yes, attach to the application a copy of your permit from the Cleveland County Department of Health Services.

9. SECURITY AND SAFETY PROCEDURES:

Attach to this application a copy of your building permit(s) if you are installing any electrical wiring on a temporary or permanent basis and/or if you are building any temporary or permanent structures such as bleachers, scaffolding, a grandstand, viewing stands, stages, or platforms. Attach a copy of your Shelby Fire Department Permit or permits to this application if you will use parade floats; an open flame; fireworks; or pyrotechnics; vehicle fuel; cooking facilities; enclosures (and tables within those enclosures); tents; air supported structures; and/or any fabric shelter.

Give name, address, and phone numbers of the agency or agencies, which will provide first aid staff and equipment. Attach additional sheets if necessary.

Dragonfly Marketing will meet with Cleveland County EMS and they will have assigned responders to come in from around the festival areas to ensure quick access for services and if needed set up a command center within the festival area to provide on-site first responder services.

Name: Cleveland County EMS
Address: 100 Justice Place, Shelby, NC 28150
Phones: 704-484-4984

Indicate medical services that will be provided for the event.

AMBULANCE: _____
DOCTOR (S): _____
PARAMEDICS: _____

10. CITY SERVICES/EQUIPMENT REQUESTED FOR THIS

EVENT: Police Department (security) & Electrical Department (electricity to be turned on court square side of Marion, Warren from Washington to Trade, Lafayette from Graham to Marion), requesting that Christmas lights and street lights be on during the event. City Utilities Department for street closures, additional trash receptacles, trash pickup on Saturday

11. ANY ADDITIONAL COMMENTS: 7th Inning Stretch Festival, ALWS, Dragonfly Marketing, and volunteers will be on site during the entire event, and it will be our responsibility to contact all of the department representatives prior to each event. The committee will contract for adequate portable restroom facilities. Written permission from the County to use the Historic Court square for it scheduled activities has been requested.

Dragonfly Marketing team will personally advised all uptown Shelby businesses in the festival area of the event.

Dragonfly Marketing will meet with Chief Jeff Ledford and designated officer to discuss Law Enforcement Support for the event. Last year the department provided man power to support the festival and to had a command center set up within the festival area to assist citizens in need of services. The Chief and Captain also helped determine the need for road support for the 5K the morning of the festival.

Dragonfly Marketing will meet with Scott Black – City of Shelby Street Supervisor. Mr. Black supports the street closures requested and times. Mr. Black will provide the necessary set up and blockage of streets as needed. Dragonfly Marketing will continue to meet with City of Shelby Departments to ensure knowledge of all events the day of the Festival.

Dragonfly Marketing will provide road closure information to all Emergency Response Centers that serve the festival area. Additionally, the information will be provided to local media and on social media sites prior to the event.

The Shelby Fire Department has requested a command center for the last 2 years and hope to have them again this year.

THE CITY OF SHELBY IS NOT A COSPONSOR OF THE EVENT.

It is understood and agreed that any permit issued pursuant to this application is issued on the condition that the answers herein given are true and correct to the best of the knowledge, information, and belief of the applicant.

Kimberly S. Davis 
(SIGNATURE)

ALWS 704-600-6599
(APPLICANT) (PHONE)

5 E. Marion St., Suite 2, Shelby, NC 28150
(ADDRESS)

1-18-2018
(DATE)

2017 Festival Map

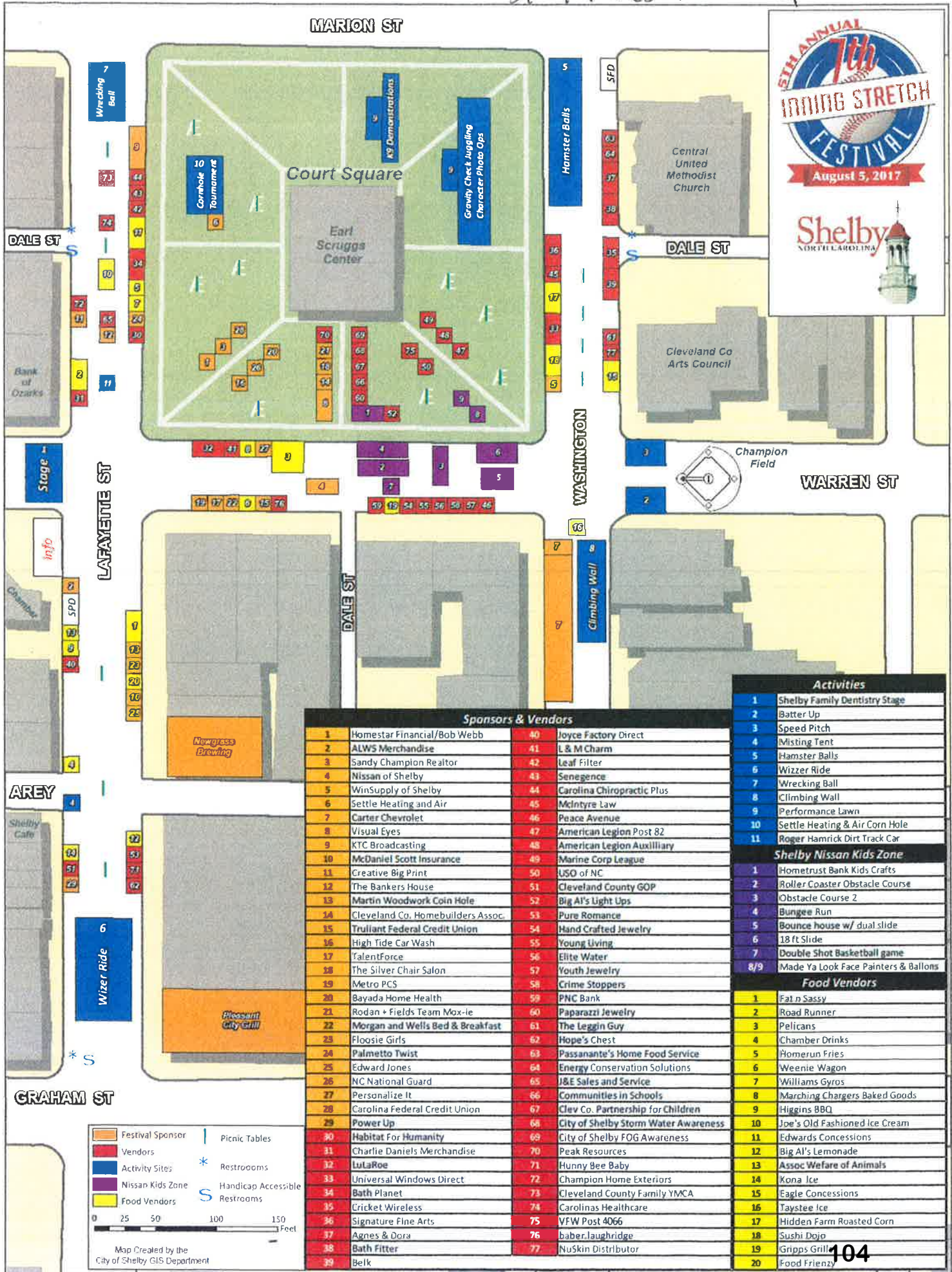

Sponsors & Vendors			
1	Homestar Financial/Bob Webb	40	Joyce Factory Direct
2	ALWS Merchandise	41	L & M Charm
3	Sandy Champion Realtor	42	Leaf Filter
4	Nissan of Shelby	43	Senegence
5	WinSupply of Shelby	44	Carolina Chiropractic Plus
6	Settle Heating and Air	45	McIntyre Law
7	Carter Chevrolet	46	Peace Avenue
8	Visual Eyes	47	American Legion Post 82
9	KTC Broadcasting	48	American Legion Auxilliary
10	McDaniel Scott Insurance	49	Marine Corp League
11	Creative Big Print	50	USO of NC
12	The Bankers House	51	Cleveland County GOP
13	Martin Woodwork Coin Hole	52	Big Al's Light Ups
14	Cleveland Co. Homebuilders Assoc.	53	Pure Romance
15	Trulliant Federal Credit Union	54	Hand Crafted Jewelry
16	High Tide Car Wash	55	Young Living
17	TalentForce	56	Elite Water
18	The Silver Chair Salon	57	Youth Jewelry
19	Metro PCS	58	Crime Stoppers
20	Bayada Home Health	59	PNC Bank
21	Rodan + Fields Team Mox-ie	60	Paparazzi Jewelry
22	Morgan and Wells Bed & Breakfast	61	The Leggin Guy
23	Floosie Girls	62	Hope's Chest
24	Palmetto Twist	63	Passanante's Home Food Service
25	Edward Jones	64	Energy Conservation Solutions
26	NC National Guard	65	J&E Sales and Service
27	Personalize It	66	Communities in Schools
28	Carolina Federal Credit Union	67	Clev Co. Partnership for Children
29	Power Up	68	City of Shelby Storm Water Awareness
30	Habitat For Humanity	69	City of Shelby FOG Awareness
31	Charlie Daniels Merchandise	70	Peak Resources
32	LulaRoe	71	Hunny Bee Baby
33	Universal Windows Direct	72	Champion Home Exteriors
34	Bath Planet	73	Cleveland County Family YMCA
35	Cricket Wireless	74	Carolinas Healthcare
36	Signature Fine Arts	75	VFW Post 4066
37	Agnes & Dora	76	baber.laughridge
38	Bath Fitter	77	NuSkin Distributor
39	Belk		

Activities	
1	Shelby Family Dentistry Stage
2	Batter Up
3	Speed Pitch
4	Misting Tent
5	Hamster Balls
6	Wizzer Ride
7	Wrecking Ball
8	Climbing Wall
9	Performance Lawn
10	Settle Heating & Air Corn Hole
11	Roger Hamrick Dirt Track Car
Shelby Nissan Kids Zone	
1	Hometrust Bank Kids Crafts
2	Roller Coaster Obstacle Course
3	Obstacle Course 2
4	Bungee Run
5	Bounce house w/ dual slide
6	18 ft Slide
7	Double Shot Basketball game
8/9	Made Ya Look Face Painters & Ballons
Food Vendors	
1	Fat n Sassy
2	Road Runner
3	Pelicans
4	Chamber Drinks
5	Homerun Fries
6	Weenie Wagon
7	Williams Gyros
8	Marching Chargers Baked Goods
9	Higgins BBQ
10	Joe's Old Fashioned Ice Cream
11	Edwards Concessions
12	Big Al's Lemonade
13	Assoc Welfare of Animals
14	Kona Ice
15	Eagle Concessions
16	Taystee Ice
17	Hidden Farm Roasted Corn
18	Sushi Dojo
19	Gripps Grill
20	Food Frieny

Festival Sponsor
 Vendors
 Activity Sites
 Nissan Kids Zone
 Food Vendors
 Picnic Tables
 * Restrooms
 S Handicap Accessible Restrooms

0 25 50 100 150 Feet
 Map Created by the City of Shelby GIS Department

**7th Inning Stretch 5K
Shelby, NC**

August 5, 2017

Measured by Steve D'Avria

***not to scale**

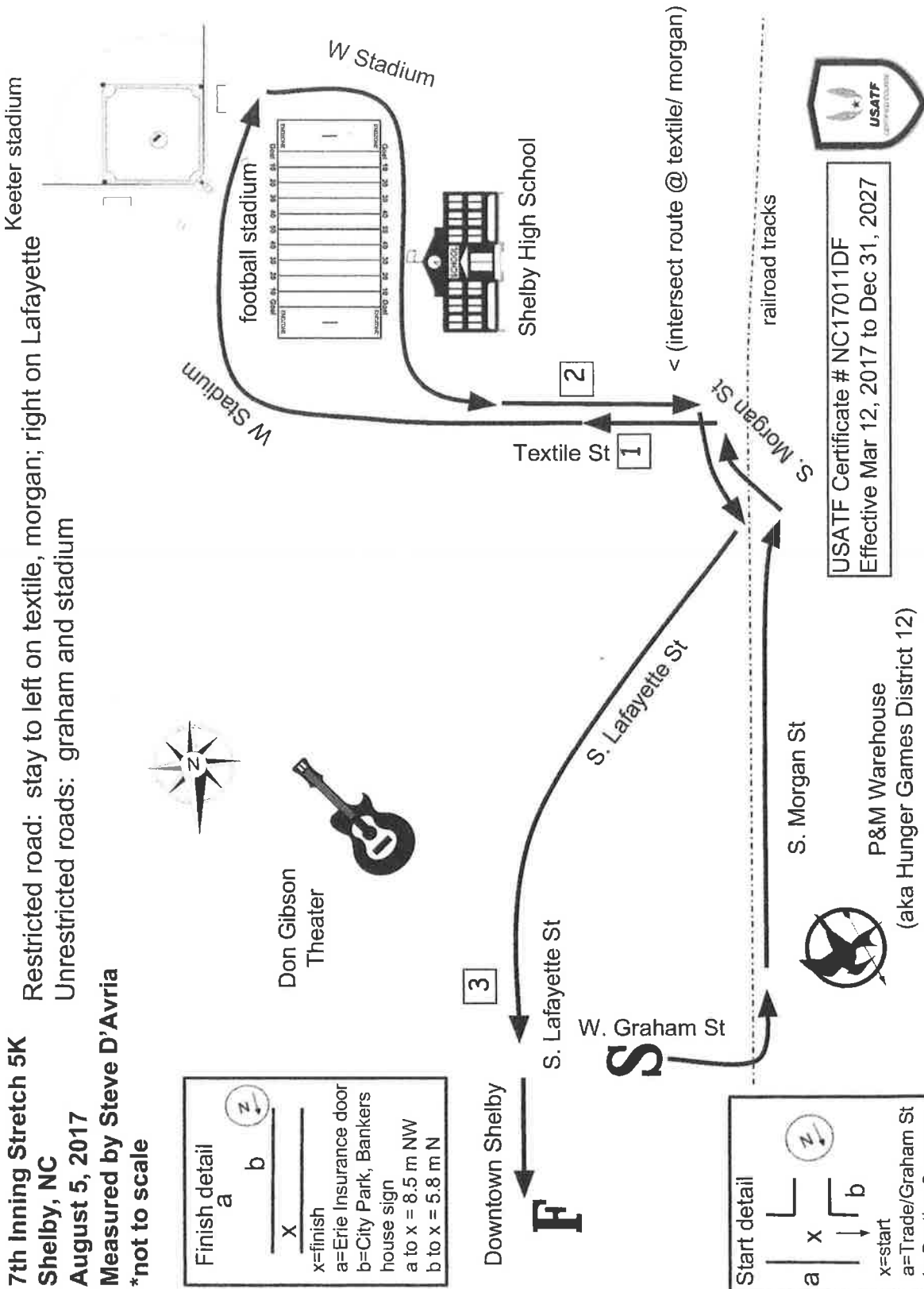

Finish detail

a
b

X

x=finish
a=Erie Insurance door
b=City Park, Bankers house sign
a to x = 8.5 m NW
b to x = 5.8 m N

Start detail

a
x
b

x=start
a=Trade/Graham St
b=Section 8 corner
a to x = 20 m SW
b to x = 22.5 m E

Memo

To: Police Chief Jeff Ledford, Fire Chief William Hunt, Assistant Fire Chief Todd McMurry, Parks & Recreation Director Charlie Holtzclaw, Public Works Director Danny Darst, Assistant Director of Public Works Scott Black, Director of Energy Services Julie McMurry, Electric Superintendent Jeff Freeman, Director of Water Resources David Hux, Director of Engineering Services Ben Yarboro, and Planning and Development Services Director Walt Scharer

From: Bernadette A. Parduski, City Clerk

CC: Rick Howell, City Manager

Date: February 1, 2018

Re: Special Event Permit Application

All:

Attached you will find a Special Event Permit Application submitted by Kim Davis of Dragonfly Marketing on behalf of the American Legion World Series office as follows:

- ✓ Host City Welcome, requested date: August 15, 2018

Please carefully review the details of this application as it pertains to your department, and let me know of any anticipated problems/objections that you would like to bring to the attention of the City Council. If there are none, please let me know that as well. The event will be considered by City Council at the February 19, 2018 meeting and recommended for approval unless you advise otherwise. If I do not hear from you by February 12, 2018, it will be assumed that you are in agreement with the application as presented.

As always, thanks for your attention and consideration.

Attachment

**CITY OF SHELBY
SPECIAL EVENT PERMIT APPLICATION**

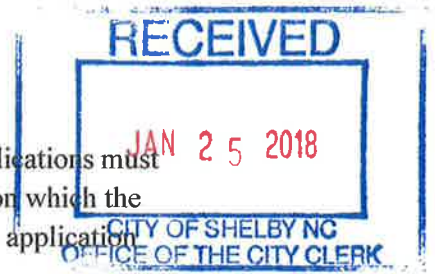

Each question must be legible and answered clearly and completely. Applications must be filed with the City Clerk not less than three (3) weeks before the date on which the event is to take place. A fee of \$20.00 will be due upon submission of the application form.

1. **EVENT NAME:** Host City Welcome

2. PURPOSE AND BRIEF DESCRIPTION OF EVENT:

The event is to welcome all the teams to Cleveland County. They will eat, play corn hole and a concert .

3. **LOCATION OF EVENT (ATTACH MAP):** (1) Washington from south of Marion to S. of Warren intersection and Warren from east of Washington to east of Lafayette St.

4. PLEASE INDICATE:

Approximately how many people will attend the event: 3000- 5000

Approximately how many vehicles will be present: No vehicles will be permitted (unless on display for the event) on the streets closed for the event

Approximately how many animals will be present: only those brought in by attendees

If the event is a parade, please indicate the amount of street that will be needed:

Single lane _____

All lanes in travel direction All lanes in the travel direction

Whole street _____

5. PLEASE LIST THE FOLLOWING PARTY (IES) RESPONSIBLE FOR THE EVENT:

Name: Dragonfly Marketing (Kim Davis)

Address: 5 E. Marion St. Suite 2, Shelby NC 28150

Phones: 704-600-6599 (Daytime) 704-473-8248(Evening)

Email Address: Kim@dragonflymarketing.cc

Name: ALWS

Address: 117-A W. Warren St., Shelby NC 28150

Phones: 704-466-3103 (Daytime)

Email Address: Robby@bcgroupinc.com

6. PLEASE LIST THE FOLLOWING:

Requested day(s) and date(s): August 15th

Alternate day(s) and date(s): _____

Requested hours of operation, from 5:00 pm to 9:00 PM roads will need to be closed around noon on August 14th to allow for tents and stage to be set up.

7. SANITATION: Below states the “Plan for Clean-Up.” Please check Application Instruction sheet for details.

Use the permanent trash cans in the festival area. Request additional trash cans to be delivered the day before the event. Event staff will do final cleanup of area.

8. AVAILABILITY OF FOOD, BEVERAGES, AND/OR ENTERTAINMENT;

If there will be music, sound amplification, or any other noise impact, please describe on attached sheet, including the intended hours of the music, sound, or noise.

Music from 5:00 pm to 9:00 pm

Will alcoholic beverages be served? No

If yes, attach to the application a copy of your permit from the Cleveland County Alcoholic beverage Control Board. Alcohol may not be served without a permit!!!

Will food and/or non-alcoholic beverages be served? Yes, all food vendors will supply their health department permits.

If yes, attach to the application a copy of your permit from the Cleveland County Department of Health Services.

9. SECURITY AND SAFETY PROCEDURES:

Attach to this application a copy of your building permit(s) if you are installing any electrical wiring on a temporary or permanent basis and/or if you are building any temporary or permanent structures such as bleachers, scaffolding, a grandstand, viewing stands, stages, or platforms. Attach a copy of your Shelby Fire Department Permit or permits to this application if you will use parade floats; an open flame; fireworks; or pyrotechnics; vehicle fuel; cooking facilities; enclosures (and tables within those enclosures); tents; air supported structures; and/or any fabric shelter.

Give name, address, and phone numbers of the agency or agencies, which will provide first aid staff and equipment. Attach additional sheets if necessary.

Dragonfly Marketing will meet with Cleveland County EMS and they will have assigned responders to come in from around the festival areas to ensure quick access for services and if needed set up a command center within the festival area to provide on-site first responder services.

Name: Cleveland County EMS
Address: 100 Justice Place, Shelby, NC 28150
Phones: 704-484-4984

Indicate medical services that will be provided for the event.

AMBULANCE: _____

DOCTOR (S): _____

PARAMEDICS: _____

10. CITY SERVICES/EQUIPMENT REQUESTED FOR THIS

EVENT: Police Department (security) & Electrical Department (electricity to be turned on court square side of Washington City Utilities Department for street closures, additional trash receptacles, trash pickup on Wednesday Request that the Christmas lights and street post lighting be on during the event.

11. ANY ADDITIONAL COMMENTS:

Dragonfly Marketing will meet with Chief Jeff Ledford and designated officer to discuss Law Enforcement for the event.

Dragonfly Marketing will meet with Scott Black – City of Shelby Street Supervisor. Mr. Black supports the street closures requested and times. Mr. Black will provide the necessary set up and blockage of streets as needed. Dragonfly Marketing will continue to meet with City of Shelby Departments to ensure knowledge of all events the day of the Festival.

Dragonfly Marketing will provide road closure information to all Emergency Response Centers that serve the festival area. Additionally, the information will be provided to local media and on social media sites prior to the event.

THE CITY OF SHELBY IS NOT A COSPONSOR OF THE EVENT.

It is understood and agreed that any permit issued pursuant to this application is issued on the condition that the answers herein given are true and correct to the best of the knowledge, information, and belief of the applicant.

Kimberly S. Davis

(SIGNATURE)

ALWS
(APPLICANT)

704-600-6599
(PHONE)

5 E. Marion St., Suite 2, Shelby, NC 28150
(ADDRESS)

1-18-18
(DATE)

Bank of the Ozarks

W Dale

Chamber

Newgrass

LAFAYETTE STREET



LEGEND

- Hand Washing
- P** Power
- Port a Johns
- Barriers
- 1-3 Vendors

**HOST CITY
WELCOME
2018**

- Can set up after 5pm**
1. ALWS Merchandise
 2. Uptown Shelby
 3. Clev Co Tourism

Available After
5:00 PM

Lilly Bean
Baber Laughridge

3
2
1

Cornhole
Tournament

Stage

Mason
Square

Arts Council

40' x 70' Tent

40' x 85' Tent

Prep
Tent
20' x 20'

Central United Church

MARION STREET

58'

276'

City of Shelby
Agenda Item Summary
June 4, 2018
City Hall Council Chamber

Agenda Item: D-3

3) Approval of a resolution authorizing the upset bid process: Resolution No. 25-2018

Consent Agenda Item: (Staff Resource, Rick Howell, City Manager)

Summary of Available Information:

- Foothills Commerce Center Map (parcel highlighted in yellow)
- Resolution No. 25-2018

City Manager's Recommendation / Comments

Resolution No. 25-2018 is presented for City Council consideration at this time. If approved this resolution would authorize the sale of a 7.586 acre parcel of land owned by the City of Shelby via the upset bid procedure delineated in NC General Statute 160A-269. The City has received an offer to purchase said property from Mafic USA, LLC for the amount of \$151,720 and the required bid deposit equaling 5% of this amount has been received by the City. Following adoption of this resolution the City Clerk will run advertisement notifying the public that an upset bid may be submitted within 10 days after the notice of sale is published. Any upset bid must raise the existing offer as spelled out by the statute and that bidder must also submit a bid deposit equaling 5% of the new bid at that time. If no bid is received the City may then proceed with the sale. Council may at any time withdraw this property from a sale.

Mafic USA, LLC is a logical purchaser of this property which is located within the Foothills Commerce Center directly behind their current facility. The assessed tax value for this parcel is currently set at \$180,546. It is recommended that Council initiate this process. The parcel is advantageously situated to allow for a future expansion of the Mafic plant although no expansion is promised at this time.

It is my recommendation that Resolution No. 25-2018 be adopted and approved at this time.

Revision of Plat Book 35 Page 182

MAP 1 OF 2

Foothills Commerce Center - Phase 2

owner
The City of Shelby
 DEED REFERENCE: DEED 1568 PAGE 888
 PLAT REFERENCE: PLAT BOOK 34 PAGE 76
 PLAT BOOK 35 PAGE(S) 182, 183
 CLEVELAND COUNTY, NORTH CAROLINA
 TAX MAP REF: 6-100-1-80 thru 87
 GIS PARCEL NUMBER: 62155 thru 62162
 SCALE 1" = 225' DATE 08/01/12
 REVISED ON 08/14/14 REVISED ON 10/01/13

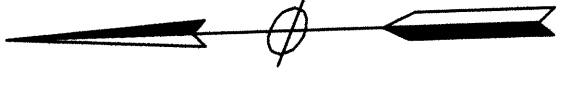
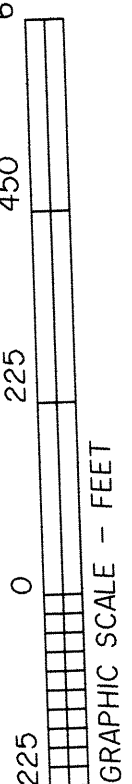

STATE OF NORTH CAROLINA
COUNTY OF CLEVELAND

REVIEW OFFICER OF
 CLEVELAND COUNTY CERTIFY THAT THIS MAP OR
 PLAT TO WHICH THIS CERTIFICATION IS AFFIXED
 MEETS ALL STATUTORY REQUIREMENTS FOR RECORDING.

DATE REVIEW OFFICER

Future Hwy #74 By-Pass

REFERENCE: NCDOT PROJECT #3497.28; DEED 1638 PAGE 1017

Artee Road S.R. 1314

Future Hwy #74 By-Pass

REFERENCE: DEED 1638 PAGE 1017

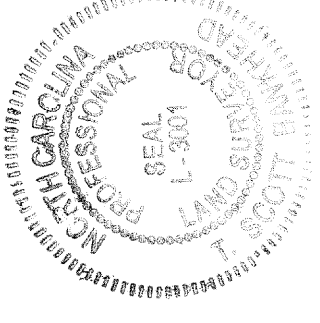
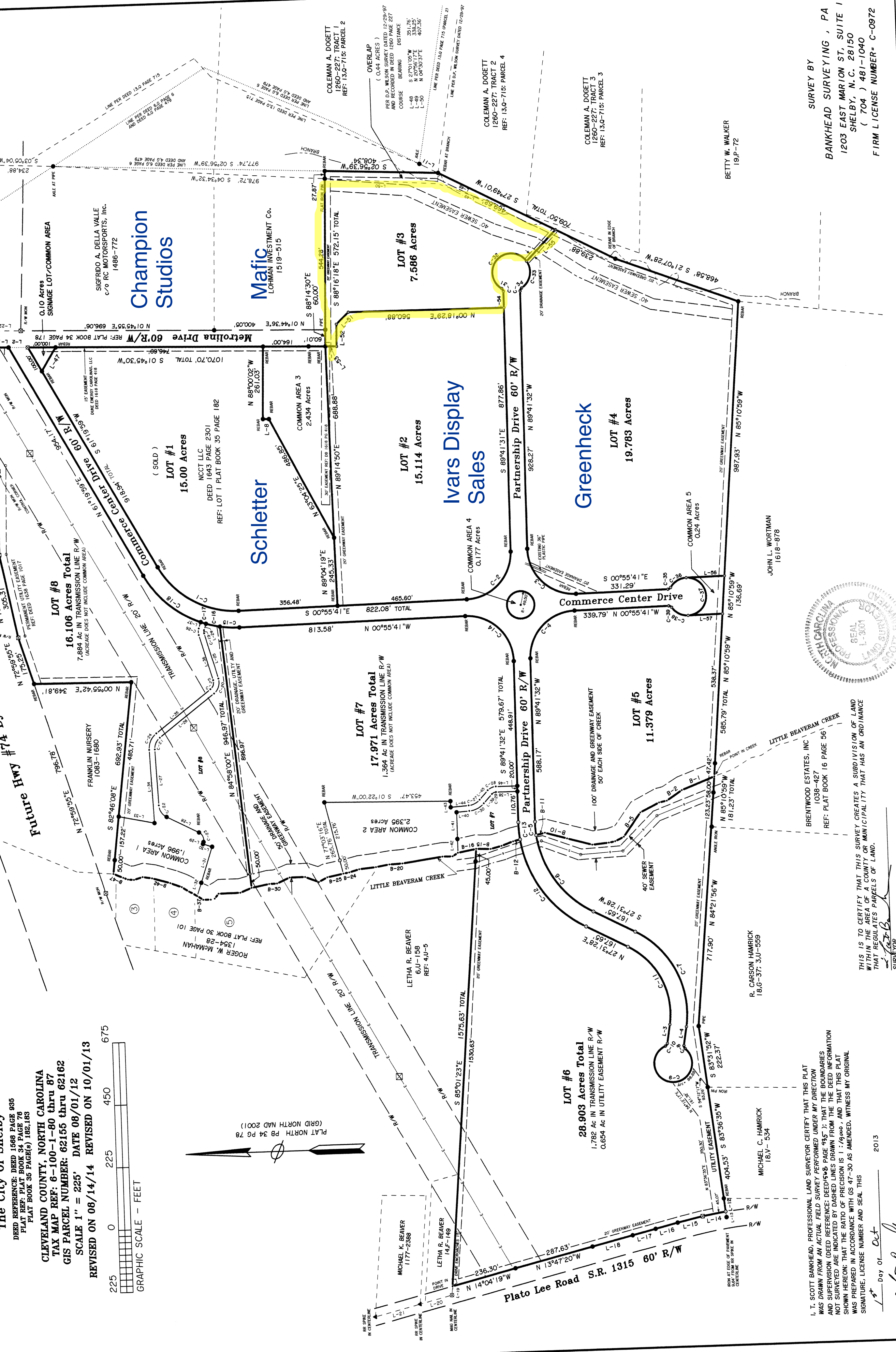

THIS IS TO CERTIFY THAT THIS SURVEY CREATES A SUBDIVISION OF LAND
 WITHIN THE AREA OF A COUNTY OR MUNICIPALITY THAT HAS AN ORDINANCE
 THAT REGULATES PARCELS OF LAND.

T. Scott Bankhead
 SURVEYOR

I, T. SCOTT BANKHEAD, PROFESSIONAL LAND SURVEYOR CERTIFY THAT THIS PLAT
 WAS DRAWN FROM AN ACTUAL FIELD SURVEY PERFORMED UNDER MY DIRECTION
 AND SUPERVISION (DEED REFERENCE: DEED 1568 PAGE 888; PLAT REF: PLAT BOOK 34 PAGE 76; PLAT BOOK 35 PAGE(S) 182, 183); THAT THE BOUNDARIES
 NOT SURVEYED ARE INDICATED BY DASHED LINES DRAWN FROM THE DEED INFORMATION
 SHOWN HEREON; THAT THE RATIO OF PRECISION IS 1:179,000; AND THAT THIS PLAT
 WAS PREPARED IN ACCORDANCE WITH GS 47-30 AS AMENDED, WITNESS MY ORIGINAL
 SIGNATURE, LICENSE NUMBER AND SEAL THIS

2013

1st Day of Oct

T. Scott Bankhead
 Professional Land Surveyor - License No. L-3001

SURVEY BY
 BANKHEAD SURVEYING, PA
 1203 EAST MARION ST., SUITE 1
 SHELBY, N.C. 28150
 (704) 481-1040
 FIRM LICENSE NUMBER C-0972

RESOLUTION NO. 25-2018

A RESOLUTION AUTHORIZING THE UPSET BID PROCESS

WHEREAS, the City of Shelby owns certain property, Cleveland County GIS Parcel Number 62527 with survey prepared by Bankhead Surveying, PA; and

WHEREAS, North Carolina General Statute § 160A-269 permits the City of Shelby to sell property by upset bid, after receipt of an offer for the property; and

WHEREAS, the City has received an offer to purchase the property described above, in the amount of \$151,720, submitted by Mafic USA LLC; and

WHEREAS, Mafic USA LLC has paid the required five percent (5%) deposit on its offer.

THEREFORE, THE CITY COUNCIL OF THE CITY OF SHELBY, NORTH CAROLINA RESOLVES THAT:

1. The City Council authorizes sale of the property described above through the upset bid procedure of North Carolina General Statute § 160A-269.
2. The City Clerk shall cause a notice of the proposed sale to be published. The notice shall describe the property and the amount of the offer, and shall state the terms under which the offer may be upset.
3. Persons wishing to upset the offer that has been received shall submit a sealed bid with their offer to the Office of the City Clerk within 10 days after the notice of sale is published. At the conclusion of the 10-day period, the City Clerk shall open the bids, if any, and the highest such bid will become the new offer. If there is more than one bid in the highest amount, the first such bid received will become the new offer.
4. If a qualifying higher bid is received, the City Clerk shall cause a new notice of upset bid to be published, and shall continue to do so until a 10-day period has passed without any qualifying upset bid having been received. At that time, the amount of the final high bid shall be reported to the City Council.
5. A qualifying higher bid is one that raises the existing offer by not less than ten percent (10%) of the first \$1,000.00 of that offer and five percent (5%) of the remainder of that offer.
6. A qualifying higher bid must also be accompanied by a deposit in the amount of five percent (5%) of the bid; the deposit may be made in cash, cashier's check, or certified check. The City of Shelby will return the deposit on any bid not accepted, and will return the deposit on an offer subject to upset if a qualifying higher bid is received. The City of Shelby will return the deposit of the final high bidder at closing.

7. The terms of the final sale are that:

- The City Council must approve the final high offer before the sale is closed, which it will do within 30 days after the final upset bid period has passed, and
- The buyer must pay with cash at the time of closing.

8. The City of Shelby reserves the right to withdraw the property from sale at any time before the final high bid is accepted and the right to reject at any time all bids.

9. If no qualifying upset bid is received after the initial public notice, the offer set forth above is hereby accepted. The appropriate City officials are authorized to execute the instruments necessary to convey the property to Mafic USA LLC.

Adopted and approved this the 4th day of June 2018.

O. Stanhope Anthony III
Mayor

ATTEST:

Bernadette A. Parduski, NC-CMC, IIMC-MMC
City Clerk

City of Shelby
Agenda Item Summary
June 4, 2018
City Hall Council Chamber

Agenda Item: D-4

- 4) Approval of a reimbursement resolution with regard to installment financings for Fiscal Year 2018-2019: Resolution No. 26-2018

Consent Agenda Item: (Staff Resource, Justin Merritt, Finance Director)

Summary of Available Information:

- Attachment “A”, 2019 City of Shelby Proposed Installment Contract Equipment List
- Resolution No. 26-2018

City Manager’s Recommendation / Comments

As noted in Mr. Merritt’s memo referenced above this resolution would allow the City to reimburse itself from financing proceeds obtained to purchase capital equipment during the upcoming fiscal year. As you all know the City finances its annual rolling stock (police cars, fire trucks, utility trucks, backhoes, etc.) by borrowing money short term at tax exempt interest rates over a 59 month period. This allows the City to maintain cash liquidity and manage its fleet in an effective manner. Financing for capital purchases this year will again be bid out to interested financial institutions to achieve the most competitive rate.

It is my recommendation Resolution No. 26-2018 be adopted and approved by City Council at this time via the Consent Agenda.

Attachment A
2019 City of Shelby
Proposed Installment Contract Equipment List

<u>Dept.</u>	<u>Description</u>	<u>Cost Center</u>	<u>Estimated Cost</u>
Purchasing	Fuel Site Equipment		68,000.00
Garage	Large Air Compressor	10425-51000	9,700.00
Police	Dodge Charger V6 RWD-Patrol	110431-54000	24,700.00
	Dodge Charger V6 RWD-Patrol	110431-54000	24,700.00
	Dodge Charger V6 RWD-Patrol	110431-54000	24,700.00
	Dodge Charger V6 RWD-Patrol	110431-54000	24,700.00
	Dodge Charger V6 RWD-Patrol	110431-54000	24,700.00
	Dodge Charger V6 RWD-Patrol	110431-54000	24,700.00
	Dodge Charger V6 RWD-Patrol	110431-54000	24,700.00
	Dodge Charger V6 RWD -CID	110431-54000	18,700.00
	Dodge Charger V6 RWD -CID	110431-54000	18,700.00
Planning	Small SUV	110493-51000	25,000.00
Sanitaion	AutoCar Grabage Truck	110471-54000	295,000.00
Parks & Rec.	F-150 4X2 Regular Cab	110613-54000	22,000.00
	Grasshopper 725D Mower	110613-51000	14,000.00
	John Deere Z-TRAC Mower	110613-51000	11,000.00
	2 Kioti Utility Vehicles	110613-51000	18,000.00
City Hall	Door Passkey System	112452-51000	17,000.00
Water Fund	SCADA Equipment	620724-51000	250,000.00
Sewer Fund	Copier	620724-51000	6,500.00
Electric Fund	Tractor/Bucket/Backhoe/Trailer	630733-54000	41,000.00
Gas Fund	F-150 4X4	640743-54000	35,000.00
Stormwater Fund	Pole Camera	650751-51000	18,000.00
Total:			<u><u>1,040,500.00</u></u>

RESOLUTION NO. 26-2018

CITY OF SHELBY
REIMBURSEMENT RESOLUTION WITH REGARD TO
INSTALLMENT FINANCINGS FOR FISCAL YEAR 2018-2019

WHEREAS, the Internal Revenue Service and U.S. Treasury Department have published regulations that govern when a political subdivision such as the City of Shelby, North Carolina (the City), can issue or execute tax-exempt obligations to reimburse itself or any agency or division thereof for expenditures on purchases prior to the issuance of tax-exempt obligations for such projects; and

WHEREAS, the regulations require that the governing body of the political subdivision adopt a resolution reciting certain facts and intentions prior to the incurrence of the expenditures; and

WHEREAS, the City anticipates incurring certain expenditures for fiscal year 2018-2019 in an approximate amount not exceeding \$1,040,500 (the "Expenditures") with respect to purchase of motorized and other equipment prior to the issuance by the City of tax-exempt obligations in the form of an installment purchase contract for such purpose in an amount not to exceed \$1,040,500 expenditures for fiscal year 2018-2019.

NOW, THEREFORE, BE IT RESOLVED, by the City Council of the City of Shelby as follows:

Section 1. The City Council hereby declares a reasonable "official intent" pursuant to Regulation 1.103-18 to the Internal Revenue Code of 1986, as amended, to reimburse the City from the proceeds of tax exempt obligations in the form of an installment purchase contract of the City executed under the authority of North Carolina General Statute 160A-20, as amended for such Expenditures. Such Expenditures must be incurred not later than two years from the date hereof in order to be eligible for reimbursement from the proceeds of the installment purchase contract or such other date as may be applicable in the regulations. The City anticipates incurring Expenditures in an approximate amount of not exceeding \$1,040,500 for fiscal year 2018-2019.

Section 2. To be eligible for reimbursement of the Expenditures, the installment purchase contract will be executed on or before the later of the date one year after the Expenditure was paid or the date one year after the equipment was placed in service, or such later date as may be applicable in the regulations as amended.

Section 3. The Expenditures are incurred solely to acquire, construct or rehabilitate property having a reasonably expected economic life of at least one year.

Section 4. The source of funds for the General Fund Expenditures will be general funds derived primarily from ad valorem taxes of the City and other City general funds and for the Enterprise Funds Expenditures will be charges for enterprise services.

Resolution No. 26-2018
June 4, 2018
Page 2

Adopted and approved this the 4th day of June 2018.

O. Stanhope Anthony, III
Mayor

ATTEST:

Bernadette A. Parduski, NC-CMC, IIMC-MMC
City Clerk

APPROVED AS TO FORM:

Robert W. Yelton
City Attorney

City of Shelby
Agenda Item Summary
June 4, 2018
City Hall Council Chamber

Agenda Item: D-5

- 5) Approval of a resolution awarding the bid for the fabrication of the meter set for Clearwater 2S facility: Resolution No. 27-2018

Consent Agenda Item: (Staff Resource, Julie McMurry, Energy Services Director)

Summary of Available Information:

- Memorandum dated May 25, 2018 from Julie McMurry, Energy Services Director to Rick Howell, City Manager
- Letter dated May 25, 2018 from Heath and Associates, Inc. to Julie McMurry, Energy Services Director
- Bid Tabulation Sheet
- Resolution No. 27-2018

City Manager's Recommendation / Comments

Resolution No. 27-2018 is presented for City Council consideration at this time. If approved this resolution would award a contract in the amount of \$83,135.00 to First Cut Design and Fabrication for the fabrication of the natural gas meter set to be used to serve Clearwater Paper's new 2S facility.

It is my recommendation Resolution No. 27-2018 be adopted and approved by City Council at this time via the Consent Agenda.

Memorandum

To: Rick Howell, City Manager
Justin Merritt, Finance Director

From: Julie McMurry, Energy Services Director *JM*

RE: Natural Gas – Meter Set for Clearwater 2S Facility

Date: May 25, 2018

Background:

In addition to the gas main extension and service line installation for the Clearwater 2s facility, a meter set designed to meet their volumes and processes was necessary, as is the case with industrial customers.

Heath and Associates, Inc. completed the design and provided a cost estimate of \$97,400.00. In addition they solicited bids for the fabrication of the meter set. The project was advertised and bids were accepted on Thursday, May 24, 2018 at 11:00 AM. Three bids were received, they are as follows:

First Cut Design and Fabrication	\$ 83,135.00
Pipeline Equipment, Inc.	\$112,767.00
Consolidated Pipe & Supply	\$124,897.50

Review:

Bids have been reviewed by Heath and Associates, Inc. and we have received their recommendation to award to the lowest bidder, First Cut Design and Fabrication. The letter of recommendation is attached.

Recommendation:

Staff recommends that City Council authorize the award of this bid to First Cut Design and Fabrication for the fabrication of the meter set to serve Clearwater 2s facility. Please let me know if additional information is required.

Attachments



May 25, 2018

Mrs. Julie McMurry, Energy Services Director
City of Shelby
824 W. Grover Street
Shelby, NC 28150

**Re: City of Shelby – Clearwater Service Line Meter Project
Heath and Associates, Inc. PN 21721.1**

Dear Julie,

Bid proposals for the City of Shelby – Clearwater Service Line Meter Project were received on May 24, 2018 at the City of Shelby Operations Office from contractors. Four contractors were invited to submit proposals. There was a total of three bids submitted.

First Cut Design & Fabrication, Inc. submitted the lowest bid of \$83,135.00. Pipeline Equipment, Inc. submitted a bid of \$112,767.00 and Consolidated Pipe & Supply Company, Inc. submitted a bid of \$124,897.50. Our engineering estimate was \$97,400.00.

It is our opinion that you have received a good proposal for this project from a reputable Contractor and therefore, recommend that the City select First Cut Design & Fabrication, Inc. for the Clearwater Service Line Meter Project. First Cut Design & Fabrication, Inc. has a good history working with Heath and Associates and we expect will perform the work professionally and to your satisfaction.

If you have any questions or comments, please do not hesitate to contact us.

Sincerely,

Heath and Associates, Inc.

A handwritten signature in blue ink, appearing to read "A. Moses", with a long horizontal flourish extending to the right.

Aaron Moses

cc: Jeff Champion, Superintendent

CITY OF SHELBY
CITY OF SHELBY – CLEARWATER SERVICE LINE METER PROJECT
PN# 21721.1
BID OPENING – MAY 24, 2018 - 11:00 A.M.

BIDDER	BID AMOUNT
First Cut Design and Fabrication 4818 Morrison Road Richburg, SC 29729 Attn: Jeff Francis Email: Jeff@firstcutdesign.com	\$83,135.00
Pipeline Equipment, Inc. (PEI) 8403 South 89 th West Avenue Tulsa, OK 74231 Attn: Natalie McBride	\$112,767.00
Advance Engineering Corporation (AEC) 440 S. McLean Blvd. Elgin, IL 60123 Attn: Marty Malcolm	N/A
Consolidated Pipe & Supply 202 East 16 th Street Charlotte, NC 28206-3214 Phone: 800/373-1880 Phone: 704/373-1800 Fax: 704/342-4333 Attn: Jaret Ledermann Jledermann@consolidatedpipe.com	\$124,897.50

RESOLUTION NO. 27-2018

A RESOLUTION AWARDING THE BID FOR THE FABRICATION OF
THE METER SET FOR CLEARWATER 2S FACILITY

WHEREAS, in accordance with applicable provisions of GS 143-129, as amended, the City of Shelby has accepted bids for the fabrication of the meter set to serve the Clearwater 2s facility; and,

WHEREAS, bids for this proposed work have been tabulated by Heath and Associates, Inc. and contract award recommendation made to City staff for this project; and,

WHEREAS, City Council now desires to proceed with award of contract as recommended by staff and with the improvements anticipated by this action.

NOW, THEREFORE, BE IT RESOLVED BY THE CITY COUNCIL OF THE CITY OF SHELBY, NORTH CAROLINA:

Section 1. The contract for the fabrication of the meter set to serve the Clearwater 2s facility as required in the bid specifications for this offering, are hereby awarded to First Cut Design and Fabrication for a bid price of \$83,135.00 as stated in their official proposal for this bidding, and in accordance with the City's official bid specifications for this project.

Section 2. The City Manager of the City of Shelby or his designee are hereby authorized and directed to execute the applicable contract as specified in Section 1 of this resolution.

Section 3. This resolution shall become effective upon its adoption and approval.

Adopted and approved this the 4th day of June 2018.

O. Stanhope Anthony III
Mayor

ATTEST:

Bernadette A. Parduski, NC-CMC, IIMC-MMC
City Clerk

City of Shelby
Agenda Item Summary
June 4, 2018
City Hall Council Chamber

Agenda Item: D-6

- 6) Adoption of an ordinance authorizing demolition of a dwelling: Ordinance No. 33-2018

Consent Agenda Item: (Staff Resource, Walter Scharer, Planning Director)

Summary of Available Information:

- Memorandum dated May 9, 2018 from Walter Scharer, Planning Director to Rick Howell, City Manager
- Photo of property
- Location Map – 607 Sherrill Place
- Tax Card for 2018
- Ordinance No. 33-2018

City Manager's Recommendation / Comments

Please note that the Building Inspector has duly conducted enforcement of the minimum housing code in accordance with the NC General Statutes and City Code. I do want to emphasize that it is the common practice of the City to err on the side of the property owner in most all cases giving them the benefit of the doubt when action is initiated. A thorough and fair due process is followed in all cases. Demolition of these homes is always the last resort after efforts to persuade a property owner to make these minimum standards have failed. As you all know once this ordinance is passed the City is empowered to enter onto the property to demolish the building. All associated demolition costs and administrative costs are then filed by the City Attorney as a lien against the property. This lien is normally only satisfied to the City's benefit upon the sale of the property.

Excerpt from Strategic Growth Plan

4. Community Appearance & Image

POLICY 4.4: Vacant and abandoned sites and buildings shall be properly cared for or removed, thereby preventing a blighting impact on the area in which they are located.

Action 4.4.1: Examine and implement standards for maintaining undeveloped or vacant lots and for repairing or removing abandoned structures and sites.

It is my recommendation Ordinance No. 33-2018 be adopted and approved by City Council at this time via the Consent Agenda.



Memorandum

To: Rick Howell - City Manager
From: Walter Scharer – Planning & Development Director
Date: May 9, 2018
Subject: **Demolition of Structure at 607 Sherrill Place**

Executive Summary of issue – Background

The dwelling associated with this proposed demolition action is in a dilapidated condition and should be removed for the safety of the citizens of Shelby. Initial complaints came from residents, the Shelby Police Department and City Code Enforcement. The property owner has been given due process and has failed to comply with the City's Minimum Housing Code.

Review and Comments

Due to dilapidation this dwelling is unfit for human habitation and has the potential of increasing the hazards of fire, accident, and other calamities; it is dangerous and detrimental to the health, safety, and welfare of the citizens of the City of Shelby. The estimated cost of demolition and removal is approximately \$5,000.00. Budgeted minimum housing funds will be used for this demotion.

Removal of this structure is in compliance with the City of Shelby Minimum Housing Code pursuant to N.C.G.S. 160A-441.

Removal of this structure is supported by the following Strategic Growth Plan Policies and Actions:

POLICY 4.4: Vacant and abandoned sites and buildings shall be properly cared for or removed, thereby preventing a blighting impact on the area in which they are located.

Action 4.4.1: Examine and implement standards for maintaining undeveloped or vacant lots and for repairing or removing abandoned structures and sites.

POLICY 9.2: Consistent, reliable enforcement of well written housing and nuisance abatement codes shall be employed to eliminate instances of unlawful activity and urban blight within the planning area of Shelby.

Recommendation

Please place this item on the consent agenda for the next City Council meeting on June 4, 2018. Staff recommends this minimum housing action.

Attachments: Photo of Structure, Location Map, Tax Card and Ordinance





Location Map 607 Sherrill Pl

Map Information:
Datum: NAD 1983
Coordinate: State Plane
North Carolina (Miler)
Projection: Lambert Conformal Conic
US National Grid
Grid Zone Designation (GZD): 17S
100,000m Square ID: MVWU

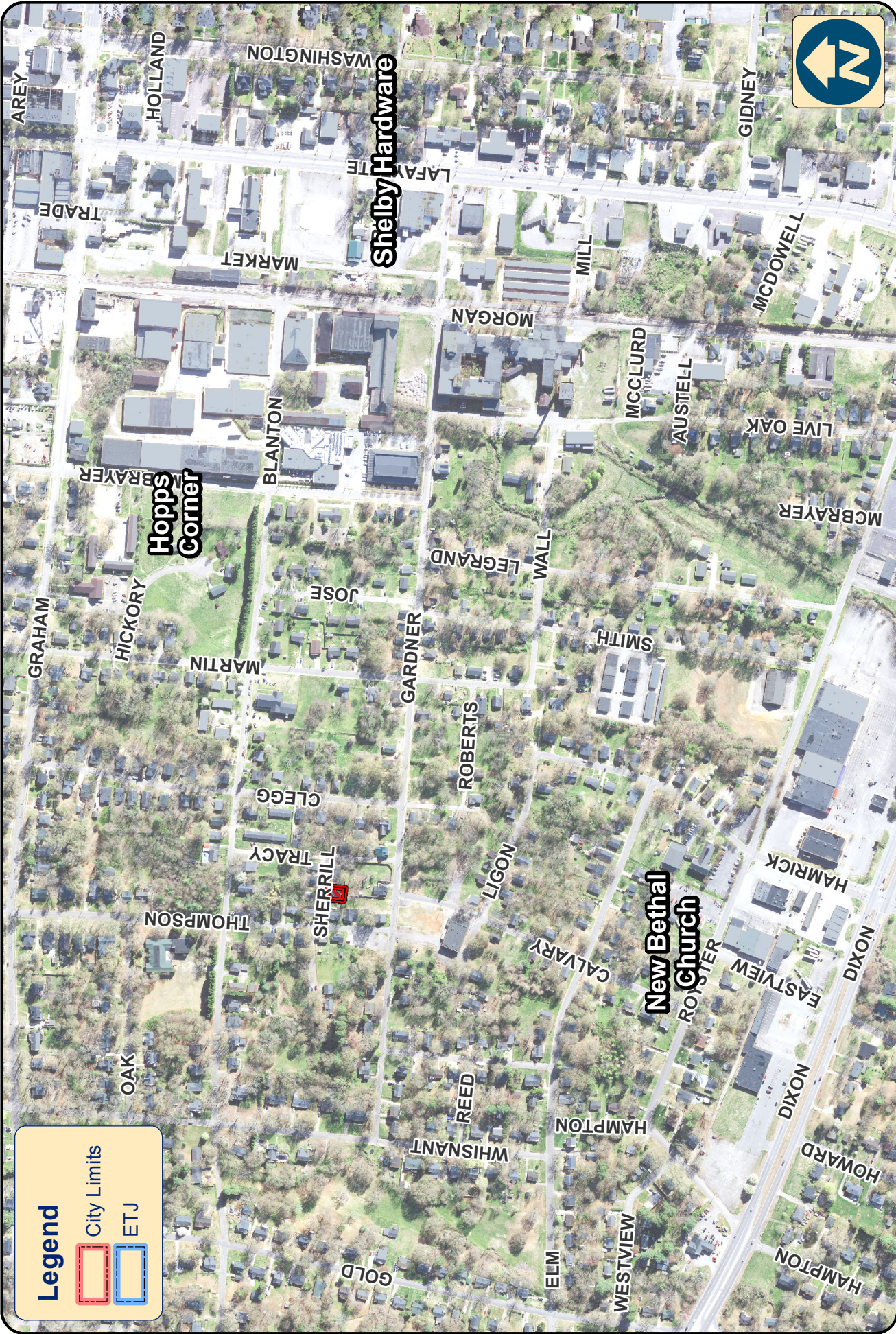

Legend

- City Limits
- ETJ

Scale 1:6,000 1 inch = 500 feet



Date: 5/9/2018

USER ALAN

FOR YEAR 2018

HAMMOND LEDGE SOUTH LLC
 34 LINCOLN AVE
 SHELBY

PARCEL ID.. 17818
 LOCATION... 607 SHERRILL PL
 DEED YEAR/BOOK/PAGE.. 2012 1631 1774
 PLAT BOOK/PAGE..
 LEGAL DESC:LOT#12 PB5-54 GC HAMRICK

PIN... S 9 12 7
 SHELBY
 ASSESSMENT RECY
 OWNER ID.. 1274187
 DISTRICT.. 6 CITY OF

NORWICH 06
 DESCRIPTION
 TOWNSHIP... 6 SHELBY
 CT 06360-

NBRHOOD... 232 S MAPS

RESIDENTIAL

MAINTAINED.. 5/17/2017 BY MAYES VALUED.. 9/14/2016 BY MAYES
 VISITED..... 5/01/1998 BY
 PARCEL STATUS... ACTIVE
 Personal

ROUTING#..
 CATEGORY.. Real &

SALES HISTORY

DEED BK/PAGE NAME	SALE DATE	SALES INSTRUMENT	DISQUALIFIED	SALE AMOUNT	STAMP AMOUNT	DEED
1631 1774 LEDGE SOUTH LLC	3/14/2012	DEED	QUALIFIED	7,500	15.00	HAMMOND
1462 0619 JEAN CLAUDE & HERMANN	9/06/2005	DEED	ADDITION PARCEL			LAVARIN
1066 0530 MYRTLE GRIGG	3/02/2004	DEED	NO STAMPS ON DE			SPARKS
1066 0530	7/01/1989	SALE	QUALIFIED		5.00	

LAND SEGMENTS

LND TOT # ADJ	CURRENT ZONE FMV	STRAT CODE	LAND TYPE/CODE	LAND QTY	LAND RATE	DPT%	SHP%	LOC%	SIZ%	OTH%	TOP%
1 68.00	1,700	02	FF F	50.000	50.00	68.00	.00	100.00	.00	.00	.00
.00			DPH..	66				OTHER ADJ...	.00	.00	.00
FMV..	TOTAL ACRES.. 1,700			.000							TOTAL LAND

IMPROVEMENT # 1 MAJOR IMPR-M

MAIN FIN AREA.. 836.00 ACT/EFF YR/AGE.. 1949 1974 42 VISITED..
 BY
 STRAT..... 02 DESCRIPT.... SINGLE FAMILY DWELLING-WF MAINTAINED..
 5/17/2017 BY MAYES
 MAIN PERIM..... 120.00 MAIN GROUND SF.... 836.000
 LOCATION #..... SHERRILL PL 607

COMPONENT COST	TYPE/CODE/DESC %CMPL	PCT	UNITS	RATE	STR#	STR%	SIZ%	HGT%	PER%	CDS%
AC 06 1,373	COVERED PORCH	100	84.00	13.19			124.00			
AC 06 1,068	COVERED PORCH	100	60.00	13.19			135.00			
MA 37W 54,000	SINGLE FAMILY DWELLI	100	836.00	62.11	1.00		104.00			100
EW 06 0	WOOD SIDING	100	120.00	.00						
- FD 04 0	PERIMETER FOOTING	100	836.00	.00						
- HC 05 0	FORCED HOT AIR	100	836.00	.00						
- PL R 0	RES PLUMB-EXTRA FIXT	100	5.00	717.00						

RCN...

PCT COMPLETE

100

x

56,441
 47,974
 37,180 T
 7,555

QUAL.. QG D3 D+- 85.00 x
 DEPR.. D6 42 YEARS OLD 70.00 - 33,582
 LOCA.. LOD LOCATIONAL OBS DEP 25.00 - 3,598

--FMV... MA 232 232 MARKET ADJ 70.00 x

DATE 3/29/18 CLEVELAND COUNTY
 PAGE 2
 TIME 10:13:06 PROPERTY CARD
 PROG# AS2006
 USER ALAN FOR YEAR 2018

HAMMOND LEDGE SOUTH LLC PARCEL ID.. 17818 PIN... S 9 12 7

----- IMPROVEMENT # 1 MAJOR IMPR-M -----

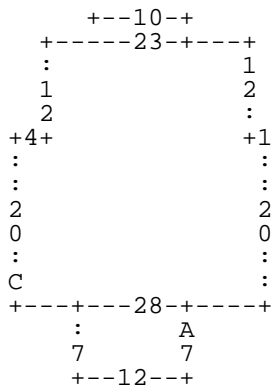

-----	AC 06	COVERED PORCH	-----	TRAVERSE	-----
M R	20.00	D D	7.00	D L	12.00
				D U	7.00
				D R	12.00
-----	AC 06	COVERED PORCH	-----	TRAVERSE	-----
M U	20.00	M R	4.00	M U	12.00
L	10.00			M R	16.00
D D	6.00	D R	10.00	D U	6.00
				D	
-----	MA 37W	SINGLE FAMILY DWELLI	FLOOR:	1.00	-----
				TRAVERSE	-----
D U	20.00	D R	4.00	D U	12.00
R	1.00			D R	23.00
D D	20.00	D L	28.00	D D	12.00
				D	

TOTAL PARCEL VALUES----	LAND /	OVR	IMPROVEMENTS /	OVR	TOTAL LAND/IMPROVE
2017 VALUE	FMV.....	1,700	7,555		9,255
9,255	APV.....	1,700	7,555		9,255
9,255					

----- COMMENTS - -----

ORDINANCE NO. 33-2018

AN ORDINANCE AUTHORIZING DEMOLITION OF A DWELLING

WHEREAS, pursuant to the provisions of Chapter 160A, Article 19, Part 6, of the North Carolina General Statutes, the single family dwelling located at **607 Sherrill Place** Shelby, North Carolina, has been inspected and found to be unfit for human habitation and to otherwise constitute a danger to persons and a threat to the health and welfare of the citizens within the City; and,

WHEREAS, according to the procedure provided by law, the owner(s) of said property, **Hammond Ledge South LLC** has or have been given notice of the aforesaid inspection, determination, and orders to bring said property into compliance with the housing standards of the City of Shelby by appropriate repair or removal of said dwelling; and,

WHEREAS, no action of any kind has been taken or initiated by the owner(s), or any party on behalf of said owner(s), to achieve compliance with said ordinances within the periods allowed by law; and,

WHEREAS, the said dwellings remain at this time unfit for human habitation, dilapidated, and a danger to the health and safety of the citizens of the City of Shelby, and should be removed by demolition in order to prevent and alleviate such continuing danger and dilapidated conditions.

NOW, THEREFORE, BE IT ORDAINED BY THE CITY COUNCIL OF THE CITY OF SHELBY, NORTH CAROLINA:

Section 1. The dwellings on the property known as **607 Sherrill Place** Shelby, and described in the Cleveland County records as Tax Parcel No. **17818** be demolished forthwith, the remnants thereof disposed, and a lien for the costs of such demolition and removal, less any credits due the owner(s), be filed against the property and collected pursuant to the provisions of North Carolina General Statutes § 160A-443, et seq.; and,

Section 2. Said lien bear interest until paid, as allowed in Article 10 of Chapter 160A of the N.C. General Statutes, at the rate of eight percent (8.0%) per annum.

Adopted and approved this 4th day of June 2018

O. Stanhope Anthony, III
Mayor

ATTEST:

Bernadette A. Parduski, NC-CMC, IIMC-MMC
City Clerk

APPROVED AS TO FORM:

Robert W. Yelton
City Attorney

City of Shelby
Agenda Item Summary
June 4, 2018
City Hall Council Chamber

Agenda Item: E

Unfinished Business

Agenda Item: E-1

- 7) Approval of a resolution of tentative award for the Runway Overlay Project at Shelby-Cleveland County Regional Airport to Harrison Construction Company, Division of APAC-Atlantic, Inc.: Resolution No. 28-2018

Consent Agenda Item: (Staff Resource, Ben Yarboro, Engineering Services Director)

Summary of Available Information:

- Memorandum dated May 30, 2018 from Ben Yarboro, Engineering Services Director to Rick Howell, City Manager
- Copy of Ordinance No. 18-2016
- Copy of Ordinance No. 30-2018
- Letter dated February 22, 2016 from NC Dept. of Transportation
- Letter dated March 29, 2018 from WK Dickson
- Bid Tabulation Sheet and Change Orders
- Resolution No. 28-2018

City Manager's Recommendation / Comments

Resolution No. 28-2018 is presented for City Council at this time. If approved this resolution would award a contract in the amount of \$2,468,006.75 to Harrison Construction Company, Division of APAC-Atlantic, Inc. for the construction of the Runway Overlay Project. Mr. Yarboro has provided a summary of the work in his memo dated May 30, 2018. This project has been approved by the NCDOT Division of Aviation for funding and has also received an award recommendation from the consulting engineering firm WK Dickson, Co. Inc. A 10% local match is required and the County has again agreed to split this match with the City. This amounts to \$126,036 for each entity.

It is my recommendation Resolution No. 28-2018 be adopted and approved by City Council at this time via the Consent Agenda.



Memorandum

To: Rick Howell, City Manager

From: Ben Yarboro, Engineering Services Director *BY*

RE: Shelby-Cleveland County Regional Airport
Runway Overlay Grant (36244.23.12.1)
Construction Contract Award Recommendation

Date: May 30, 2018

Background

The Shelby City Council accepted a grant from the NC Division of Aviation in 2016 for the design and construction of a runway overlay project at the Shelby-Cleveland County Regional Airport. The required 10% matches for the design and construction of this project were appropriated via ordinance numbers 18-2016 and 30-2018 (attached for reference). Following the acceptance of this grant, W.K. Dickson Co., Inc. completed the design and bidding of the runway overlay project in accordance with North Carolina Division of Aviation and FAA standards and specifications.

On March 8, 2018, W.K. Dickson completed a public bid opening for this project. Due to an insufficient number of bids at a previous bid opening, this was the second advertised opening for this project. At this bid opening, there was one responsive bid received from Harrison Construction Company, Division of APAC-Atlantic, Inc. in the amount of \$3,260,216.25. This bid amount exceeded the grant amount previously awarded by the NC Division of Aviation, so W.K. Dickson consulted with the NCDOA and the low bidder to discuss options that would allow the project to proceed. It was ultimately decided that the following adjustments would be made to the unit costs and overall scope of work:

- Unit cost reductions on the following were negotiated (\$90,275.00 reduction)
 - Crack Repair
 - Pavement Marking Removal
 - Embankment in Place
 - Temporary Construction Entrance
 - Bituminous Surface Course
 - Bituminous Tack Coat
 - Temporary Pavement Marking

www.cityofshelby.com

- Permanent Pavement Marking
- Seeding
- 24' Swing Gate
- Elimination of taxiway fillet widening (\$479,930.50 reduction)
- Reduction in perimeter fencing (\$222,004.00 reduction)

With the aforementioned negotiations and changes to the project scope, the construction bid from Harrison Construction Company totals \$2,468,006.75, which is within the budget of the state grant.

Recommendation

W.K. Dickson has reviewed the bid documents and qualifications of the bidder and recommends award of the construction contract for the Runway Overlay Project to Harrison Construction Company, Division of APAC-Atlantic, Inc. in the amount of \$2,468,006.75. City staff concurs with this recommendation and has prepared a resolution for the award of this construction contract for City Council consideration. If approved, this construction contract is anticipated to be completed by September 2018.

Please let me know if more information is required.

Attachments:

- Ordinance No. 18-2016
- Ordinance No. 30-2018
- NCDOA Notification of Phase Award
- Bid Tabulation and Recommendation from W.K. Dickson

ORDINANCE NO. 18-2016

AN ORDINANCE ESTABLISHING A CAPITAL PROJECT ORDINANCE AND BUDGET FOR THE CITY OF SHELBY'S AIRPORT GRANT 36244.23.12.1 RUNWAY OVERLAY PROJECT

WHEREAS, in accordance with applicable provisions of the North Carolina Budget and Fiscal Control Act the City of Shelby finds it advisable and necessary to establish a capital project ordinance and budget for the City of Shelby's Airport Grant 36244.23.12.1 Runway Overlay Project

WHEREAS, it is necessary for the City to establish a budget for this capital project and appropriate applicable funds needed for this project in order to comply with applicable provisions of the North Carolina Local Government Budget and Fiscal Control Act; and,

WHEREAS, G.S. 159-13.2 provides that a City may undertake projects such as the airport grant 36244.23.12.1 runway overlay by way of a capital project ordinance providing the necessary balance budget and funding for the life of the project;

NOW, THEREFORE, BE IT ORDAINED BY THE CITY COUNCIL OF THE CITY OF SHELBY, NORTH CAROLINA: The City of Shelby's Airport has received a runway overlay grant. The proceeds and disbursements of this grant are required to be appropriated.

Section 1. Appropriating General Fund Balance:

Fund Balance Appropriated	11001000-39900	\$ 9,000
Transfer to General Cap. Projects	110495-49111	\$ 9,000

Section 2. The following amounts are hereby appropriated for the Airport Grant Runway Overlay Project:

111453-53000-APRWO	Construction	\$180,000
--------------------	--------------	-----------

Section 3. It is estimated that the following revenues will be available for the Airport Grant Runway Overlay Project:

11105000-34501-APRWO	Grants	\$ 162,000
11105000-33500-APRWO	Transferred from County	9,000
11105000-39110-APRWO	Transferred from General Fund	9,000
		<u>\$ 180,000</u>

Section 4. The provisions of this capital project ordinance shall be entered in the minutes of the Shelby City Council and copies filed with the City Manager as Budget Officer, the Finance Director, and the City Clerk for their direction and guidance in receiving revenues and expending the monies due thereunder.

Section 5. This ordinance shall become effective upon its adoption and approval.

Adopted and approved this the 4th day of April 2016.

O. Stanhope Anthony III
Mayor

ATTEST:

Bernadette A. Parduski, NC-CMC, IIMC-MMC
City Clerk

APPROVED AS TO FORM:

Robert W. Yellon
City Attorney



ORDINANCE NO. 30-2018

A BUDGET ORDINANCE AMENDMENT FOR THE SHELBY-CLEVELAND COUNTY
REGIONAL AIRPORT RUNWAY OVERLAY PROJECT
AWARD ID 36244.23.12.1

WHEREAS, in accordance with applicable provisions of the North Carolina Budget and Fiscal Control Act, the City of Shelby finds it advisable and necessary to revise and amend its capital project ordinance and budgets for the City of Shelby's Airport Runway Overlay Project; and

WHEREAS, the City Manager (Budget Officer) has recommended certain amendments to the budget which the governing body finds acceptable; and,

WHEREAS, City Council now desires to act on the recommended budget amendments and approve the same for implementation and compliance with the North Carolina Local Government Budget and Fiscal Control Act;

NOW, THEREFORE, BE IT ORDAINED BY THE CITY COUNCIL OF THE CITY OF SHELBY, NORTH CAROLINA:

Section 1. Ordinance No. 18-2016, the City of Shelby's Airport Runway Overlay Project, is hereby amended as follows to provide for Budget Amendment No. 1 for said project:

Airport Runway Overlay Project

(1) Appropriating General Fund Revenues:

Fund Balance Appropriated	11001000-39900	\$ 126,036
Transfer to General Cap. Projects	110495-49111	\$ 126,036

(2) The following General Fund Cap. Project Revenues are amended by the City:

11105000-34501-APRWO	State Grants	\$2,268,644
11105000-33500-APRWO	Transferred from County	126,036
11005000-39110-APRWO	Transferred from General Fund	126,036

(3) The following General Fund Cap. Project Expenditures are amended by the City:

111453-53000-APRWO	Construction	\$2,520,716
--------------------	--------------	-------------

Section 2. That the revenues, expenditures and amendments set forth in Section 1 of this ordinance are hereby summarized as follows:

	<u>Current Budget</u>	<u>Amendment No. 1</u>
<u>Airport Runway Overlay Project</u>		
Revenues		
Transferred from County	\$ 9,000	\$ 135,036
State Grant	\$ 162,000	\$2,430,644
Transferred from General Fund	\$ 9,000	\$ 135,036
Expenditures		
Construction	\$ 180,000	\$2,700,716

Ordinance No. 30-2018
May 14, 2018
Page 2

Section 3. Copies of this Budget Ordinance Amendment shall be furnished to the City Manager as Budget Officer and to the Finance Director to be kept on file by them for their direction in the collection and disbursement of funds. Said officials are hereby authorized to receive and expend funds as herein set forth in accordance with the Shelby City Code, the General Statutes of North Carolina, and the provisions of the original budget ordinance; inclusive of GS 159-28 governing budgetary accounting of appropriations.

Section 4. This ordinance shall become effective upon its adoption and approval.

Adopted and approved this the 14th day of May 2018.

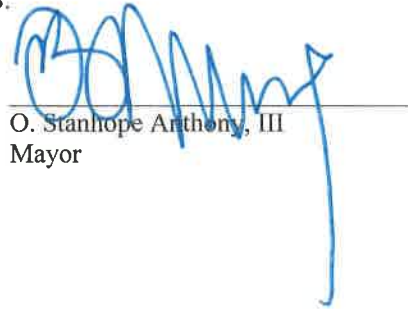

O. Stanhope Anthony, III
Mayor

ATTEST:



Bernadette A. Parduski, NC-CMC, IIMC-MMC
City Clerk

APPROVED AS TO FORM:

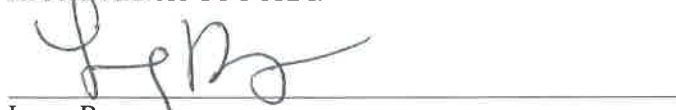

Lacey Beam
City Attorney



PAT McCrory
Governor

NICHOLAS J. TENNYSON
Secretary

February 22, 2016

Mr. Rick Howell, Manager
City of Shelby
P.O. Box 207
Shelby, NC 28151

RE: NOTIFICATION OF PHASED AWARD (DESIGN)

Dear Mr. Howell:

Congratulations. On behalf of Governor Pat McCrory, Transportation Secretary Nicholas Tennyson, and the NC Board of Transportation, this letter serves as official notification that State funds have been approved for Shelby-Cleveland County Regional Airport, Project Request No. 3120.

The Division of Aviation has programmed \$2,415,000 in total funds for State Fiscal Years (FY) 2016/17. This Notification of Award allocates \$162,000 of that amount toward the work phase described below. The remaining monies will be awarded for future phase(s). On your behalf, the Division has created Project Request No. 3498 that addresses this specific award.

The specific work elements and funding allocation is noted below:

Award ID	Description	State Funds	Local Funds
36244.23.12.1	Runway Overlay	\$162,000	\$18,000

At this juncture, the Division of Aviation requests that you submit pertinent start-up documentation within 60 days. Please visit the NCDOT Connect website listed below, and click on "Next Steps - Initial Instructions," which will walk you through the process from this letter until grant execution.

<https://connect.ncdot.gov/municipalities/State-Airport-Aid/Pages/default.aspx>

The NCDOT Division of Aviation requires effective airport planning and management for all projects, to ensure that funds are expended in a timely manner. This award will expire in four years; however, earlier delivery is expected in accordance with a detailed project schedule. Should an Airport encounter reasonable delays, then the Division of Aviation has the ability to assist by reprogramming your existing-year funds for a later year, and then divert the freed-up monies to another project that is ready to expend those funds.

The NCDOT-Division of Aviation appreciates your commitment and contribution to our state aviation system and we are excited to partner with you on this project.



Sincerely,



for Bobby L. Walston, P.E.
Director of Aviation

BLW/vh

cc: Governor Pat McCrory
Nicholas J. Tennyson, Secretary NCDOT
Keith Weatherly, Deputy Secretary for Transit
Richard Burr, United States Senate
Thom Tillis, United States Senate
Patrick McHenry, United States Congress
Lou Wetmore, BOT Representative
John D. Lennon, BOT At-Large Member
Jack Poole, Airport Supervisor



March 29, 2018

Mr. Ben Yarboro, Engineering Services Director
City of Shelby
830 College Ave, Highway 150
Shelby, NC 28152

**RE: Runway Overlay
Shelby-Cleveland County Regional Airport
WKD Project No. 20150149.00.CL
Bid Tabulation and Recommendation**

Dear Mr. Yarboro:

Enclosed is the Certified Bid Tabulation for the subject project. A summary of the received bid is listed below for the three schedules of work.

1. Harrison Construction Company, Division of APAC-Atlantic, Inc.

	<u>Bid Amounts</u>	<u>Recommended Award Amounts</u>
Schedule I – Runway Overlay	\$2,518,988.75	\$2,428,713.75
Schedule II – Taxiway Fillet Widening	\$479,930.50	
Schedule III – Perimeter Fencing	\$261,297.00	\$39,293.00
Total Bid	\$3,260,216.25	\$2,468,006.75

We have reviewed the bid and qualifications of the bidder. Harrison Construction Company is on the NCDOT preapproved list and has the proper licenses in the state of North Carolina.

This project has State funding at a ratio of 90% State -10% Local. Based on the information we have received at this time and the available funding, we recommend that the City of Shelby award the contract (Schedule I – 2" Runway Overlay and Schedule III – Perimeter Fencing) to Harrison Construction Company in accordance with revised pricing identified in the attached Change Order.

Mr. Ben Yarboro
March 29, 2018
Page 2

NOTE: A Notice To Proceed on this project construction is anticipated in May of 2018 and is subject to concurrence with a NTP from NCDOA.

We appreciate the opportunity to serve as the Project Engineer for the Shelby-Cleveland County Regional Airport on this project and we remain available to answer any questions you may have.

Sincerely,

W.K. Dickson & Co., Inc.



Greg Kershaw, PE
Technical Manager

Enclosures

BID TABULATION
Runway Overlay
City of Shelby
BID DATE: March 8, 2018
WKD Project No. 20150149.00.CL

Harrison Construction Company,
 Division of APAC-Atlantic, Inc.
 4817 Rutledge Pike
 Knoxville, TN 37914
 License No. 12459

ITEM NO.	SPEC SECT	DESCRIPTION	QTY	UNIT	UNIT PRICE	EXTENDED TOTAL
Schedule I - 2" Runway Overlay						
1.	GP-105	Mobilization	1	LS	875,000.00	875,000.00
2.	P-101	Crack Repair	35,000	LF	2.85	92,750.00
3.	P-101	Pavement Marking Removal	62,250	SF	1.25	77,812.50
4.	P-152	Embankment in Place (Off-Site Borrow)	600	CY	25.00	15,000.00
5.	P-158	Temporary Construction Entrance	2	EA	3,750.00	7,500.00
6.	P-158	Temporary Filter Sock	400	LF	12.00	4,800.00
7.	P-401	Bituminous Surface Course	8,750	TN	155.00	1,366,250.00
8.	P-603	Bituminous Tack Coat	6,100	GL	2.75	16,775.00
9.	P-820	Temporary Pavement Marking (Yellow)	1,425	SF	0.70	997.50
10.	P-820	Permanent ReflectORIZED Pavement Marking (Yellow)	1,425	SF	0.85	1,211.25
11.	P-820	Temporary Pavement Marking (White)	61,750	SF	0.40	24,700.00
12.	P-820	Permanent ReflectORIZED Pavement Marking (White)	61,750	SF	0.55	33,962.50
13.	T-901	Seeding (Mulched)	3	AC	3,000.00	9,000.00
14.	F-162	24' Swing Gate	1	EA	3,230.00	3,230.00
Schedule I - 2" Runway Overlay Subtotal						2,518,988.75
Schedule II - Taxiway Fillet Widening						
1.	GP-105	Mobilization	1	LS	185,000.00	185,000.00
2.	P-101	Crack Repair	10,000	LF	2.85	28,500.00
3.	P-152	Unclassified Excavation	100	CY	55.00	5,500.00
4.	P-152	Rock Excavation	50	CY	300.00	15,000.00
5.	P-152	Unsuitable Excavation	100	CY	25.00	2,500.00
6.	P-152	Geo Grid	350	SY	4.00	1,400.00
7.	P-156	Temporary Inlet Protection	4	EA	750.00	3,000.00
8.	P-156	Temporary Filter Sock	984	LF	13.60	13,014.00
9.	P-163	Remove Existing Pavement	237	SY	16.50	3,910.50
10.	P-209	Crushed Aggregate Base Course	200	CY	185.00	37,000.00
11.	P-401	Bituminous Surface Course	225	TN	320.00	72,000.00
12.	P-602	Bituminous Prime Coat	210	GL	6.00	1,260.00
13.	P-603	Bituminous Tack Coat	70	GL	2.50	175.00
14.	L-108	Trenching for Direct-Buried Cable	2,000	LF	2.75	5,500.00
15.	L-108	Trenching for Direct-Buried Counterpoise	600	LF	2.75	1,650.00
16.	L-108	No. 8 5kV L-824C Temporary Jumper Cable, Complete	100	LF	20.00	2,000.00
17.	L-108	No. 8 5kV L-824C Cable, Installed in Trench, Duct Bank or Conduit	4,000	LF	2.50	10,000.00
18.	L-108	No. 6 Bare Copper Counterpoise Wire, Installed in Trench, Duct Bank or Conduit, Including G	800	LF	2.71	1,628.00
19.	L-108	Supplementary Ground Rod (3/8" x 8") w/ 20 LF of #6 Bare Copper Connected to Initial Groun	34	EA	80.00	2,720.00
20.	L-108	Cable Splice to Existing Circuit	13	EA	250.00	3,250.00
21.	L-110	2-Way Concrete Encased Underground Duct Bank	50	LF	100.00	5,000.00
22.	L-125	Remove Existing Edge/Perimeter Light	23	EA	175.00	4,025.00
23.	L-125	Remove Existing Guidance Sign and Base	4	EA	725.00	2,900.00
24.	L-125	Reinstall Existing Taxiway Edge Light	22	EA	1,750.00	38,500.00
25.	L-125	Medium Intensity Taxiway Edge Light, Stake-Mounted (Quartz)	3	EA	1,250.00	10,000.00
26.	L-125	Taxiway Guidance Sign, Size 1, Style 2, Class 1 - 1 Module (LED)	4	EA	6,000.00	24,000.00
27.	T-901	Seeding (Mulched)	1	AC	2,500.00	2,500.00
SCHEDULE II - Taxiway Fillet Widening Subtotal						479,930.30
Schedule III - Perimeter Fencing						
1.	F-182	Remove Existing Fence	403	LF	5.00	2,015.00
2.	F-182	8' Chain Link Fence	8,914	LF	28.00	249,592.00
3.	F-182	24' Swing Gate	3	EA	3,230.00	9,690.00
SCHEDULE III - Perimeter Fencing Subtotal						261,297.00
TOTAL BID - (SCHEDULE I) + SCHEDULE II + SCHEDULE III)						3,260,216.25

I hereby certify that the above is a true and correct
 (to the best of my knowledge) tabulation of bids received on March 8, 2018.

 Greg Kershaw, PE
 W.K. Dickson & Co., Inc.



CHANGE ORDER NO. 1

Order No. One (1)
 Date March 28, 2018
 Agreement Date TBD

Name of Project:
 Runway Overlay
 Shelby-Cleveland County Regional Airport
 WKD #20150149.00.GL

Owner: City of Shelby

Contractor: Harrison Construction Company, A Division of APAC-Atlantic, Inc.

The following changes are hereby made to the Contract Documents :

Delete the following Items of work by the quantity and/or unit price shown:

<u>ITEM</u>	<u>DESCRIPTION</u>	<u>UNIT</u>	<u>QTY.</u>	<u>UNIT PRICE</u>	<u>TOTAL</u>
Schedule I - 2" Runway Overlay					
2	Crack Repair	LF	35000	\$2.85	\$92,750.00
3	Pavement Marking Removal	SF	62250	\$1.25	\$77,812.50
4	Embankment in Place (Off-Site Borrow)	CY	600	\$25.00	\$15,000.00
5	Temporary Construction Entrance	EA	2	\$3,750.00	\$7,500.00
7	Bituminous Surface Course	TN	8750	\$155.00	\$1,366,250.00
8	Bituminous Tack Coat	GL	6100	\$2.75	\$16,775.00
9	Temporary Pavement Marking (Yellow)	SF	1425	\$0.70	\$997.50
10	Permanent ReflectORIZED Pavement Marking (Yellow)	SF	1425	\$0.85	\$1,211.25
11	Temporary Pavement Marking (White)	SF	61750	\$0.40	\$24,700.00
12	Permanent ReflectORIZED Pavement Marking (White)	SF	61750	\$0.55	\$33,962.50
13	Seeding (Mulched)	AC	3	\$3,000.00	\$9,000.00
14	24' Swing Gate	EA	1	\$3,230.00	\$3,230.00
Subtotal DELETED Items					(\$1,639,188.75)

ADD the following items of work by the quantity and/or unit price shown:

<u>ITEM</u>	<u>DESCRIPTION</u>	<u>UNIT</u>	<u>QTY.</u>	<u>UNIT PRICE</u>	<u>TOTAL</u>
Schedule I - 2" Runway Overlay					
2	Crack Repair	LF	35000	\$2.40	\$84,000.00
3	Pavement Marking Removal	SF	62250	\$1.00	\$62,250.00
4	Embankment in Place (Off-Site Borrow)	CY	600	\$20.00	\$12,000.00
5	Temporary Construction Entrance	EA	2	\$3,400.00	\$6,800.00
7	Bituminous Surface Course	TN	8750	\$150.00	\$1,312,500.00
8	Bituminous Tack Coat	GL	6100	\$2.45	\$14,945.00
9	Temporary Pavement Marking (Yellow)	SF	1425	\$0.60	\$855.00
10	Permanent ReflectORIZED Pavement Marking (Yellow)	SF	1425	\$0.75	\$1,068.75
11	Temporary Pavement Marking (White)	SF	61750	\$0.32	\$19,760.00
12	Permanent ReflectORIZED Pavement Marking (White)	SF	61750	\$0.42	\$25,935.00
13	Seeding (Mulched)	AC	3	\$2,100.00	\$6,300.00
14	24' Swing Gate	EA	1	\$2,500.00	\$2,500.00
Subtotal ADDED Items					\$1,548,913.75
Net Change for Schedule I - 2" Runway Overlay					(\$90,275.00)

CHANGE ORDER NO. 1

Order No. One (1)
 Date March 28, 2018
 Agreement Date TBD

Name of Project:
 Runway Overlay
 Shelby-Cleveland County Regional Airport

Decrease the following items of work by the quantity and/or unit price shown:

<u>ITEM</u>	<u>DESCRIPTION</u>	<u>UNIT</u>	<u>QTY.</u>	<u>UNIT PRICE</u>	<u>TOTAL</u>
Schedule III - Perimeter Fencing					
2	8' Chain Link Fence	LF	7698	\$28.00	\$215,544.00
3	24' Swing Gate	EA	2	\$3,230.00	\$6,460.00
Subtotal DECREASED Items					<u>(\$222,004.00)</u>
TOTAL CONTRACT PRICE ADJUSTMENT (DECREASE) Schedule I and Schedule III					<u>(\$312,279.00)</u>

JUSTIFICATION: The initial contract prices received exceeded the available funding, negotiations with the Contractor were conducted. Revised pricing as indicated resulted in project costs aligning with available funding.

CHANGE TO TOTAL CONTRACT PRICE

Original Contract Price (Schedule I - 2" Runway Overlay & Schedule III - Perimeter Fencing)	<u>\$2,780,285.75</u>
The Contract Price Due to Previous Change Order	<u>\$2,780,285.75</u>
The Contract Price Due to This Change Order Will Be	<u>\$2,468,006.75</u>

CHANGE TO CONTRACT TIME:
 No Change to Contract Time

Requested by: City of Shelby

By: _____ Chairman _____ Date _____
 Title

Recommended by: W.K. Dickson & Co., Inc.

By: _____ Title _____ Date _____

Accepted by: Harrison Construction Company, A Division of APAC-Atlantic, Inc.

By: _____ Title _____ Date _____

RESOLUTION NO. 28-2018

A RESOLUTION OF TENTATIVE AWARD FOR THE RUNWAY OVERLAY PROJECT AT THE SHELBY-CLEVELAND COUNTY REGIONAL AIRPORT TO HARRISON CONSTRUCTION COMPANY, DIVISION OF APAC-ATLANTIC, INC.

WHEREAS, the City of Shelby in accordance with North Carolina General Statutes related to the bidding of public construction contracts has solicited bids for qualified contractors to perform work related to construction of the Runway Overlay Project at the Shelby-Cleveland County Regional Airport; and

WHEREAS, a project budget ordinance was established for the design of the Runway Overlay Project via Ordinance 18-2016 and a project budget ordinance was established for construction via Ordinance 30-2018; and

WHEREAS, City staff in conjunction with W.K. Dickson & Co., Inc. held a public bid opening to accept bids from qualified contractors to perform construction for the above mentioned project; and

WHEREAS, one (1) bids was received after re-advertising for qualified contractors and the apparent low bidder is Harrison Construction Company, Division of APAC-Atlantic, Inc. in the amount of \$2,468,006.75; and

WHEREAS, W.K. Dickson & Co., Inc. has reviewed the bid in conjunction with City staff and City staff now recommends to the City Manager and City Council that the contract be awarded to the low bidder, Harrison Construction Company, Division of APAC-Atlantic, Inc. in the amount of \$2,468,006.75.

NOW, THEREFORE, BE IT RESOLVED BY THE CITY COUNCIL OF THE CITY OF SHELBY, NORTH CAROLINA:

Section 1. The City Council of the City of Shelby hereby awards the contract to Harrison Construction Company, Division of APAC-Atlantic, Inc. for construction of the Runway Overlay Project at the Shelby-Cleveland County Regional Airport.

Section 2. The City Manager and City Clerk are hereby authorized and directed to execute the applicable contract associated with this project.

Section 3. The City Manager or his designee is hereby authorized to execute change orders, amendments, and other documents associated with this project.

Section 4. This resolution shall become effective upon its adoption and approval.

Adopted and approved this the 4th day of June 2018.

O. Stanhope Anthony, III
Mayor

ATTEST:

Bernadette A. Parduski, NC-CMC, IIMC-MMC
City Clerk

City of Shelby
Agenda Item Summary
June 4, 2018
City Hall Council Chamber

Agenda Item: F

New Business

None

Agenda Item: G

City Manager's Report

- 1) Shell Building #3
- 2) Uptown Water/Sewer Project
- 3) Clearwater Infrastructure Projects

Agenda Item: H

Council Announcements and Remarks

I. Adjournment:

To adjourn a meeting of City Council, a majority of the Council members must vote for a motion to adjourn.

- 1) Motion to adjourn